

1-5-2371

IMPROVEMENT PERMIT

Be it ordained by the Harnett County Board of Health as follows: Section III, Item B. "No Person shall begin construction of any building at which a septic tank system is to be used for disposal of sewage without first obtaining a written permit from the Harnett County Health Department."

Name: (owner) Moss Homebuilders New Installation Septic Tank

Property Location: SR# 1443 Lafayette Rd Repairs Nitrification Line

Subdivision Victoria Hills II Lot # 220

Tax ID # _____ Quadrant # _____

Number of Bedrooms Proposed: 3 Lot Size: 1Ac.

Basement with Plumbing: Garage:

Water Supply: Well Public Community

Distance From Well: 50 m. ft.

Following is the minimum specifications for sewage disposal system on above captioned property. Subject to final approval.

Type of system: Conventional Other _____

Size of tank: Septic Tank: 1000 gallons Pump Tank: _____ gallons

Subsurface Drainage Field No. of 3 exact length 135 width of 3 depth of 18-24 in.
ditches _____ of each ditch _____ ft. ditches _____ ft. ditches _____ in.

French Drain Required: _____ Linear feet

Date: 9/5/2001

Signed: Roger M. Lewis R.S.
Environmental Health Specialist

This permit is subject to revocation if site plans or intended use change.

- * Maintain all setbacks
- * Run ditches on contour

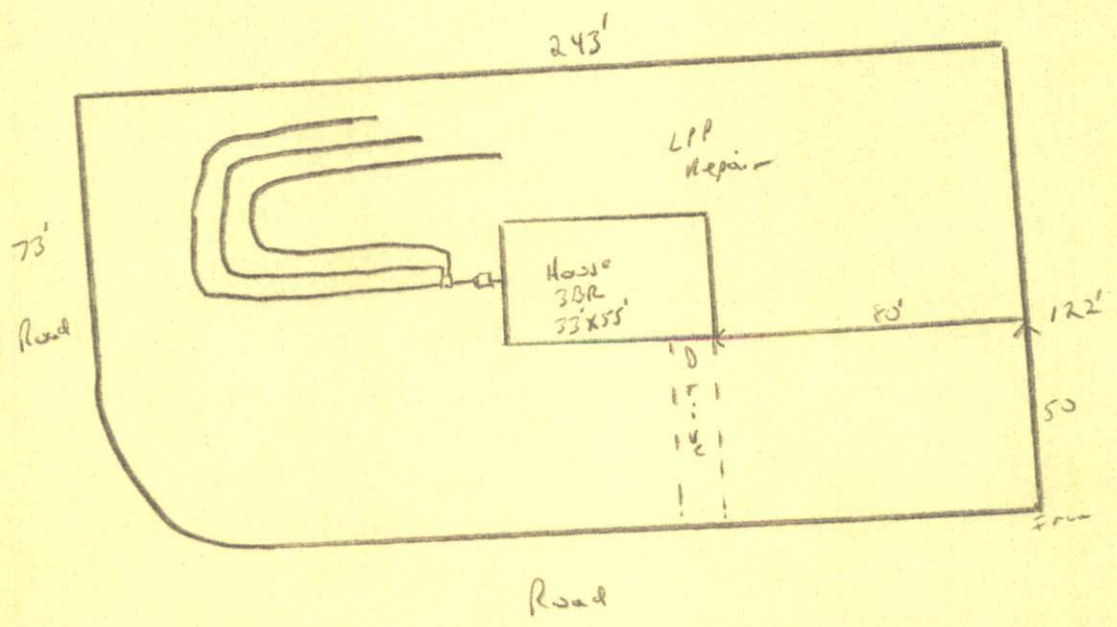

HARNETT COUNTY HEALTH DEPARTMENT
AUTHORIZATION TO CONSTRUCT

Authorization is hereby given to construct a wastewater system to the specifications described by Harnett County Health Department Improvement Permit # 18025. This authorization shall be valid for a period not to exceed five (5) years from the date of issuance. This authorization will be invalid if ownership, site plans, or intended use change.

Owner or Authorized Agent _____

Name: Mass Homebuilders Telephone # 843-4875

Address: P.O. Box 577 Lillington, N.C. 27548

Property Location: SR# 1443 Road Name Lafayette

New Installation Repair Septic Tank Nitrification Lines

Subdivision Victoria Hills II Lot # 220

Number of Bedrooms Proposed: 3 Lot size: 1Ac

Basement With Plumbing Without Plumbing

Water Supply: Well Public Minimum Well Setback: 50 ft.

Type of System: Conventional Other

Tank Volume: Septic Tank 1000 gallons Pump Chamber _____ gallons

Nitrification Field Specifications

Number of fields 1 Number of Lines per Field 3 Length of lines 135ft

Width of ditches 3 ft. Depth of ditches 18-24 inches

French Drain: Linear feet required _____ Depth of gravel _____

No wastewater system shall be covered or placed into use by any person until an inspection by the Harnett County Health Department has determined that the system has been installed according to the conditions of the improvement permit and that a valid operations permit has been issued.

Authorized Agent for Harnett County Health Department

Name: Diana M. Lewis R.S. Date: 9/5/2001