

Initial Application Date: 03-16-01

Application #00- 01-5-1525

CITY OF HARNETT LAND USE APPLICATION

Planning Department 102 E. Front Street, Lillington, NC 27546

Phone: (910) 893-7525 Fax: (910) 893-2793

LANDOWNER: RUFUS R. ANDERSON  
ANDERSON ENTERPRISES Address: 2024 BAPTIST GROVE RD  
City: FUQUAY-VARINA State: N.C. Zip: 27526 Phone #: 552-8786

APPLICANT: LAMBERT HOMES, INC. Address: 2150 BAPTIST GROVE RD  
City: FUQUAY-VARINA State: N.C. Zip: 27526 Phone #: (919) 557-3686

PROPERTY LOCATION: SR #: 1443 SR Name: LAFAYETTE RD.

Parcel: 08-0653-0105-80 PIN: 0663-04-4726.000

Zoning: A-30 Subdivision: VICTORIA HILLS II Lot #: 234 Lot Size: 32,602

Flood Plain: X Panel: 0050 Watershed: IV Deed Book/Page: 1386 Plat Book/Page: 247

2000/507

DIRECTIONS TO THE PROPERTY FROM LILLINGTON: TAKE 401 N. TOWARDS FUQUAY. TAKE A RIGHT ON LAFAYETTE RD. GO ABOUT 1.5 MILES SUBDIVISION ON RIGHT. LOT LOCATED ON BLAIRWOOD DR.

PROPOSED USE:

Sg. Family Dwelling (Size 62 x 47) # of Bedrooms 3 Basement      Garage 22x22 Deck 10x12

Multi-Family Dwelling No. Units      No. Bedrooms/Unit     

Manufactured Home (Size     x    ) # of Bedrooms      Garage      Deck     

Comments:     

Number of persons per household     

Business Sq. Ft. Retail Space      Type     

Industry Sq. Ft.      Type     

Home Occupation (Size     x    ) # Rooms      Use     

Accessory Building (Size     x    ) Use     

Addition to Existing Building (Size     x    ) Use     

Other     

Water Supply:  County  Well (No. dwellings     )  Other

Sewer:  Septic Tank/ Existing: YES NO  County  Other

Erosion & Sedimentation Control Plan Required? YES NO

Structures on this tract of land: Single family dwellings      Manufactured homes      Other (specify)     

Property owner of this tract of land own land that contains a manufactured home w/in five hundred feet (500') of tract listed above? YES NO

Required Property Line Setbacks:	Minimum	Actual	Minimum	Actual
Front	<u>35'</u>	<u>40</u>	Rear	<u>25'</u>
Side	<u>10'</u>	<u>35</u>	Corner	<u>20'</u>
Nearest Building	<u>10</u>	<u>    </u>		<u>    </u>

If permits are granted I agree to conform to all ordinances and the laws of the State of North Carolina regulating such work and the specifications or plans submitted. I hereby swear that the foregoing statements are accurate and correct to the best of my knowledge.

[Signature]  
Signature of Applicant

3-16-01  
Date

*2 Baths*

# Lambert Home, Inc.

Lot # 234 Subdivision: VICTORIA HILLS II  
 Address: 60 BLAIRWOOD DR. FURQUAY-VARINA, N.C. 27526  
 Recorded - Book: 1386 Page: 247 Tax Map: 0663-04-4726.000  
 Zoning: R-30 Lot Size: 32,602 sq.ft. Scale: 1" = 120'

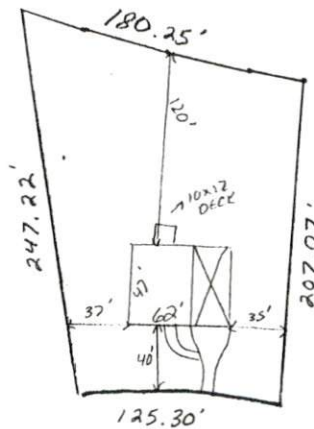

## SITE PLAN APPROVAL

DISTRICT RA-30 USE SFD

#BEDROOMS 3

Date 3-16-01

Therese Jones  
Zoning Administrator

## Required Property Line Setbacks

	Minimum	Actual
Front	<u>35</u>	<u>40</u>
Side	<u>10</u>	<u>35</u>
Corner	<u>20</u>	<u>—</u>
Rear	<u>25</u>	<u>120</u>
Nearest Building	<u>10</u>	<u>—</u>

30°48'23"W	C34	472.53'	120.77'	120.44'	N 51°05'58"E	L12	N 80°20'35"E	55.03'	L33	N 37°29'40"E	17.51'
23°34'11"W	C35	472.53'	100.21'	100.02'	N 37°42'08"E	L13	N 77°05'05"E	53.23'	L34	N 35°23'37"E	51.55'
26°25'41"W	C36	472.53'	34.58'	34.57'	N 25°18'19"E	L14	N 74°26'39"E	39.42'	L35	N 34°05'52"E	51.52'
36°31'43"W	C37	472.08'	3.11'	3.11'	N 23°23'52"E	L15	N 74°26'39"E	14.01'	L36	N 33°01'08"E	27.38'
55°42'29"W	C38	472.08'	100.75'	100.56'	N 29°42'02"E	L16	N 72°11'30"E	52.49'	L37	N 33°01'08"E	24.72'
74°47'45"W	C39	472.08'	162.83'	162.03'	N 45°41'46"E	L17	N 69°21'11"E	34.20'	L38	N 32°38'24"E	51.87'
74°19'11"W	C40	25.00'	42.07'	37.28'	S 76°12'42"E	L18	N 69°21'11"E	19.94'	L39	N 32°38'24"E	62.88'
89°29'58"W	C41	575.98'	84.09'	84.01'	S 32°11'00"E	L19	N 66°23'18"E	54.87'	L40	N 32°38'24"E	20.60'
19°23'43"W	C/L C1	648.95'	302.52'	299.79'	S 41°21'21"E	L20	N 63°04'10"E	25.28'	L41	N 33°00'51"E	39.11'
	C/L C2	550.98'	80.44'	80.37'	S 32°11'00"E	L21	N 63°04'10"E	30.00'	L42	S 81°35'08"W	1.60'
	C/L C3	497.08'	336.53'	330.14'	S 42°36'14"W						
	C/L C4	447.53'	318.93'	312.22'	S 43°37'27"W						
	C/L C5	447.53'	137.05'	136.52'	S 72°48'45"W						
	C/L C6	828.75'	301.23'	299.57'	S 15°32'52"E						

