

IMPROVEMENT PERMIT

01-5-1257 Revision

Be it ordained by the Harnett County Board of Health as follows: Section III, Item B. "No Person shall begin construction of any building at which a septic tank system is to be used for disposal of sewage without first obtaining a written permit from the Harnett County Health Department."

Name: (owner) Regency Homes New Installation Septic Tank
 Property Location: SR# 1115 Repairs Nitrification Line

Subdivision Peachtree Lot # 14

Tax ID # _____ Quadrant # _____

Number of Bedrooms Proposed: 3 (39x50) Lot Size: 22,412 S/F

Basement with Plumbing: Garage:

Water Supply: Well Public Community

Distance From Well: 50 ft.

Following is the minimum specifications for sewage disposal system on above captioned property. Subject to final approval.

Type of system: Conventional Other _____

Size of tank: Septic Tank: 1000 gallons Pump Tank: _____ gallons

Subsurface Drainage Field No. of ditches 1 exact length 240 ft. width of 3 ft. depth of 18-24 in. of each ditch _____ ft. ditches _____ ft. ditches _____ in.

French Drain Required: _____ Linear feet

Date: 3-15-02

This permit is subject to revocation if site plans or intended use change.

Signed: [Signature]
 Environmental Health Specialist

STUB out Plumbing
 Shallow where shown
 or pump will be required
 Do not DRIVE OR PARK ON SEPTIC
 System

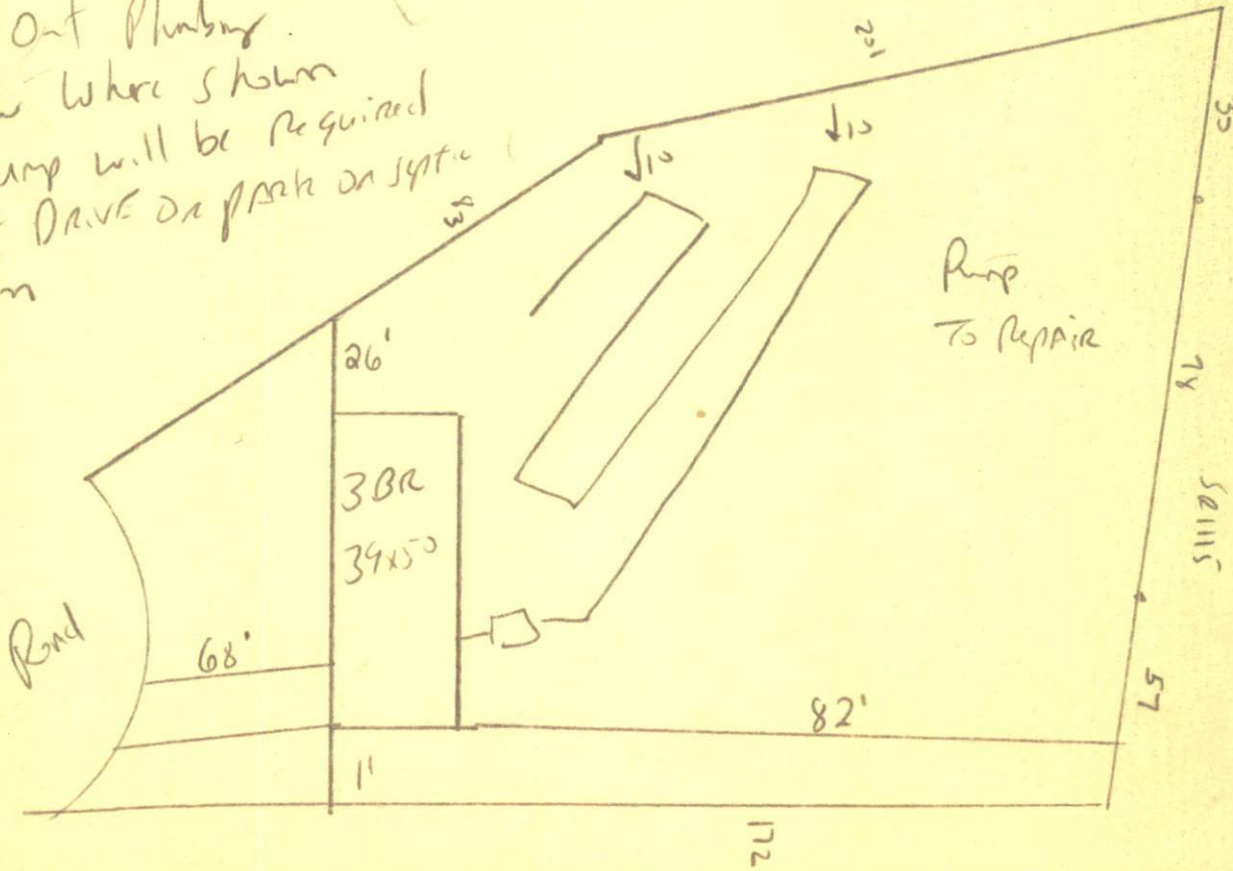

HARNETT COUNTY HEALTH DEPARTMENT
AUTHORIZATION TO CONSTRUCT

Authorization is hereby given to construct a wastewater system to the specifications described by Harnett County Health Department, Improvement Permit # 18746. This authorization shall be valid for a period not to exceed five (5) years from the date of issuance. This authorization will be invalid if ownership, site plans, or intended use change.

Name Regency Homes Telephone # 424-0455

Address _____

Property Location SR# 1115 Road Name _____

Subdivision Peach Tree Lot # 14 # Bedrooms Proposed 3 (39x50) Lot size 22,412 s/r

TYPE OF SYSTEM

New Installation Repair Septic Tank Nitrification Lines

Conventional Other _____

Basement With Plumbing Without Plumbing

Water Supply: Well Public - Minimum Well Setback: _____ Ft.

NITRIFICATION FIELD SPECIFICATIONS

Number of fields 1 # of lines per field 1 Length of lines 240 Ft.

Width of ditches 3 ft. Depth of ditches 18-24 inches

French Drain: Linear feet required _____ Depth of gravel _____

No wastewater system shall be covered or placed into use by any person until an inspection by the Harnett County Health Department has determined that the system has been installed according to the conditions of the Improvement Permit and that a valid Operations Permit has been issued.

Signature of Authorized Agent for Harnett County [Signature] Date 3-15-02