

01-5000977

# IMPROVEMENT PERMIT

Be it ordained by the Harnett County Board of Health as follows: Section III, Item B. "No Person shall begin construction of any building at which a septic tank system is to be used for disposal of sewage without first obtaining a written permit from the Harnett County Health Department."

Name: (owner) Shaw Court  New Installation  Septic Tank  
Property Location: SR# Hwy 210  Repairs  Nitrification Line

Subdivision Elizabeth Gardens Lot # 10

Tax ID # \_\_\_\_\_ Quadrant # \_\_\_\_\_

Number of Bedrooms Proposed: Three Lot Size: \_\_\_\_\_

Basement with Plumbing:  Garage:

Water Supply:  Well  Public  Community

Distance From Well: 50 ft.

Following is the minimum specifications for sewage disposal system on above captioned property. Subject to final approval.

Type of system:  Conventional  Other \_\_\_\_\_

Size of tank: Septic Tank: 1000 gallons Pump Tank: \_\_\_\_\_ gallons

Subsurface No. of exact length width of depth of  
Drainage Field ditches 1 of each ditch 300 ft. ditches 3 ft. ditches 18-24 in.

French Drain Required: \_\_\_\_\_ Linear feet

Date: 18 Jan 2001  
Signed: Vernon R. Dodge, R.S.  
Environmental Health Specialist

This permit is subject to revocation if site plans or intended use change.

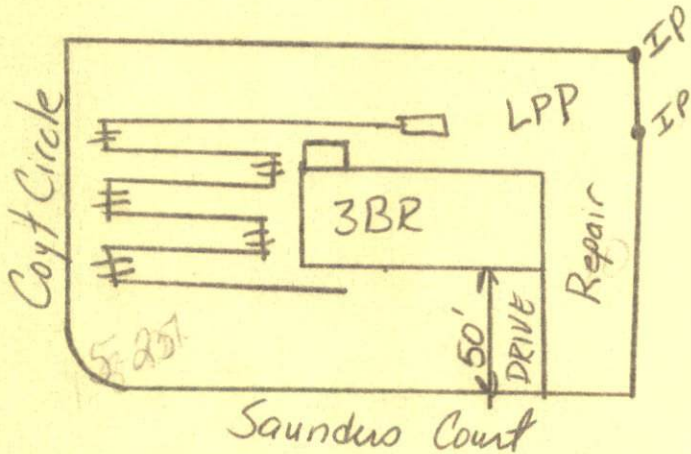

Stub plumbing shallow to allow fall on pump required.



HARNETT COUNTY HEALTH DEPARTMENT  
AUTHORIZATION TO CONSTRUCT

Authorization is hereby given to construct a wastewater system to the specifications described by Harnett County Health Department Improvement Permit # 16834. This authorization shall be valid for a period not to exceed five (5) years from the date of issuance. This authorization will be invalid if ownership, site plans, or intended use change.

Owner or Authorized Agent \_\_\_\_\_

Name: Shaw Construction Telephone # 893-4322

Address: 1248 Bill Shaw Rd. Spring Lake, NC

Property Location: SR # Hwy 210 Road Name Hwy 210

New Installation  Repair  Septic Tank  Nitrification Lines

Subdivision Elizabeth Gardens Lot # 10

Number of Bedrooms Proposed: Three Lot size: \_\_\_\_\_

Basement  With Plumbing  Without Plumbing

Water Supply: Well  Public  Minimum Well Setback: 50 ft.

Type of System: Conventional  Other

Tank Volume: Septic Tank 1000 gallons Pump Chamber \_\_\_\_\_ gallons

Nitrification Field Specifications

Number of fields 1 Number of Lines per Field 1 Length of lines 300 feet

Width of ditches 3 ft. Depth of ditches 18-24 inches

French Drain: Linear feet required \_\_\_\_\_ Depth of gravel \_\_\_\_\_

No wastewater system shall be covered or placed into use by any person until an inspection by the Harnett County Health Department has determined that the system has been installed according to the conditions of the improvement permit and that a valid operations permit has been issued.

Authorized Agent for Harnett County Health Department

Name: Vernon R. Wood, P.E. Date: 18 Jan 2001