

#00-50000972

# HARNETT COUNTY HEALTH DEPARTMENT

No 16866

## IMPROVEMENT PERMIT

Be it ordained by the Harnett County Board of Health as follows: Section III, Item B. "No Person shall begin construction of any building at which a septic tank system is to be used for disposal of sewage without first obtaining a written permit from the Harnett County Health Department."

Name: (owner) J Percy Whitherton

New Installation

Septic Tank

Property Location: SR# 421

Repairs

Nitrification Line

Subdivision Myrtlewood Lot # 24

Tax ID # \_\_\_\_\_ Quadrant # \_\_\_\_\_

Number of Bedrooms Proposed: 3 Lot Size: .72

Basement with Plumbing:  Garage:

Water Supply:  Well  Public  Community

Distance From Well: 50' ft.

Following is the minimum specifications for sewage disposal system on above captioned property. Subject to final approval.

Type of system:  Conventional  Other \_\_\_\_\_

Size of tank: Septic Tank: 1000 gallons Pump Tank: \_\_\_\_\_ gallons

Subsurface Drainage Field No. of ditches 3 exact length of each ditch 133 ft. width of ditches 3 ft. depth of ditches 18-20 in.

French Drain Required: - Linear feet

Date: 1-11-01

**This permit is subject to revocation if site plans or intended use change.**

Signed: James E. Markhart III  
Environmental Health Specialist

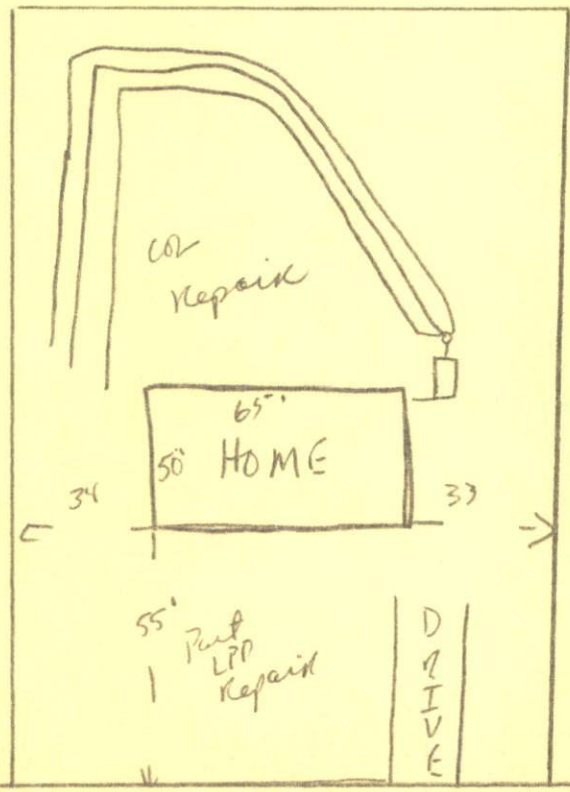

\* Maintain all setbacks!

Timber Creek LANE

# HARNETT COUNTY HEALTH DEPARTMENT AUTHORIZATION TO CONSTRUCT

Authorization is hereby given to construct a wastewater system to the specifications described by Harnett County Health Department Improvement Permit # 16866. This authorization shall be valid for a period not to exceed five (5) years from the date of issuance. This authorization will be invalid if ownership, site plans, or intended use change.

Owner or Authorized Agent Whittector Builders

Name: J. Percy Whittector SR Telephone # 919-894-5591

Address: 1055 TELGHMAN RD DUNN N.C. 28334

Property Location: SR # 421 Road Name 421

New Installation  Repair  Septic Tank  Nitrification Lines

Subdivision Myrtlewood Lot # 24

Number of Bedrooms Proposed: 3 Lot size: .72

Basement  With Plumbing  Without Plumbing

Water Supply: Well  Public  Minimum Well Setback:          ft.

Type of System: Conventional  Other

Tank Volume: Septic Tank 1000 gallons Pump Chamber          gallons

### Nitrification Field Specifications

Number of fields 2 Number of Lines per Field 3 Length of lines 133

Width of ditches 3 ft. Depth of ditches 18-20 inches

French Drain: Linear feet required          Depth of gravel         

No wastewater system shall be covered or placed into use by any person until an inspection by the Harnett County Health Department has determined that the system has been installed according to the conditions of the improvement permit and that a valid operations permit has been issued.

Authorized Agent for Harnett County Health Department

Name: James E. Marshall Date: 1-11-01