

Initial Application Date: 6-24-15

Application # 1550036509
DRB # _____ CU # _____

COMMERCIAL

COUNTY OF HARNETT LAND USE APPLICATION

Central Permitting 108 E. Front Street, Lillington, NC 27546 Phone: (910) 893-7525 Fax: (910) 893-2793

SCANNED
www.harnett.org/permits

LANDOWNER: Allison Daniel Mailing Address: 372 Stoney Creek Dr. DATE _____

City: Sanford State: NC Zip: 27332 Contact # (903)812-2510 Email: _____

APPLICANT*: _____ Mailing Address: _____

City: _____ State: _____ Zip: _____ Contact # _____ Email: _____

*Please fill out applicant information if different than landowner

CONTACT NAME APPLYING IN OFFICE: _____ Phone # _____

PROPERTY LOCATION: Subdivision: _____ Lot #: 5 Lot Size: 6.58

State Road # 84 State Road Name: Tingen Rd Map Book&Page: 002, 0021

Parcel: 9597-06-6530 PIN: 039597 0052

Zoning: RA-20R Flood Zone: N/A Watershed: N/A Deed Book&Page: 2044 1821 Power Company*: _____

*New structures with Progress Energy as service provider need to supply premise number _____ from Progress Energy.

SPECIFIC DIRECTIONS TO THE PROPERTY FROM LILLINGTON: _____

PROPOSED USE:

- Multi-Family Dwelling No. Units: _____ No. Bedrooms/Unit: _____
- Business Sq. Ft. Retail Space: 5,000 Type: SCHOOL # Employees: 10 Hours of Operation: 8-4
- Daycare # Preschoolers: _____ # Afterschoolers: _____ # Employees: _____ Hours of Operation: _____
- Industry Sq. Ft: _____ Type: _____ # Employees: _____ Hours of Operation: _____
- Church Seating Capacity: _____ # Bathrooms: _____ Kitchen: _____
- Accessory/Addition/Other (Size _____ x _____) Use: _____

Water Supply: County _____ Existing Well _____ New Well (# of dwellings using well _____) *MUST have operable water before final
Sewage Supply: New Septic Tank (Complete Checklist) _____ Existing Septic Tank (Complete Checklist) _____ County Sewer

Comments: Montessori Independence School

If permits are granted I agree to conform to all ordinances and laws of the State of North Carolina regulating such work and the specifications of plans submitted. I hereby state that foregoing statements are accurate and correct to the best of my knowledge. Permit subject to revocation if false information is provided.

Kirby Pledge _____ 6/24/15
Signature of Owner or Owner's Agent Date

****This application expires 6 months from the initial date if permits have not been issued****

A RECORDED SURVEY MAP, RECORDED DEED (OR OFFER TO PURCHASE) AND PLAT ARE REQUIRED WHEN APPLYING FOR LAND USE APPLICATION

NAME: Allison Daniel

APPLICATION #: 15-50036509

This application to be filled out when applying for a septic system inspection.

County Health Department Application for Improvement Permit and/or Authorization to Construct

IF THE INFORMATION IN THIS APPLICATION IS FALSIFIED, CHANGED, OR THE SITE IS ALTERED, THEN THE IMPROVEMENT PERMIT OR AUTHORIZATION TO CONSTRUCT SHALL BECOME INVALID. The permit is valid for either 60 months or without expiration depending upon documentation submitted. (Complete site plan = 60 months; Complete plat = without expiration)

910-893-7525 option 1

CONFIRMATION # _____

Environmental Health New Septic System Code 800

- **All property irons must be made visible.** Place "pink property flags" on each corner iron of lot. All property lines must be clearly flagged approximately every 50 feet between corners.
- Place "orange house corner flags" at each corner of the proposed structure. Also flag driveways, garages, decks, out buildings, swimming pools, etc. Place flags per site plan developed at/for Central Permitting.
- Place orange Environmental Health card in location that is easily viewed from road to assist in locating property.
- If property is thickly wooded, Environmental Health requires that you clean out the **undergrowth** to allow the soil evaluation to be performed. Inspectors should be able to walk freely around site. **Do not grade property.**
- **All lots to be addressed within 10 business days after confirmation. \$25.00 return trip fee may be incurred for failure to uncover outlet lid, mark house corners and property lines, etc. once lot confirmed ready.**
- After preparing proposed site call the voice permitting system at 910-893-7525 option 1 to schedule and use code 800 (after selecting notification permit if multiple permits exist) for Environmental Health inspection. Please note confirmation number given at end of recording for proof of request.
- Use Click2Gov or IVR to verify results. Once approved, proceed to Central Permitting for permits.

Environmental Health Existing Tank Inspections Code 800

- Follow above instructions for placing flags and card on property.
- Prepare for inspection by removing soil over **outlet end** of tank as diagram indicates, and lift lid straight up (*if possible*) and then **put lid back in place.** (Unless inspection is for a septic tank in a mobile home park)
- **DO NOT LEAVE LIDS OFF OF SEPTIC TANK**
- After uncovering **outlet end** call the voice permitting system at 910-893-7525 option 1 & select notification permit if multiple permits, then use code 800 for Environmental Health inspection. Please note confirmation number given at end of recording for proof of request.
- Use Click2Gov or IVR to hear results. Once approved, proceed to Central Permitting for remaining permits.

SEPTIC

If applying for authorization to construct please indicate desired system type(s): can be ranked in order of preference, must choose one.

Accepted Innovative Conventional Any
 Alternative Other _____

The applicant shall notify the local health department upon submittal of this application if any of the following apply to the property in question. If the answer is "yes", applicant **MUST ATTACH SUPPORTING DOCUMENTATION**:

- YES NO Does the site contain any Jurisdictional Wetlands?
- YES NO Do you plan to have an irrigation system now or in the future?
- YES NO Does or will the building contain any drains? Please explain. _____
- YES NO Are there any existing wells, springs, waterlines or Wastewater Systems on this property?
- YES NO Is any wastewater going to be generated on the site other than domestic sewage?
- YES NO Is the site subject to approval by any other Public Agency?
- YES NO Are there any Easements or Right of Ways on this property?
- YES NO Does the site contain any existing water, cable, phone or underground electric lines?

If yes please call No Cuts at 800-632-4949 to locate the lines. This is a free service.

I Have Read This Application And Certify That The Information Provided Herein Is True, Complete And Correct. Authorized County And State Officials Are Granted Right Of Entry To Conduct Necessary Inspections To Determine Compliance With Applicable Laws And Rules.

I Understand That I Am Solely Responsible For The Proper Identification And Labeling Of All Property Lines And Corners And Making The Site Accessible So That A Complete Site Evaluation Can Be Performed.

Allison Daniel
PROPERTY OWNERS OR OWNERS LEGAL REPRESENTATIVE SIGNATURE (REQUIRED)

7/20/15
DATE



Draper Aden Associates
 Engineers • Surveyors • Environmental Scientists
 10000 W. HARRIS BLVD., SUITE 100
 RICHMOND, VA 23234
 (804) 771-1100
 FAX (804) 771-1101
 draperaden.com

INDEPENDENCE MONTROSSI SCHOOL
 BROADWAY, NC
 SITE LAYOUT PLAN

REVISIONS

NO.	DATE	DESCRIPTION
1	08/27/15	ISSUED FOR PERMIT

PROJECT NO. R15328N-01G
 SHEET NO. C1.0

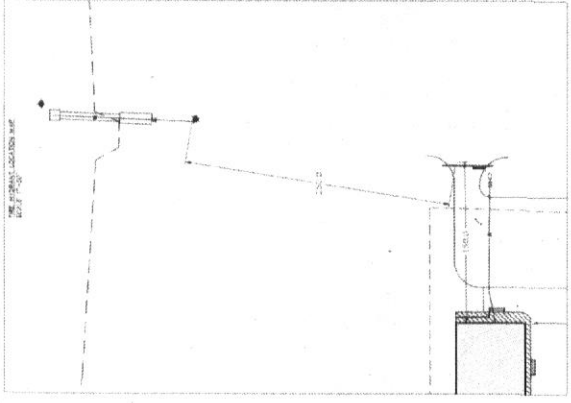

PROJECT INFORMATION
 PROJECT NAME: INDEPENDENCE MONTROSSI SCHOOL
 OWNER: BROADWAY, NC
 DESIGNER: DRAPER ADEN ASSOCIATES
 DATE: 08/27/15

REG. REFERENCE
 STATE OF NORTH CAROLINA
 PROFESSIONAL ENGINEER
 LICENSE NO. 10000
 DRAPER ADEN ASSOCIATES
 10000 W. HARRIS BLVD., SUITE 100
 RICHMOND, VA 23234

SITE NOTES

1. ALL BUILDINGS SHALL BE CONSTRUCTED TO THE EXTERIOR FINISH LINE UNLESS OTHERWISE NOTED.
2. PROPERTY MARKERS ARE TO BE PLACED AT THE CORNERS OF THE LOT AND AT THE INTERSECTION OF THE LOT LINES WITH THE ADJACENT LOT LINES.
3. ALL DIMENSIONS ARE TO FACE UNLESS OTHERWISE NOTED.
4. ALL DIMENSIONS ARE TO FACE UNLESS OTHERWISE NOTED.
5. ALL DIMENSIONS ARE TO FACE UNLESS OTHERWISE NOTED.
6. ALL DIMENSIONS ARE TO FACE UNLESS OTHERWISE NOTED.
7. ALL DIMENSIONS ARE TO FACE UNLESS OTHERWISE NOTED.
8. ALL DIMENSIONS ARE TO FACE UNLESS OTHERWISE NOTED.
9. ALL DIMENSIONS ARE TO FACE UNLESS OTHERWISE NOTED.
10. ALL DIMENSIONS ARE TO FACE UNLESS OTHERWISE NOTED.
11. ALL DIMENSIONS ARE TO FACE UNLESS OTHERWISE NOTED.
12. ALL DIMENSIONS ARE TO FACE UNLESS OTHERWISE NOTED.
13. ALL DIMENSIONS ARE TO FACE UNLESS OTHERWISE NOTED.
14. ALL DIMENSIONS ARE TO FACE UNLESS OTHERWISE NOTED.
15. ALL DIMENSIONS ARE TO FACE UNLESS OTHERWISE NOTED.

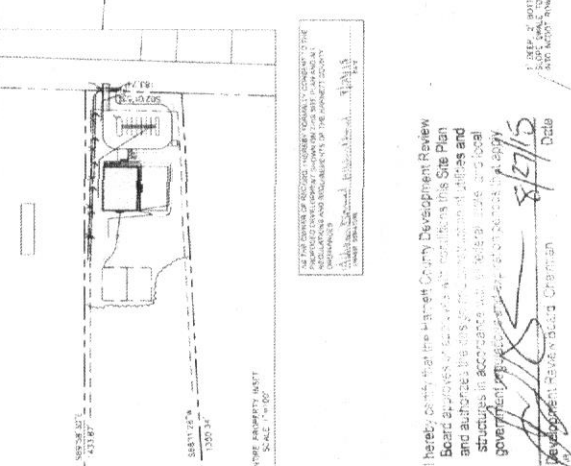

I hereby certify that the Independent County Development Review Board approved the plans with conditions. This Site Plan and authorizes the design, construction, installation, and operation of the proposed improvements in accordance with the local government rules and regulations. I am a duly licensed Professional Engineer in the State of North Carolina.

DATE: 08/27/15
DESIGNED BY: [Signature]
DATE: 08/27/15

