

# Southeastern Soil & Environmental Associates, Inc.

P.O. Box 9321  
Fayetteville, NC 28311  
Phone/Fax (910) 822-4540  
Email meaker3851@aol.com

January 25, 2008

Mr. Jimmy Johnson  
Johnson Properties  
PO Box 310  
Angier, NC 27501

Re: Soil/site evaluation & proposed design for subsurface waste disposal system, Lot 12,  
Angier Industrial Park, Harnett County, North Carolina

Dear Mr. Johnson,

A soil/site evaluation has been conducted on the aforementioned property. The subject site is located off NC Hwy. 210 as shown on the accompanying map. The purpose of the investigation was to determine if soils were acceptable for a subsurface waste disposal system to serve a proposed office building [12 employees and auction hall with 156 seats (not permanent) for 1 to 2 auctions per month]. All ratings and determinations were made in accordance with "Laws and Rules for Sanitary Sewage Collection, Treatment, and Disposal, 15A NCAC 18A .1900".

At least one site was located on the property that contained soils that have suitable soil properties exceeding 36 inches. The site essentially lies on a linear slope (3%) landscape. Soil borings conducted in most of this area consisted of 12 to 15 inches of sand/loamy sand underlain by sandy clay loam and/or clay loam extending to 40 or more inches. Soil wetness (colors of chroma 2 or less) was typically observed greater than 36 inches below the soil surface. All other soil characteristics were either suitable to at least 36 inches.

In my opinion, based on soil borings, a tentative layout and site conditions, it appears that this site would be suitable for the proposed subsurface system to serve the facility.



# Southeastern Soil & Environmental Associates, Inc.

P.O. Box 9321  
Fayetteville, NC 28311  
Phone/Fax (910) 822-4540  
Email meaker3851@aol.com

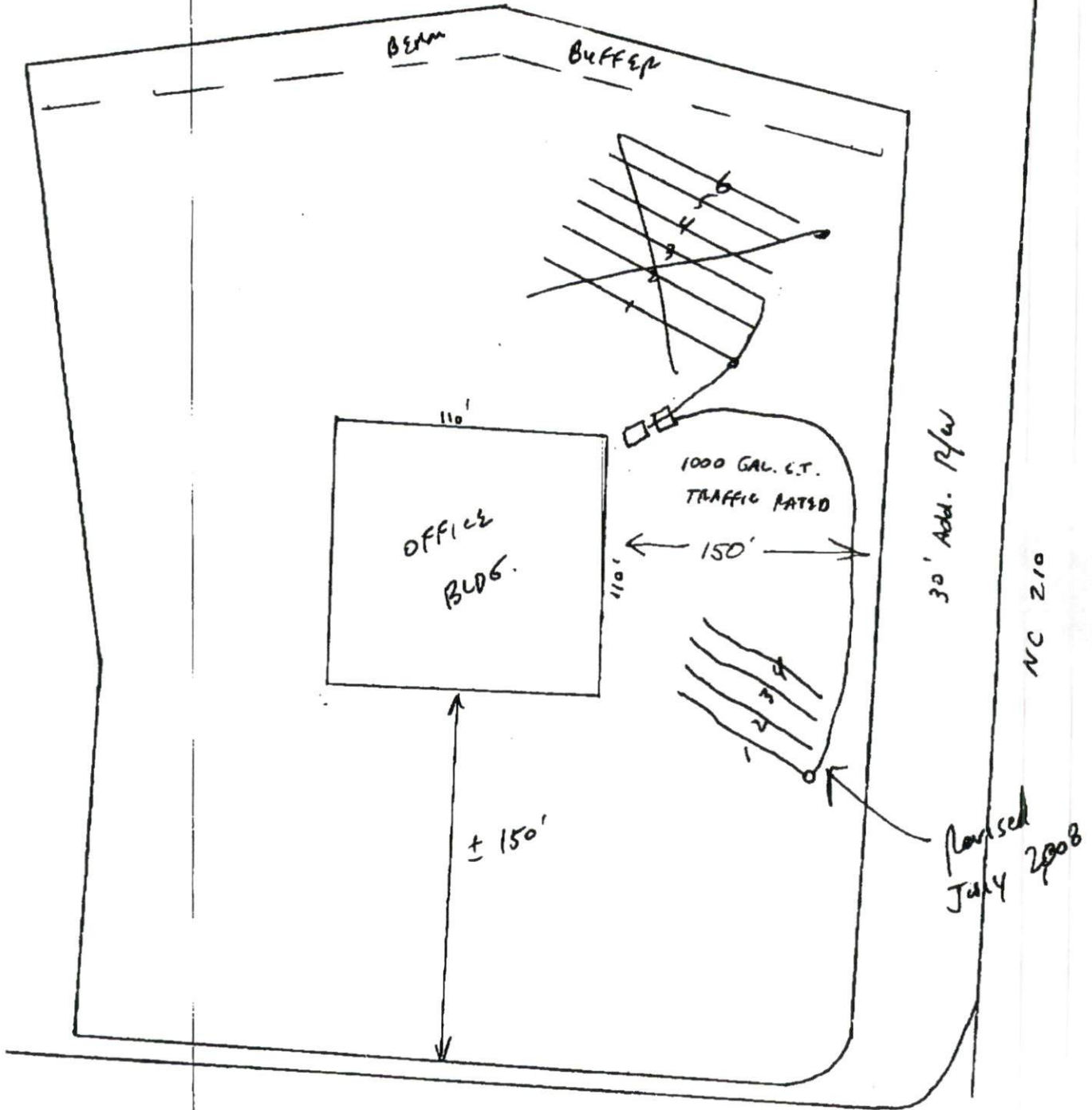

Map # 2004-738



# Southeastern Soil & Environmental Associates, Inc.

P.O. Box 9321  
Fayetteville, NC 28311  
Phone/Fax (910) 822-4540  
Email meaker3851@aol.com

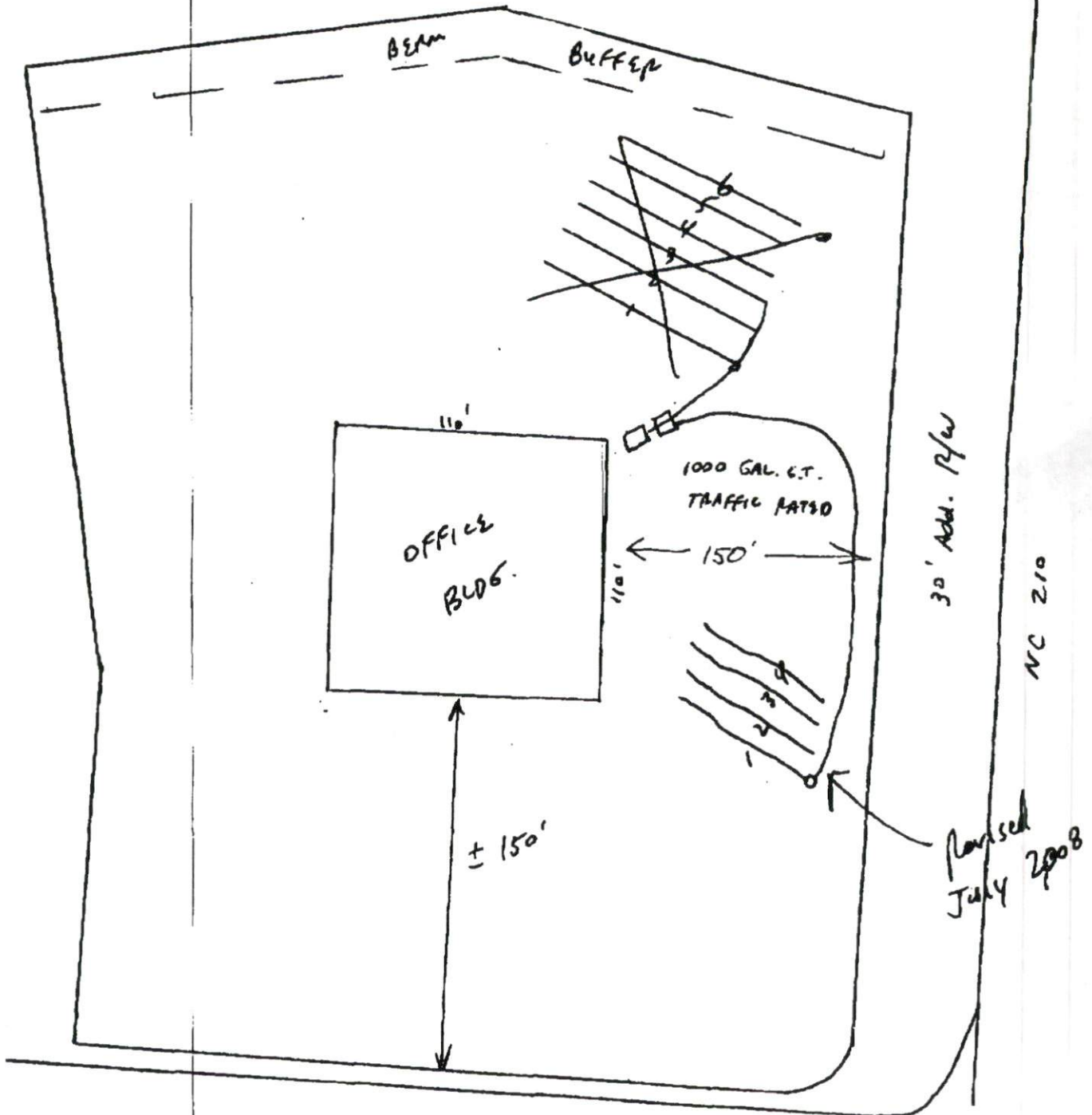

Map # 2004-738

Daily flow is figured at:

12 employees x 25 gal/employee = 300 gpd  
 156 seats x 3 gallons per seat (similar to a church) = 468 gallons  
 468 gallons x 2 use per month = 936 gallons/30 days = 31.2 gpd  
 300 gpd + 31.2 gpd = 331.2 gpd x 15% (overage) = 49.68 gpd  
 Total proposed facility flow = 331.2 gpd + 49.68 gpd = 381 GPD  
 Proposed LTAR = 0.4 gpd/sq. ft.  
 Required drainfield = 240 linear feet of approved 25% reduction = (3 drainlines @ 80 linear feet)

The system would include a 1000 gallon septic tank as shown on the proposed layout (see attached). Proposed drainlines are flagged as shown for health department review.

I have attached a summary of water use for 2007 at the existing 12 employee facility. The highest daily water use is 146.3 gpd. Based on this actual flow and the assumed additional flow, it is my opinion that the proposed system is sufficient to handle new facility.

At this time you should file an application with the Harnett County Health Department for the proposed facility. Once the county inspector has evaluated the site (and made any further recommendations or requirements), we will gladly complete any additional design requirements.

This report, of course, does not guarantee, constitute or imply approval or issuance of permit as issued by the Harnett County Health Department. This report only represents my professional opinion as a licensed soil scientist. Permits will only be granted if health department personnel concur with the findings of this report.

Sincerely,

Mike Eaker  
President

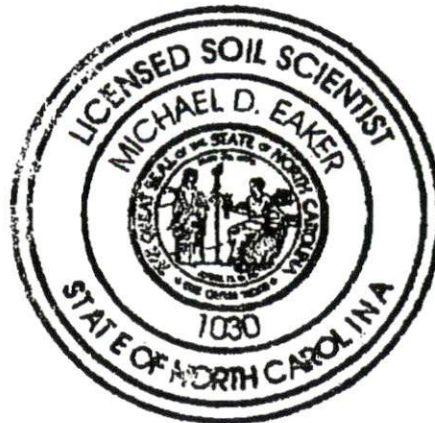

20.5

Oct 16 08 01:44p

mi el eaker

910 24540

p.2

Jan. 18. 2008 11:10AM

JOHNSON PROPERTIES

11/1/07 11:10

ACCOUNT # 2438 SERV ADDR 50 \E DEPOT ST  
 ROUTE/SEQ # 4/ 45801 NAME JOHNSON PROPERTIES

METER 1 METER#/TYP 27330687 W SIZE CURR READ 613200  
 MULT/ZEROS 0 0 0.75 PREV READ 610690

YR1	USAGE	BILL DATE	DAYS	SRC	YR2	USAGE	BILL DATE	DAYS	SRC
1-JAN	3220	1/31/07	31	H	JAN	3170	1/31/06	30	H
2-FEB	2910	2/28/07	27	H	FEB	3950	2/28/06	29	H
3-MAR	3290	3/30/07	29	H	MAR	2650	3/31/06	28	H
4-APR	4220	4/30/07	35	H	APR	3160	4/28/06	34	H
5-MAY	2850	5/31/07	28	H	MAY	3100	5/31/06	28	H
6-JUN	2720	6/29/07	28	H	JUN	3230	6/30/06	33	H
7-JUL	2990	7/31/07	35	H	JUL	2820	7/31/06	29	H
8-AUG	3110	8/31/07	28	H	AUG	3500	8/31/06	29	H
9-SEP	2870	9/28/07	29	H	SEP	4100	9/30/06	34	H
10-OCT	3280	10/31/07	34	H	OCT	3340	10/31/06	30	H
11-NOV	2990	11/30/07	29	H	NOV	2490	11/30/06	28	H
12-DEC	2510	12/31/07	28	H	DEC	2240	12/29/06	32	H
AVG	3080				AVG	3146			

OPTION(C-CHG D-SHW DMD 1,2,4,5,6,7-PGE T-TRAN M-MTR G-CONT Y-ANLY N-NO ACTION)

910 -  
 822 -  
 4540  
 Mike