

HTE# 08-5-21314

Harnett County Department of Public Health 24588

Improvement Permit

A building permit cannot be issued with only an Improvement Permit

ISSUED TO: Jimmy Johnson PROPERTY LOCATION: 210
 SUBDIVISION _____ LOT # _____
 NEW REPAIR EXPANSION Site Improvements required prior to Construction Authorization Issuance: _____
 Type of Structure: Office Building
 Proposed Wastewater System Type: Pump to 25% Reduction System
 Projected Daily Flow: 381 GPD - Based on consultant
 Number of bedrooms: _____ Number of Occupants: 12 max
 Basement Yes No
 Pump Required: Yes No May be required based on final location and elevations of facilities
 Type of Water Supply: Community Public Well Distance from well _____ feet Permit valid for: Five years
 No expiration
 Permit conditions: _____

Authorized State Agent: Bryan McSwain, R.S. Date: 1/14/2009 SEE ATTACHED SITE SKETCH
 The issuance of this permit by the Health Department in no way guarantees the issuance of other permits. The permit holder is responsible for checking with appropriate governing bodies in meeting their requirements. This site is subject to revocation if the site plan, plat, or the intended use changes. The Improvement Permit shall not be affected by a change in ownership of the site. This permit is subject to compliance with the provisions of the Laws and Rules for Sewage Treatment and Disposal and to conditions of this permit.

Construction Authorization

(Required for Building Permit)

The construction and installation requirements of Rules .1950, .1952, .1954, .1955, .1956, .1957, .1958, and .1959 are incorporated by references into this permit and shall be met. Systems shall be installed in accordance with the attached system layout.

ISSUED TO: Jimmy Johnson PROPERTY LOCATION: 210
 SUBDIVISION _____ LOT # _____
 Facility Type: Office Building New Expansion Repair
 Basement? Yes No Basement Fixtures? Yes No
 Type of Wastewater System** Pump to 25% Reduction (Initial) Wastewater Flow: 381 GPD
 (See note below, if applicable Pump to 25% Reduction (Repair))

Installation Requirements/Conditions

* Septic Tank Size 1000 gallons Exact length of each trench 4 X 60 feet Trench Spacing: 9 Feet on Center
 Pump Tank Size 1000 gallons Trenches shall be installed on contour at a Soil Cover: 6 inches
 Contractor to meet on site prior to installing system Maximum Trench Depth of: 18 inches (Maximum soil cover shall not exceed 36" above the trench bottom)
 (Trench bottoms shall be level to +/- 1/4" in all directions)
 Pump Requirements: _____ ft. TDH vs. _____ GPM _____ inches below pipe
 Aggregate Depth: _____ inches above pipe
 Conditions: * Both the Septic + Pump tanks are to be Traffic Rated
Drainliner to be run on contour + NO DEEPER than 18 inches
 _____ inches total

**If applicable: I understand the system type specified is different from the type specified on the application. I accept the specifications of this permit.

Owner/Legal Representative Signature: _____ Date: _____

This Construction Authorization is subject to revocation if the site plan, plat, or the intended use changes. The Construction Authorization shall not be transferred when there is a change in ownership of the site. This Construction Authorization is subject to compliance with the provisions of the Laws and Rules for Sewage Treatment and Disposal and to the conditions of this permit.

Authorized State Agent: Bryan McSwain, R.S. Date: 1/14/2009 SEE ATTACHED SITE SKETCH
 Construction Authorization Expiration Date: 1/14/2014

HTE# 08-5-21314

Permit # 24588

Harnett County Department of Public Health Site Sketch

ISSUED TO: Jimmy Johnson PROPERTY LOCATOR: 210
SUBDIVISION _____ LOT # _____

Authorized State Agent: Bryan McSwain, P.E. Date: 1/14/2009

* Contractor to meet onsite prior to installing system

* Tank placement may change

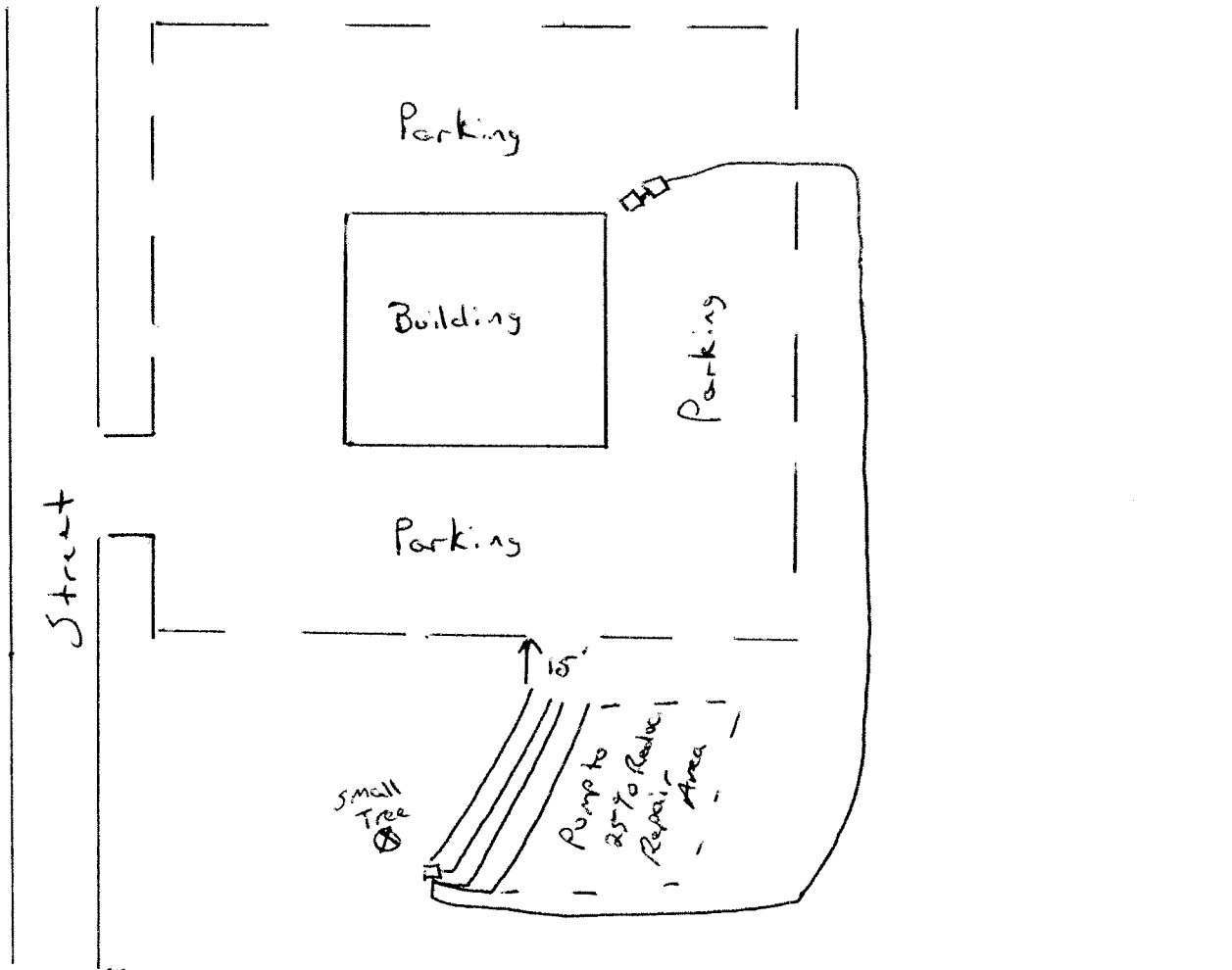

Hwy 210