

Initial Application Date: 11/14/17

Application # 17-50042749
CU# _____

COUNTY OF HARNETT RESIDENTIAL LAND USE APPLICATION

Central Permitting 108 E. Front Street, Lillington, NC 27546 Phone: (910) 893-7525 ext:2 Fax: (910) 893-2793 www.harnett.org/permits

****A RECORDED SURVEY MAP, RECORDED DEED (OR OFFER TO PURCHASE) & SITE PLAN ARE REQUIRED WHEN SUBMITTING A LAND USE APPLICATION****

LANDOWNER: Tim Roberts Mailing Address: 6963 Rawls Church Rd
City: Fayetteville State: NC Zip: 27526 Contact No: 919-818-6209 Email: 14troberts14@gmail.com

APPLICANT*: Tim Roberts Mailing Address: 6963 Rawls Church Rd
City: Fayetteville State: NC Zip: 27526 Contact No: 919-818-6209 Email: 14troberts14@gmail.com
*Please fill out applicant information if different than landowner

CONTACT NAME APPLYING IN OFFICE: _____ Phone # _____

PROPERTY LOCATION: Subdivision: Halford Matthews Lot #: 3 Lot Size: 4.32
State Road # 1415 State Road Name: Rawls Church Rd. Map Book & Page: 2014 / 34
Parcel: 08D0644 0084 02 PIN: 0044-68-9019.000
Zoning: RA-30 Flood Zone: X Watershed: IV Deed Book & Page: 3504 / 449 Power Company*: _____

*New structures with Progress Energy as service provider need to supply premise number _____ from Progress Energy.

PROPOSED USE:

- SFD: (Size _____ x _____) # Bedrooms: _____ # Baths: _____ Basement(w/wo bath): _____ Garage: _____ Deck: _____ Crawl Space: _____ Slab: _____ Slab: _____
(Is the bonus room finished? () yes () no w/ a closet? () yes () no (if yes add in with # bedrooms) Monolithic
- Mod: (Size _____ x _____) # Bedrooms _____ # Baths _____ Basement (w/wo bath) _____ Garage: _____ Site Built Deck: _____ On Frame _____ Off Frame _____
(Is the second floor finished? () yes () no Any other site built additions? () yes () no
- Manufactured Home: _____ SW _____ DW _____ TW (Size _____ x _____) # Bedrooms: _____ Garage: _____ (site built? _____) Deck: _____ (site built? _____)
- Duplex: (Size _____ x _____) No. Buildings: _____ No. Bedrooms Per Unit: _____
- Home Occupation: # Rooms: _____ Use: _____ Hours of Operation: _____ #Employees: _____
- Addition/Accessory/Other: (Size 32 x 30) Use: Storage Closets in addition? () yes () no

Water Supply: County _____ Existing Well _____ New Well (# of dwellings using well _____) *Must have operable water before final

Sewage Supply: _____ New Septic Tank (Complete Checklist) Existing Septic Tank (Complete Checklist) _____ County Sewer

Does owner of this tract of land, own land that contains a manufactured home within five hundred feet (500') of tract listed above? () yes () no

Does the property contain any easements whether underground or overhead () yes () no

Structures (existing or proposed): Single family dwellings: Manufactured Homes: _____ Other (specify): proposed storage

Required Residential Property Line Setbacks:

Front	Minimum	<u>35</u>	Actual	<u>35+</u>
Rear		<u>25</u>		<u>25+</u>
Closest Side		<u>10</u>		<u>13.4'</u>
Sidestreet/corner lot		<u>20</u>		
Nearest Building on same lot		<u>10</u>		<u>15.4</u>

Comments: _____

SPECIFIC DIRECTIONS TO THE PROPERTY FROM LILLINGTON: _____

If permits are granted I agree to conform to all ordinances and laws of the State of North Carolina regulating such work and the specifications of plans submitted. I hereby state that foregoing statements are accurate and correct to the best of my knowledge. Permit subject to revocation if false information is provided.

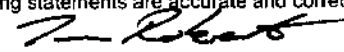

Signature of Owner or Owner's Agent

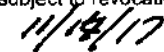

Date

It is the owner/applicants responsibility to provide the county with any applicable information about the subject property, including but not limited to: boundary information, house location, underground or overhead easements, etc. The county or its employees are not responsible for any incorrect or missing information that is contained within these applications.

****This application expires 6 months from the initial date if permits have not been issued****

NAME: _____

APPLICATION #: 17-50042749

This application to be filled out when applying for a septic system inspection.

County Health Department Application for Improvement Permit and/or Authorization to Construct

IF THE INFORMATION IN THIS APPLICATION IS FALSIFIED, CHANGED, OR THE SITE IS ALTERED, THEN THE IMPROVEMENT PERMIT OR AUTHORIZATION TO CONSTRUCT SHALL BECOME INVALID. The permit is valid for either 60 months or without expiration depending upon documentation submitted. (Complete site plan = 60 months; Complete plat = without expiration)

910-893-7525 option 1

CONFIRMATION # _____

Environmental Health New Septic System Code 800

- **All property irons must be made visible.** Place "pink property flags" on each corner iron of lot. All property lines must be clearly flagged approximately every 50 feet between corners.
- Place "orange house corner flags" at each corner of the proposed structure. Also flag driveways, garages, decks, out buildings, swimming pools, etc. Place flags per site plan developed at/for Central Permitting.
- Place orange Environmental Health card in location that is easily viewed from road to assist in locating property.
- If property is thickly wooded, Environmental Health requires that you clean out the **undergrowth** to allow the soil evaluation to be performed. Inspectors should be able to walk freely around site. **Do not grade property.**
- **All lots to be addressed within 10 business days after confirmation. \$25.00 return trip fee may be incurred for failure to uncover outlet lid, mark house corners and property lines, etc. once lot confirmed ready.**
- After preparing proposed site call the voice permitting system at 910-893-7525 option 1 to schedule and use code 800 (after selecting notification permit if multiple permits exist) for Environmental Health inspection. Please note confirmation number given at end of recording for proof of request.
- Use Click2Gov or IVR to verify results. Once approved, proceed to Central Permitting for permits.

Environmental Health Existing Tank Inspections Code 800

- Follow above instructions for placing flags and card on property.
- Prepare for inspection by removing soil over **outlet end** of tank as diagram indicates, and lift lid straight up (*if possible*) and then **put lid back in place.** (Unless inspection is for a septic tank in a mobile home park)
- **DO NOT LEAVE LIDS OFF OF SEPTIC TANK**
- After uncovering **outlet end** call the voice permitting system at 910-893-7525 option 1 & select notification permit if multiple permits, then use code 800 for Environmental Health inspection. Please note confirmation number given at end of recording for proof of request.
- Use Click2Gov or IVR to hear results. Once approved, proceed to Central Permitting for remaining permits.

SEPTIC

If applying for authorization to construct please indicate desired system type(s): can be ranked in order of preference, must choose one.

- { } Accepted { } Innovative { } Conventional { } Any
 { } Alternative { } Other _____

The applicant shall notify the local health department upon submittal of this application if any of the following apply to the property in question. If the answer is "yes", applicant **MUST ATTACH SUPPORTING DOCUMENTATION**:

- { } YES { } NO Does the site contain any Jurisdictional Wetlands?
 { } YES { } NO Do you plan to have an irrigation system now or in the future?
 { } YES { } NO Does or will the building contain any drains? Please explain. _____
 { } YES { } NO Are there any existing wells, springs, waterlines or Wastewater Systems on this property?
 { } YES { } NO Is any wastewater going to be generated on the site other than domestic sewage?
 { } YES { } NO Is the site subject to approval by any other Public Agency?
 { } YES { } NO Are there any Easements or Right of Ways on this property?
 { } YES { } NO Does the site contain any existing water, cable, phone or underground electric lines?

If yes please call No Cuts at 800-632-4949 to locate the lines. This is a free service.

I Have Read This Application And Certify That The Information Provided Herein Is True, Complete And Correct. Authorized County And State Officials Are Granted Right Of Entry To Conduct Necessary Inspections To Determine Compliance With Applicable Laws And Rules.

I Understand That I Am Solely Responsible For The Proper Identification And Labeling Of All Property Lines And Corners And Making The Site Accessible So That A Complete Site Evaluation Can Be Performed.

[Signature]
PROPERTY OWNERS OR OWNERS LEGAL REPRESENTATIVE SIGNATURE (REQUIRED)

11/14/17
DATE

R. OWLS CH RD.

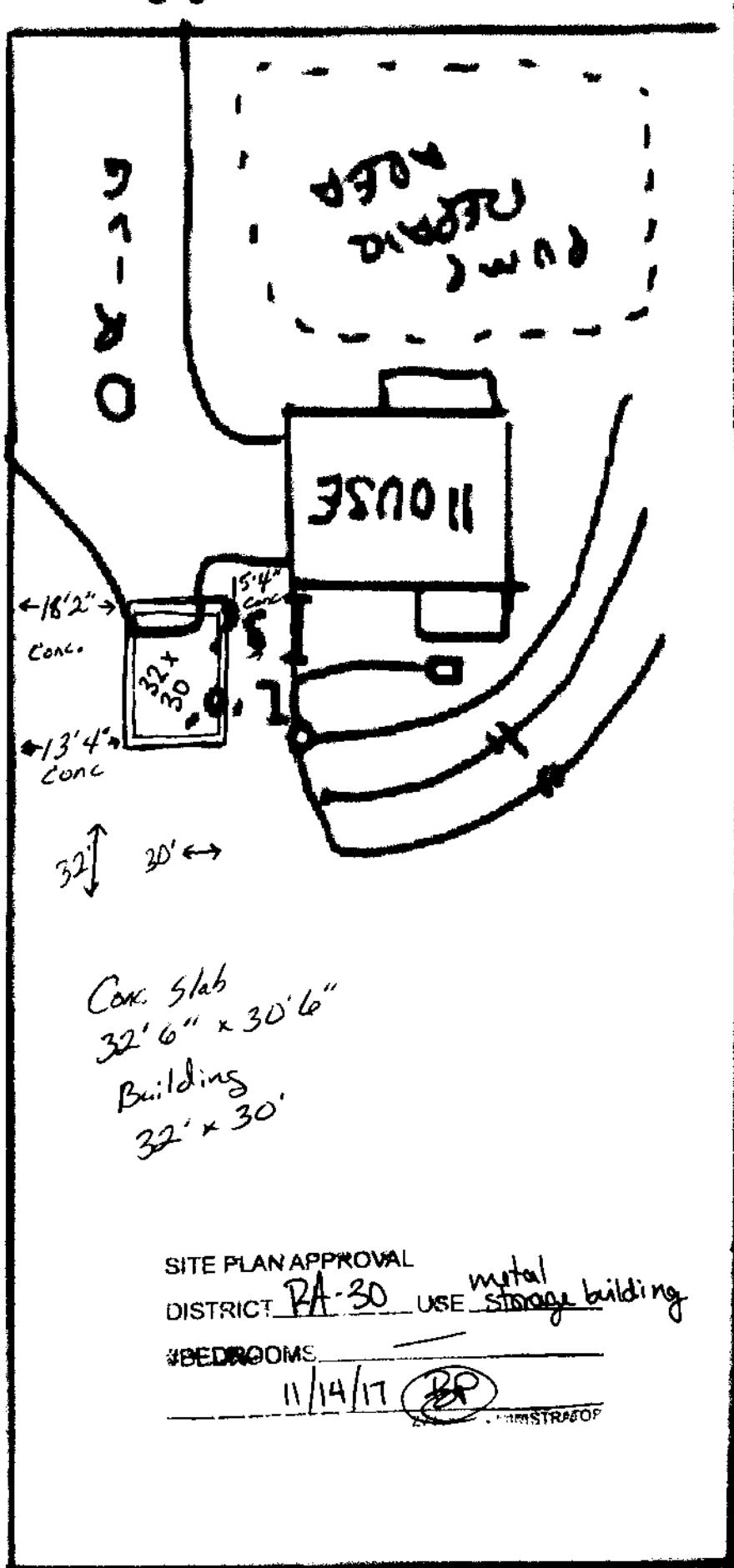

456

Conc. Slab
 32'6" x 30'6"
 Building
 32' x 30'

SITE PLAN APPROVAL
 DISTRICT RA-30 USE metal storage building

#BEDROOMS _____
 11/14/17 BP
 ADMINSTRATOR

200'

HARNETT COUNTY CASH RECEIPTS

*** CUSTOMER RECEIPT ***

Oper: BPETRICH Type: CP Drawer: 1
Date: 11/14/17 51 Receipt no: 151766

Year	Number	Amount
2017	58842749	
94834	TECH 4	
LILLINGTON, NC	27546	
B4	BP - ENV HEALTH FEES	\$100.00

EXISTING TANK

SHAMMON & TIM ROBERTS

Tender detail		
CK CHECK PAYMEN	4996	\$100.00
Total tendered		\$100.00
Total payment		\$100.00

Trans date: 11/14/17 Time: 10:35:09

** THANK YOU FOR YOUR PAYMENT **

Harnett County Central Permitting

PO Box 65 Lillington, NC 27546

910-893-7525 Fax 910-893-2793 www.harnett.org/permits

* Each section below to be filled out by whomever performing work. Must be owner or licensed contractor. Address, company name & phone must match

Application for Residential Building and Trades Permit

Owner's Name: Tim Roberts Date: 11/18/17
Site Address: 6963 Parks Church Rd FVAK 27226 Phone: 919-818-6209
Directions to job site from Lillington: _____

Subdivision: _____ Lot: _____
Description of Proposed Work: _____ # of Bedrooms: _____
Heated SF: _____ Unheated SF: _____ Finished Bonus Room? _____ Crawl Space: _____ Slab: _____

General Contractor Information

Southeastern Outdoor _____
Building Contractor's Company Name Telephone _____
613 East Railroad St Clinton, NC _____
Address Email Address _____
License # _____

Electrical Contractor Information

Description of Work _____ Service Size: _____ Amps T-Pole: ___ Yes ___ No
Electrical Contractor's Company Name Telephone _____
Address Email Address _____
License # _____

Mechanical/HVAC Contractor Information

Description of Work _____
Mechanical Contractor's Company Name Telephone _____
Address Email Address _____
License # _____

Plumbing Contractor Information

Description of Work _____ # Baths _____
Plumbing Contractor's Company Name Telephone _____
Address Email Address _____
License # _____

Insulation Contractor Information

Insulation Contractor's Company Name & Address Telephone _____

*NOTE: General Contractor / owner must fill out and sign the second page of this application.

I hereby certify that I have the authority to make necessary application, that the application is correct and that the construction will conform to the regulations in the Building, Electrical, Plumbing and Mechanical codes, and the Harnett County Zoning Ordinance. I state the information on the above contractors is correct as known to me and that **by signing below I have obtained all subcontractors permission to obtain these permits** and if **any** changes occur including listed contractors, site plan, number of bedrooms, building and trade plans, Environmental Health permit changes or proposed use changes, I certify it is my responsibility to notify the Harnett County Central Permitting Department of any and all changes.

EXPIRED PERMIT FEES - 6 Months to 2 years permit re-issue fee is \$150.00. After 2 years re-issue fee is as per current fee schedule.



Signature of Owner/Contractor/Officer(s) of Corporation

11/14/17

Date

Affidavit for Worker's Compensation N.C.G.S. 87-14

The undersigned applicant being the:

____ General Contractor Owner ____ Officer/Agent of the Contractor or Owner

Do hereby confirm under penalties of perjury that the person(s), firm(s) or corporation(s) performing the work set forth in the permit:

____ Has three (3) or more employees and has obtained workers' compensation insurance to cover them.

____ Has one (1) or more subcontractors(s) and has obtained workers' compensation insurance to cover them.

____ Has one (1) or more subcontractors(s) who has their own policy of workers' compensation insurance covering themselves.

____ Has no more than two (2) employees and no subcontractors.

While working on the project for which this permit is sought it is understood that the Central Permitting Department issuing the permit may require certificates of coverage of worker's compensation insurance prior to issuance of the permit and at any time during the permitted work from any person, firm or corporation carrying out the work.

Company or Name: _____

Sign with:  _____ Date: 12/1/17