

Initial Application Date: 2-16-17

Application # 1750040760

CU# _____

COUNTY OF HARNETT RESIDENTIAL LAND USE APPLICATION

Central Permitting 108 E. Front Street, Lillington, NC 27546 Phone: (910) 893-7525 ext:2 Fax: (910) 893-2793 www.harnett.org/permits

****A RECORDED SURVEY MAP, RECORDED DEED (OR OFFER TO PURCHASE) & SITE PLAN ARE REQUIRED WHEN SUBMITTING A LAND USE APPLICATION****

LANDOWNER: SUNDQUIST, DAN H Kay Mailing Address: 2916 OLD BUIES CREEK ROAD

City: ANGIER State: NC Zip: 27501 Contact No: 919 639-6444 Email: dan.sund@ymail.com

APPLICANT*: _____ Mailing Address: _____

City: _____ State: _____ Zip: _____ Contact No: _____ Email: _____

*Please fill out applicant information if different than landowner

CONTACT NAME APPLYING IN OFFICE: Dan Sundquist Phone # 919 639-6444

PROPERTY LOCATION: Subdivision: _____ Lot #: _____ Lot Size: 14.30

State Road # _____ State Road Name: 2918 Old Buiies Creek Rd Map Book & Page: - 1-

Parcel: 040672 0054 PIN: 6072-70-5446-000

Zoning: RA-30 Flood Zone: - Watershed: - Deed Book & Page: 1035, 1278 Power Company*: _____

*New structures with Progress Energy as service provider need to supply premise number _____ from Progress Energy.

PROPOSED USE:

SFD: (Size _____ x _____) # Bedrooms: _____ # Baths: _____ Basement(w/wo bath): _____ Garage: _____ Deck: _____ Crawl Space: _____ Slab: _____ Slab: _____
(Is the bonus room finished? () yes () no w/ a closet? () yes () no (if yes add in with # bedrooms)

Mod: (Size _____ x _____) # Bedrooms _____ # Baths _____ Basement (w/wo bath) _____ Garage: _____ Site Built Deck: _____ On Frame _____ Off Frame _____
(Is the second floor finished? () yes () no Any other site built additions? () yes () no

Manufactured Home: _____ SW _____ DW _____ TW (Size _____ x _____) # Bedrooms: _____ Garage: _____ (site built?) _____ Deck: _____ (site built?) _____

Duplex: (Size _____ x _____) No. Buildings: _____ No. Bedrooms Per Unit: _____

Home Occupation: # Rooms: _____ Use: _____ Hours of Operation: _____ #Employees: _____

Addition/Accessory/Other: (Size 46' x 24') Use: Metal Storage Closets in addition? () yes no

Water Supply: County _____ Existing Well _____ New Well (# of dwellings using well _____) *Must have operable water before final

Sewage Supply: _____ New Septic Tank (Complete Checklist) Existing Septic Tank (Complete Checklist) _____ County Sewer

Does owner of this tract of land, own land that contains a manufactured home within five hundred feet (500') of tract listed above? () yes no

Does the property contain any easements whether underground or overhead () yes () no

Structures (existing or proposed): Single family dwellings: _____ Manufactured Homes: _____ Other (specify): _____

Required Residential Property Line Setbacks:

Front	Minimum	Actual
Rear		<u>25+</u>
Closest Side	<u>10</u>	<u>+/- 40</u>
Sidestreet/corner lot		
Nearest Building on same lot		

Comments: PROPOSED: Farm metal storage building, approximately 24' x 46' on concrete slab / footings. No water, sewer, heat or insulation.

See accompanying site drawings.

SPECIFIC DIRECTIONS TO THE PROPERTY FROM LILLINGTON: Turn into driveway for 2918 Old Buies Creek Road, Angier and drive up to and behind 2918 house. West edge of new building to be approximately 120' east of 2918 house and South edge to be approximately 40' from property line of adjoining Capps property.

If permits are granted I agree to conform to all ordinances and laws of the State of North Carolina regulating such work and the specifications of plans submitted. I hereby state that foregoing statements are accurate and correct to the best of my knowledge. Permit subject to revocation if false information is provided.

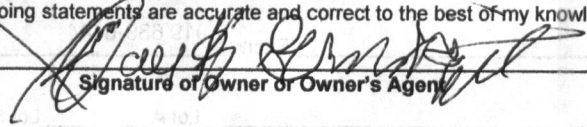
Signature of Owner or Owner's Agent

2-10-17
Date

It is the owner/applicants responsibility to provide the county with any applicable information about the subject property, including but not limited to: boundary information, house location, underground or overhead easements, etc. The county or its employees are not responsible for any incorrect or missing information that is contained within these applications.

This application expires 6 months from the initial date if permits have not been issued

NAME: _____

APPLICATION #: 40760

This application to be filled out when applying for a septic system inspection.

County Health Department Application for Improvement Permit and/or Authorization to Construct

IF THE INFORMATION IN THIS APPLICATION IS FALSIFIED, CHANGED, OR THE SITE IS ALTERED, THEN THE IMPROVEMENT PERMIT OR AUTHORIZATION TO CONSTRUCT SHALL BECOME INVALID. The permit is valid for either 60 months or without expiration depending upon documentation submitted. (Complete site plan = 60 months; Complete plat = without expiration)

910-893-7525 option 1

CONFIRMATION # 020639

Environmental Health New Septic System Code 800

- **All property irons must be made visible.** Place "pink property flags" on each corner iron of lot. All property lines must be clearly flagged approximately every 50 feet between corners.
- Place "orange house corner flags" at each corner of the proposed structure. Also flag driveways, garages, decks, out buildings, swimming pools, etc. Place flags per site plan developed at/for Central Permitting.
- Place orange Environmental Health card in location that is easily viewed from road to assist in locating property.
- If property is thickly wooded, Environmental Health requires that you clean out the **undergrowth** to allow the soil evaluation to be performed. Inspectors should be able to walk freely around site. **Do not grade property.**
- **All lots to be addressed within 10 business days after confirmation. \$25.00 return trip fee may be incurred for failure to uncover outlet lid, mark house corners and property lines, etc. once lot confirmed ready.**
- After preparing proposed site call the voice permitting system at 910-893-7525 option 1 to schedule and use code **800** (after selecting notification permit if multiple permits exist) for Environmental Health inspection. Please note confirmation number given at end of recording for proof of request.
- Use Click2Gov or IVR to verify results. Once approved, proceed to Central Permitting for permits.

Environmental Health Existing Tank Inspections Code 800

- Follow above instructions for placing flags and card on property.
- Prepare for inspection by removing soil over **outlet end** of tank as diagram indicates, and lift lid straight up (*if possible*) and then **put lid back in place.** (Unless inspection is for a septic tank in a mobile home park)
- **DO NOT LEAVE LIDS OFF OF SEPTIC TANK**
- After uncovering **outlet end** call the voice permitting system at 910-893-7525 option 1 & select notification permit if multiple permits, then use code **800** for Environmental Health inspection. Please note confirmation number given at end of recording for proof of request.
- Use Click2Gov or IVR to hear results. Once approved, proceed to Central Permitting for remaining permits.

SEPTIC

If applying for authorization to construct please indicate desired system type(s): can be ranked in order of preference, must choose one.

- Accepted Innovative Conventional Any
 Alternative Other _____

The applicant shall notify the local health department upon submittal of this application if any of the following apply to the property in question. If the answer is "yes", applicant **MUST ATTACH SUPPORTING DOCUMENTATION**:

- YES NO Does the site contain any Jurisdictional Wetlands?
 YES NO Do you plan to have an irrigation system now or in the future?
 YES NO Does or will the building contain any drains? Please explain. _____
 YES NO Are there any existing wells, springs, waterlines or Wastewater Systems on this property?
 YES NO Is any wastewater going to be generated on the site other than domestic sewage?
 YES NO Is the site subject to approval by any other Public Agency?
 YES NO Are there any Easements or Right of Ways on this property?
 YES NO Does the site contain any existing water, cable, phone or underground electric lines?

If yes please call No Cuts at 800-632-4949 to locate the lines. This is a free service.

I Have Read This Application And Certify That The Information Provided Herein Is True, Complete And Correct. Authorized County And State Officials Are Granted Right Of Entry To Conduct Necessary Inspections To Determine Compliance With Applicable Laws And Rules.

I Understand That I Am Solely Responsible For The Proper Identification And Labeling Of All Property Lines And Corners And Making The Site Accessible So That A Complete Site-Evaluation Can Be Performed.

[Signature]
PROPERTY OWNERS OR OWNERS LEGAL REPRESENTATIVE SIGNATURE (REQUIRED)

2-10-17
DATE



Harnett County Parcel Viewer

Harnett GIS



Find address or place

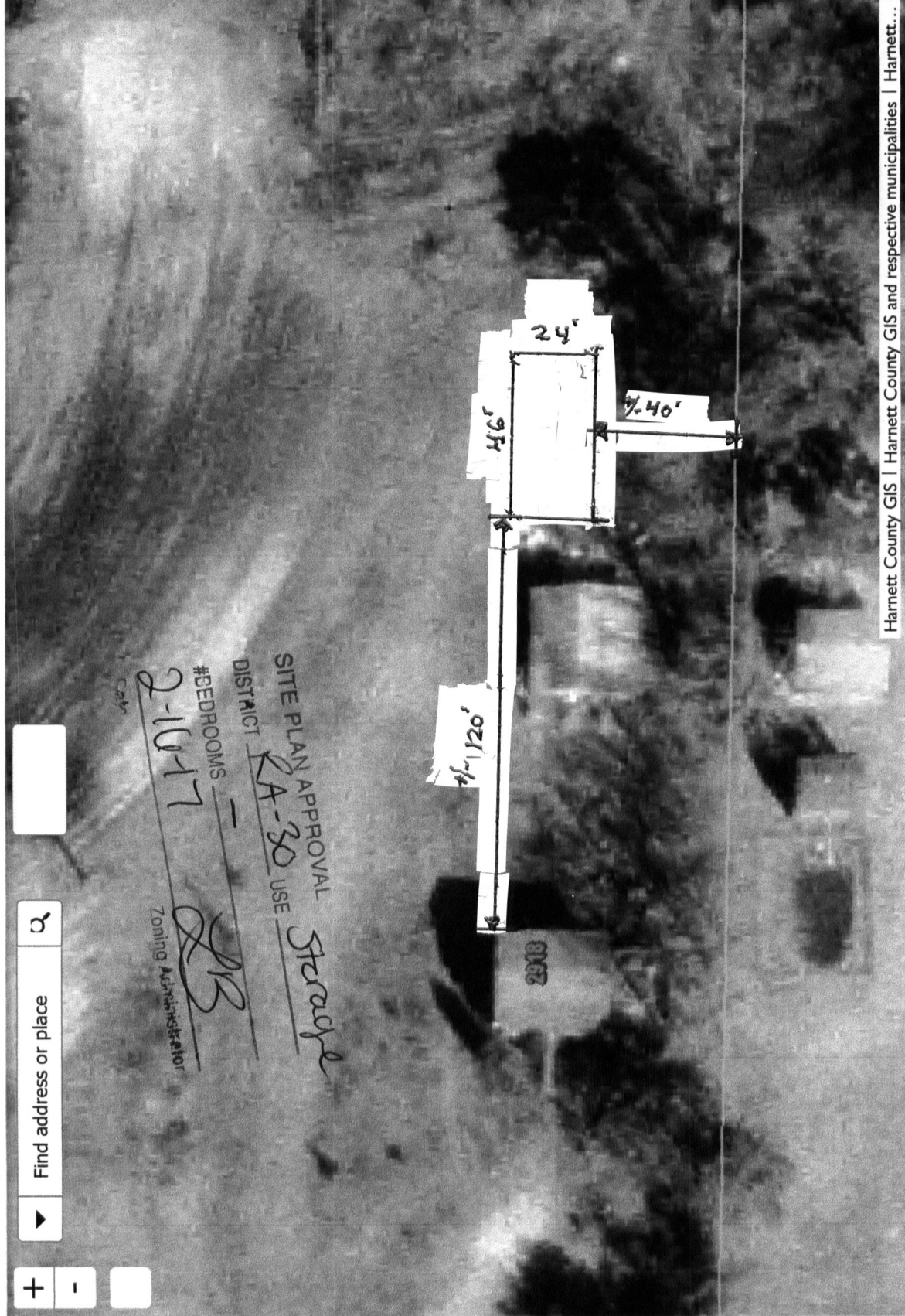

SITE PLAN APPROVAL
 DISTRICT RA-30 USE Storage
 #BEDROOMS 2-10-17
 Zoning Administrator *[Signature]*

Harnett County GIS | Harnett County GIS and respective municipalities | Harnett...



35.471 -78.739 Degrees



Harnett County Parcel Viewer

Harnett GIS



35.472 -78.740 Degrees

Harnett County GIS | Harnett County GIS and respective municipalities | Harnett...

40700

Harnett County Central Permitting
PO Box 65 Lillington NC 27546
910 893 7525 Fax 910 893 2793 www.harnett.org/permits

Each section below to be filled out by whomever performing work. Must be owner or licensed contractor. Address company name & phone must match.

Application for Residential Building and Trades Permit

Owner's Name SUNDQUIST, DAN H Date _____
Site Address 2918 OLD BUIES CREEK ROAD, ANGIER Phone 919 639-6444
Directions to job site from Lillington TURN IN DRIVEWAY FOR 2918 OLD BUIES CREEK RD. DRIVE UP TO AND BEHIND 2918 HOUSE. NEW BUILDING APPROXIMATELY 130' EAST OF 2918 HOUSE.
Subdivision _____ Lot _____
Description of Proposed Work FARM METAL STORAGE BUILDING # of Bedrooms _____
Heated SF _____ Unheated SF 1080 Finished Bonus Room? _____ Crawl Space _____ Slab

General Contractor Information

GREGORY INC.
Building Contractor's Company Name _____ Telephone _____
63 E. MEIVER ST., ANGIER NC 27501 Address _____ GREGORYINCLANMAN@GMAIL.COM Email Address _____
36220 License # _____

Electrical Contractor Information

Description of Work _____ Service Size _____ Amps T-Pole _____ Yes _____ No
Electrical Contractor's Company Name _____ Telephone _____
Address _____ Email Address _____
License # _____

Mechanical/HVAC Contractor Information

Description of Work _____
Mechanical Contractor's Company Name _____ Telephone _____
Address _____ Email Address _____
License # _____

Plumbing Contractor Information

Description of Work _____ # Baths _____
Plumbing Contractor's Company Name _____ Telephone _____
Address _____ Email Address _____
License # _____

Insulation Contractor Information

Insulation Contractor's Company Name & Address _____ Telephone _____

*NOTE General Contractor must fill out and sign the second page of this application

I hereby certify that I have the authority to make necessary application that the application is correct and that the construction will conform to the regulations in the Building Electrical Plumbing and Mechanical codes and the Harnett County Zoning Ordinance I state the information on the above contractors is correct as known to me and that by signing below I have obtained all subcontractors permission to obtain these permits and if any changes occur including listed contractors site plan number of bedrooms building and trade plans Environmental Health permit changes or proposed use changes I certify it is my responsibility to notify the Harnett County Central Permitting Department of any and all changes

EXPIRED PERMIT FEES - 6 Months to 2 years permit re-issue fee is \$150 00 After 2 years re-issue fee is as per current fee schedule

Dan H Sundquist
Signature of Owner/Contractor/Officer(s) of Corporation

3/23/2017
Date

Affidavit for Worker's Compensation N C G S 87-14

The undersigned applicant being the

General Contractor Owner Officer/Agent of the Contractor or Owner

Do hereby confirm under penalties of perjury that the person(s) firm(s) or corporation(s) performing the work set forth in the permit

Has three (3) or more employees and has obtained workers compensation insurance to cover them

Has one (1) or more subcontractors(s) and has obtained workers compensation insurance to cover them

Has one (1) or more subcontractors(s) who has their own policy of workers compensation insurance covering themselves

Has no more than two (2) employees and no subcontractors

While working on the project for which this permit is sought it is understood that the Central Permitting Department issuing the permit may require certificates of coverage of worker s compensation insurance prior to issuance of the permit and at any time during the permitted work from any person firm or corporation carrying out the work

Company or Name DAN SUNDRQUIST

Sign w/Title Dan H Sundquist OWNER Date 3/23/2017