

Initial Application Date: 4/11/16

Application # 1650040080

CU# _____

COUNTY OF HARNETT RESIDENTIAL LAND USE APPLICATION

Central Permitting 108 E. Front Street, Lillington, NC 27546 Phone: (910) 893-7525 ext:2 Fax: (910) 893-2793 www.harnett.org/permits

****A RECORDED SURVEY MAP, RECORDED DEED (OR OFFER TO PURCHASE) & SITE PLAN ARE REQUIRED WHEN SUBMITTING A LAND USE APPLICATION****

LANDOWNER: Darrell & Denise J. DeDeaux Mailing Address: 116 High Meadow Dr
City: Cameron State: NC Zip: 28326 Contact No: 919-717-2469 Email: dldedeaux@hotmail.com

APPLICANT*: Darrell & Denise DeDeaux Mailing Address: 116 High Meadow Dr
City: Cameron State: NC Zip: 28326 Contact No: 919-717-2469 Email: dldedeaux@hotmail.com

*Please fill out applicant information if different than landowner

CONTACT NAME APPLYING IN OFFICE: Darrell C. DeDeaux Phone # 919-717-2469/910-978-5028

PROPERTY LOCATION: Subdivision: Stoney Creek Manor Lot #: 37 Lot Size: .57
State Road # _____ State Road Name: 116 High Meadow Dr Map Book & Page: 1
Parcel: 039577 010337 PIN: 9576626802000
Zoning: R402R Flood Zone: X Watershed: MA Deed Book & Page: 2211 1294 Power Company*: _____

*New structures with Progress Energy as service provider need to supply premise number _____ from Progress Energy.

PROPOSED USE:

- SFD: (Size _____ x _____) # Bedrooms: _____ # Baths: _____ Basement(w/wo bath): _____ Garage: _____ Deck: _____ Crawl Space: _____ Slab: _____ Slab: _____
(Is the bonus room finished? () yes () no w/ a closet? () yes () no (if yes add in with # bedrooms)
- Mod: (Size _____ x _____) # Bedrooms _____ # Baths _____ Basement (w/wo bath) _____ Garage: _____ Site Built Deck: _____ On Frame _____ Off Frame _____
(Is the second floor finished? () yes () no Any other site built additions? () yes () no
- Manufactured Home: _____ SW _____ DW _____ TW (Size _____ x _____) # Bedrooms: _____ Garage: _____ (site built? _____) Deck: _____ (site built? _____)
- Duplex: (Size _____ x _____) No. Buildings: _____ No. Bedrooms Per Unit: _____
- Home Occupation: # Rooms: _____ Use: _____ Hours of Operation: _____ #Employees: _____

Addition/Accessory/Other: (Size 12 x 32) Use: Storage bldg w/power on temp foundation Closets in addition? () yes () no

Water Supply: County _____ Existing Well _____ New Well (# of dwellings using well _____) *Must have operable water before final

Sewage Supply: _____ New Septic Tank (Complete Checklist) Existing Septic Tank (Complete Checklist) _____ County Sewer

Does owner of this tract of land, own land that contains a manufactured home within five hundred feet (500') of tract listed above? () yes () no

Does the property contain any easements whether underground or overhead () yes () no

Structures (existing or proposed): Single family dwellings: _____ Manufactured Homes: _____ Other (specify): _____

Required Residential Property Line Setbacks:

	Minimum	Actual
Front	<u>35</u>	<u>35+</u>
Rear	<u>25</u>	<u>8</u>
Closest Side	<u>10</u>	<u>5</u>
Sidestreet/corner lot	<u>NA</u>	<u>NA</u>
Nearest Building on same lot	<u>NA</u>	<u>NA</u>

Comments: Confirm # 08869

Call ahead of time 4 insp - dogs in backyard

SPECIFIC DIRECTIONS TO THE PROPERTY FROM LILLINGTON: _____

If permits are granted I agree to conform to all ordinances and laws of the State of North Carolina regulating such work and the specifications of plans submitted. I hereby state that foregoing statements are accurate and correct to the best of my knowledge. Permit subject to revocation if false information is provided.

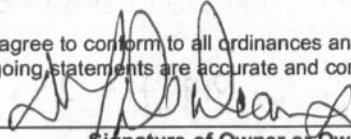

Signature of Owner or Owner's Agent

11/4/2016

Date

It is the owner/applicants responsibility to provide the county with any applicable information about the subject property, including but not limited to: boundary information, house location, underground or overhead easements, etc. The county or its employees are not responsible for any incorrect or missing information that is contained within these applications.

This application expires 6 months from the initial date if permits have not been issued

Measurements

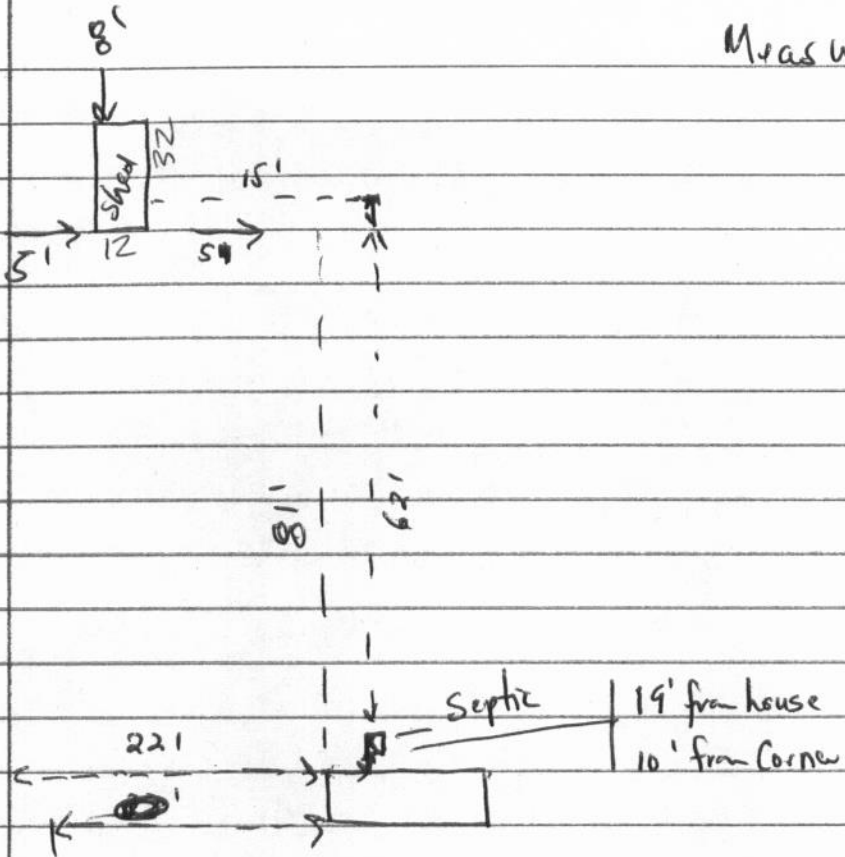

SITE PLAN APPROVAL

DISTRICT RAZOR USE Storage bldg

#BEDROOMS _____

4/10/16

ZONING ADMINISTRATOR

NAME: _____

APPLICATION #: _____

This application to be filled out when applying for a septic system inspection.

County Health Department Application for Improvement Permit and/or Authorization to Construct

IF THE INFORMATION IN THIS APPLICATION IS FALSIFIED, CHANGED, OR THE SITE IS ALTERED, THEN THE IMPROVEMENT PERMIT OR AUTHORIZATION TO CONSTRUCT SHALL BECOME INVALID. The permit is valid for either 60 months or without expiration depending upon documentation submitted. (Complete site plan = 60 months; Complete plat = without expiration)

910-893-7525 option 1

CONFIRMATION # _____

Environmental Health New Septic System Code 800

- **All property irons must be made visible.** Place "pink property flags" on each corner iron of lot. All property lines must be clearly flagged approximately every 50 feet between corners.
- Place "orange house corner flags" at each corner of the proposed structure. Also flag driveways, garages, decks, out buildings, swimming pools, etc. Place flags per site plan developed at/for Central Permitting.
- Place orange Environmental Health card in location that is easily viewed from road to assist in locating property.
- If property is thickly wooded, Environmental Health requires that you clean out the undergrowth to allow the soil evaluation to be performed. Inspectors should be able to walk freely around site. **Do not grade property.**
- **All lots to be addressed within 10 business days after confirmation. \$25.00 return trip fee may be incurred for failure to uncover outlet lid, mark house corners and property lines, etc. once lot confirmed ready.**
- After preparing proposed site call the voice permitting system at 910-893-7525 option 1 to schedule and use code **800** (after selecting notification permit if multiple permits exist) for Environmental Health inspection. Please note confirmation number given at end of recording for proof of request.
- Use Click2Gov or IVR to verify results. Once approved, proceed to Central Permitting for permits.

Environmental Health Existing Tank Inspections Code 800

- Follow above instructions for placing flags and card on property.
- Prepare for inspection by removing soil over **outlet end** of tank as diagram indicates, and lift lid straight up (*if possible*) and then **put lid back in place.** (Unless inspection is for a septic tank in a mobile home park)
- **DO NOT LEAVE LIDS OFF OF SEPTIC TANK**
- After uncovering **outlet end** call the voice permitting system at 910-893-7525 option 1 & select notification permit if multiple permits, then use code **800** for Environmental Health inspection. Please note confirmation number given at end of recording for proof of request.
- Use Click2Gov or IVR to hear results. Once approved, proceed to Central Permitting for remaining permits.

SEPTIC

If applying for authorization to construct please indicate desired system type(s): can be ranked in order of preference, must choose one.

- { } Accepted { } Innovative { } Conventional { } Any
 { } Alternative { } Other _____

The applicant shall notify the local health department upon submittal of this application if any of the following apply to the property in question. If the answer is "yes", applicant **MUST ATTACH SUPPORTING DOCUMENTATION**:

- { } YES { } NO Does the site contain any Jurisdictional Wetlands?
 { } YES { } NO Do you plan to have an irrigation system now or in the future?
 { } YES { } NO Does or will the building contain any drains? Please explain. _____
 { } YES { } NO Are there any existing wells, springs, waterlines or Wastewater Systems on this property?
 { } YES { } NO Is any wastewater going to be generated on the site other than domestic sewage?
 { } YES { } NO Is the site subject to approval by any other Public Agency?
 { } YES { } NO Are there any Easements or Right of Ways on this property?
 { } YES { } NO Does the site contain any existing water, cable, phone or underground electric lines?

If yes please call No Cuts at 800-632-4949 to locate the lines. This is a free service.

I Have Read This Application And Certify That The Information Provided Herein Is True, Complete And Correct. Authorized County And State Officials Are Granted Right Of Entry To Conduct Necessary Inspections To Determine Compliance With Applicable Laws And Rules. I Understand That I Am Solely Responsible For The Proper Identification And Labeling Of All Property Lines And Corners And Making The Site Accessible So That A Complete Site Evaluation Can Be Performed.

PROPERTY OWNERS OR OWNERS LEGAL REPRESENTATIVE SIGNATURE (REQUIRED)

11/4/2016

DATE

HARNETT COUNTY CASH RECEIPTS

*** CUSTOMER RECEIPT ***

Oper: JFORBES Type: CP Drawer: 1
Date: 11/04/16 51 Receipt no: 136038

Year	Number	Amount
2016	50040000	
92941	TECH 4	
LILLINGTON, NC	27546	
B4	BP - ENV HEALTH FEES	\$100.00

EXISTING TANK

DAKREL DEDEAUX

Tender detail		
CK CHECK PAYMEN	1210	\$100.00
Total tendered		\$100.00
Total payment		\$100.00

Trans date: 11/04/16 Time: 11:34:19

** THANK YOU FOR YOUR PAYMENT **

** THANK YOU FOR YOUR PAYMENT **

DATE: 11/01/12 TIME: 11:34:13

AMOUNT PAID \$100.00
CHECK AMOUNT \$100.00
CK CHECK AMOUNT \$100.00
TOTAL PAID

AMOUNT PAID

EXISTING BANK \$100.00

BY: ERIK NEWMAN
ATTENTION: NO. 53242
30301 1ST ST
SPR 20048800
1574 210064 800000

DATE: 11/01/12 BY: 800000
OBJ: 1100000 1000: 00 000000
*** ORIGINAL RECEIPT ***
HAWAII COMMUNITY COLLEGE