

HTE# 16-539187

# Harnett County Department of Public Health

28930

## Improvement Permit

A building permit cannot be issued with only an Improvement Permit

ISSUED TO: ROYAL OAKS BLDG. GRP. PROPERTY LOCATION: ATKINS RD  
 SUBDIVISION: ATKINS VILLAGE LOT # 30  
 NEW  REPAIR  EXPANSION   
 Type of Structure: SFO (45' x 67')  
 Proposed Wastewater System Type: 25% REDUCTION SYSTEM  
 Projected Daily Flow: 480 GPD  
 Number of bedrooms: 4 Number of Occupants: 8 max  
 Basement  Yes  No  
 Pump Required:  Yes  No  May be required based on final location and elevations of facilities  
 Type of Water Supply:  Community  Public  Well Distance from well 100 feet  
 Permit valid for:  Five years  No expiration  
 Permit conditions: \_\_\_\_\_

Authorized State Agent: [Signature] Date: 7/20/16 SEE ATTACHED SITE SKETCH  
 The issuance of this permit by the Health Department in no way guarantees the issuance of other permits. The permit holder is responsible for checking with appropriate governing bodies in meeting their requirements. This site is subject to revocation if the site plan, plat, or the intended use changes. The Improvement Permit shall not be affected by a change in ownership of the site. This permit is subject to compliance with the provisions of the Laws and Rules for Sewage Treatment and Disposal and to conditions of this permit.

## Construction Authorization

(Required for Building Permit)

The construction and installation requirements of Rules .1950, .1952, .1954, .1955, .1956, .1957, .1958, and .1959 are incorporated by references into this permit and shall be met. Systems shall be installed in accordance with the attached system layout.

ISSUED TO: ROYAL OAKS BLDG. GRP. PROPERTY LOCATION: ATKINS RD  
 SUBDIVISION: ATKINS VILLAGE LOT # 30  
 Facility Type: SFO (45' x 67')  New  Expansion  Repair  
 Basement?  Yes  No Basement Fixtures?  Yes  No  
 Type of Wastewater System\*\* 25% REDUCTION SYSTEM (Initial) Wastewater Flow: 480 GPD  
 (See note below, if applicable )

Pipe Block (Repair)  
**Installation Requirements/Conditions**  
 Septic Tank Size 1000 gallons Exact length of each trench 95 feet Trench Spacing: 9 Feet on Center  
 Pump Tank Size \_\_\_\_\_ gallons Trenches shall be installed on contour at a Soil Cover: 12 inches  
 Maximum Trench Depth of: 24 inches (Maximum soil cover shall not exceed 36" above the trench bottom)  
 (Trench bottoms shall be level to +/-1/4" in all directions)  
 Pump Requirements: \_\_\_\_\_ ft. TDH vs. \_\_\_\_\_ GPM \_\_\_\_\_ inches below pipe  
 Aggregate Depth: \_\_\_\_\_ inches above pipe  
 Conditions: PERMIT BASED ON PROPOSAL FROM APPLICANTS LSS \_\_\_\_\_ inches total

**WATER LINES (INCLUDING IRRIGATION) MUST BE 10FT. FROM ANY PART OF SEPTIC SYSTEM OR REPAIR AREA.  
NO UTILITIES ALLOWED IN INITIAL OR REPAIR DRAIN FIELD AREA.**

\*\*If applicable: I understand the system type specified is different from the type specified on the application. I accept the specifications of this permit.

Owner/Legal Representative Signature: \_\_\_\_\_ Date: \_\_\_\_\_  
 This Construction Authorization is subject to revocation if the site plan, plat, or the intended use changes. The Construction Authorization shall not be transferred when there is a change in ownership of the site. This Construction Authorization is subject to compliance with the provisions of the Laws and Rules for Sewage Treatment and Disposal and to the conditions of this permit. SEE ATTACHED SITE SKETCH

Authorized State Agent: [Signature] Date: 7/20/16  
 Construction Authorization Expiration Date: 7/20/21

HTE 16-5-39187

Atkins Village, Lot 30 Permit 28930  
4-Bedroom Septic System Layout  
May 2016

SITE PLAN APPROVAL

DISTRICT RA30 USE SFD

#BEDROOMS 4

12 Jul 16  
ZONING ADMINISTRATOR

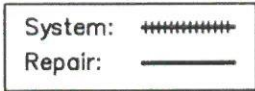

- \*Keep Tanks and Drain lines 10' from property lines.
- \*Not a Survey
- \*Not a guarantee of a septic permit.
- \*Keep supply lines >5' from property lines.
- \*Some lines are flagged longer in the field than lengths indicated above.
- \*No foundation drains.

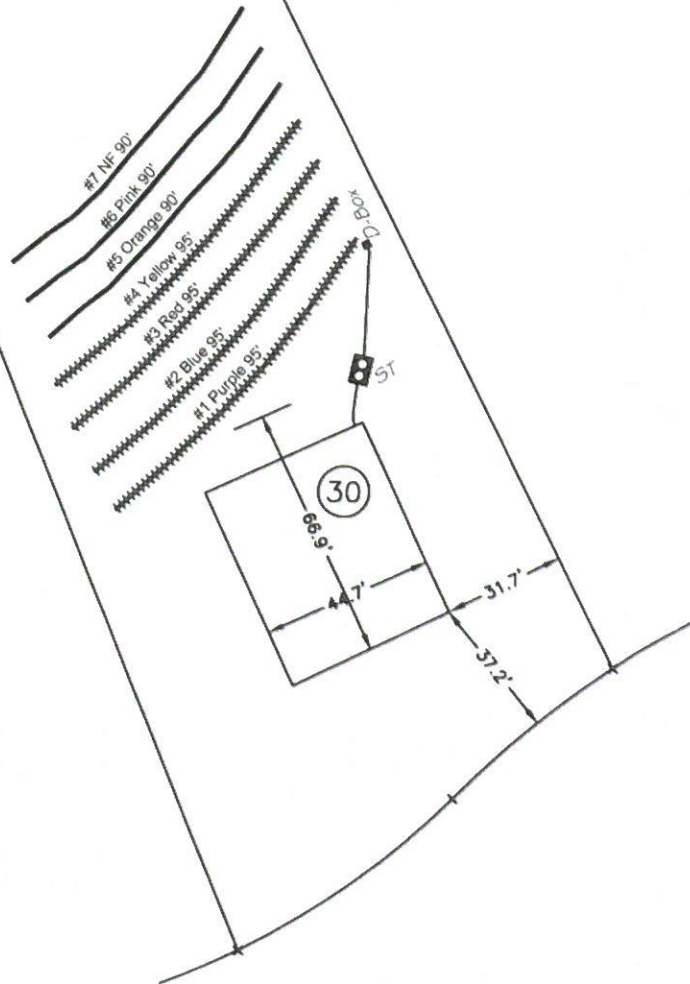

System: Gravity to D-Box  
Lines: 1-4, (380')  
0.35 Soil LTAR  
24" Trench Bottom  
Accepted Status System

---

Repair: T & J panel  
Lines: 5-7, (270')  
0.35 Soil LTAR  
36" Trench Bottom  
Accepted Status System

GRAPHIC SCALE  
1" = 50'



Central Carolina  
Soil Consulting  
919-569-6704  
Project # 1953

