

Initial Application Date: 5-15-17
6.10.17

Application # 1750041382 R
CU# _____

CENTRAL PERMITTING 108 E. FRONT STREET, LILLINGTON, NC 27546 Phone: (910) 893-7525 ext:2 Fax: (910) 893-2793 www.harnett.org/permits

COUNTY OF HARNETT RESIDENTIAL LAND USE APPLICATION

"A RECORDED SURVEY MAP, RECORDED DEED (OR OFFER TO PURCHASE) & SITE PLAN ARE REQUIRED WHEN SUBMITTING A LAND USE APPLICATION"

LANDOWNER: John & Tammy Drew Woerner Mailing Address: 145 Huntington Dr
City: Dunn State: NC Zip: 28334 Contact No: 910 897-5133 Email: Dwoerner@embarcmail.com

APPLICANT: Cool Pools NC LLC Mailing Address: 2300 Old US 1 Hwy
City: Apex State: NC Zip: 27502 Contact No: 919 367 7277 Email: cher@coolpoolsnc.com

CONTACT NAME APPLYING IN OFFICE: Cher Levent Phone # 919 367-7277

PROPERTY LOCATION: Subdivision: Huntington Lot #: 8 Lot Size: 1.21

State Road # 145 State Road Name: Huntington Dr Map Book & Page: - 1 -

Parcel: 071519 0042 02 PIN: 1508-87-0378.000

Zoning: RA-30 Flood Zone: X Watershed: - Deed Book & Page: 3054,192 Power Company*: _____

*New structures with Progress Energy as service provider need to supply premise number _____ from Progress Energy.

PROPOSED USE:

- SFD: (Size _____ x _____) # Bedrooms: _____ # Baths: _____ Basement(w/wo bath): _____ Garage: _____ Deck: _____ Crawl Space: _____ Slab: _____ Slab: _____
(Is the bonus room finished? () yes () no w/ a closet? () yes () no (if yes add in with # bedrooms))
- Mod: (Size _____ x _____) # Bedrooms _____ # Baths _____ Basement (w/wo bath) _____ Garage: _____ Site Built Deck: _____ On Frame _____ Off Frame _____
(Is the second floor finished? () yes () no Any other site built additions? () yes () no
- Manufactured Home: _____ SW _____ DW _____ TW (Size _____ x _____) # Bedrooms: _____ Garage: _____ (site built? _____) Deck: _____ (site built? _____)
- Duplex: (Size _____ x _____) No. Buildings: _____ No. Bedrooms Per Unit: _____
- Home Occupation: # Rooms: _____ Use: _____ Hours of Operation: _____ #Employees: _____
- Addition/Accessory/Other: (Size 16x38) Use: Inground Pool Closets in addition? () yes () no

Water Supply: _____ County Existing Well _____ New Well (# of dwellings using well _____) *Must have operable water before final

Sewage Supply: _____ New Septic Tank (Complete Checklist) Existing Septic Tank (Complete Checklist) _____ County Sewer

Does owner of this tract of land, own land that contains a manufactured home within five hundred feet (500') of tract listed above? () yes () no

Does the property contain any easements whether underground or overhead () yes () no

Structures (existing or proposed): Single family dwellings: 1 Manufactured Homes: _____ Other (specify): 1 proposed inground pool

Required Residential Property Line Setbacks:

	Minimum	Actual
Front	<u>35</u>	_____
Rear	<u>10</u>	<u>78</u>
Closest Side	<u>10</u>	<u>45</u>
Sidestreet/corner lot	<u>20</u>	_____
Nearest Building on same lot	<u>10</u>	<u>50</u>

Comments: Existing install inground fiberglass pool 16x38

NO ENR REVISION CHARGE.
J. Blankart said they will have to move pool.

SPECIFIC DIRECTIONS TO THE PROPERTY FROM LILLINGTON:

S. 1st St L. E. Harnett St R. S. Main St
R. US 421 S. L. Red Hill Church Rd L. Huntington Dr

If permits are granted I agree to conform to all ordinances and laws of the State of North Carolina regulating such work and the specifications of plans submitted. I hereby state that foregoing statements are accurate and correct to the best of my knowledge. Permit subject to revocation if false information is provided.

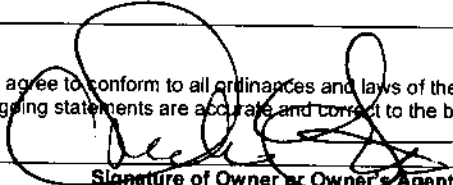
Signature of Owner or Owner's Agent

May 15, 2017
Date

It is the owner/applicants responsibility to provide the county with any applicable information about the subject property, including but not limited to: boundary information, house location, underground or overhead easements, etc. The county or its employees are not responsible for any incorrect or missing information that is contained within these applications.

This application expires 6 months from the initial date if permits have not been issued

Application # 1750041382

Drew & Tammy Woerner
145 Huntington Dr.
Dunn, NC 28334



Revised Site Plan
June 15th

40
Scale

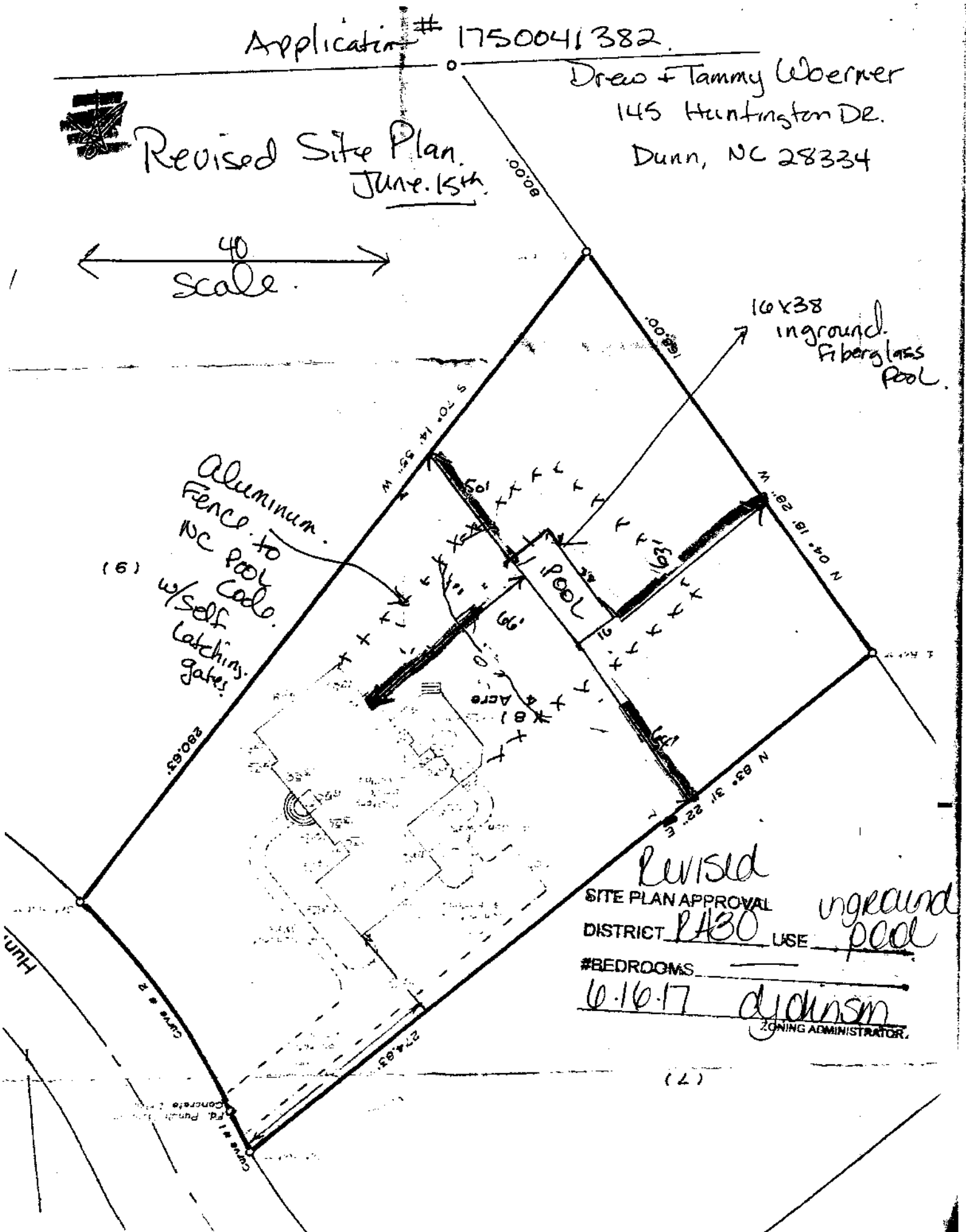

Aluminum Fence to NC Pool Code w/ self latching gates (6)

10x38 inground fiberglass pool

Revised
 SITE PLAN APPROVAL
 DISTRICT R430 USE inground pool
 #BEDROOMS 6-16-17
dj dunsen
 ZONING ADMINISTRATOR

(7)