

Improvement Permit

Boneta + John Richie A building permit cannot be issued with only an Improvement Permit

ISSUED TO: JASON PIERCE PROPERTY LOCATION: 541707 Neighbors Rd
 SUBDIVISION _____ LOT # _____
 NEW REPAIR EXPANSION
 Type of Structure: Ex SFD + New Pool Site Improvements required prior to Construction Authorization Issuance: _____
 Proposed Wastewater System Type: 25% RBS/DRUM
 Projected Daily Flow: 360 GPD
 Number of bedrooms: 3 Number of Occupants: 6 max
 Basement Yes No
 Pump Required: Yes No May be required based on final location and elevations of facilities
 Type of Water Supply: Community Public Well Distance from well _____ feet Permit valid for: Five years
 Permit conditions: _____ No expiration

Authorized State Agent: James E. Markhart Date: 9-21-15 SEE ATTACHED SITE SKETCH
 The issuance of this permit by the Health Department in no way guarantees the issuance of other permits. The permit holder is responsible for checking with appropriate governing bodies in meeting their requirements. This site is subject to revocation if the site plan, plat, or the intended use changes. The Improvement Permit shall not be affected by a change in ownership of the site. This permit is subject to compliance with the provisions of the Laws and Rules for Sewage Treatment and Disposal and to conditions of this permit.

Construction Authorization

(Required for Building Permit)

The construction and installation requirements of Rules .1950, .1952, .1954, .1955, .1956, .1957, .1958, and .1959 are incorporated by references into this permit and shall be met. Systems shall be installed in accordance with the attached system layout.

ISSUED TO: Boneta + John Richie PROPERTY LOCATION: 541707 Neighbors Rd
JASON PIERCE SUBDIVISION _____ LOT # _____
 Facility Type: Ex SFD + New Pool New Expansion Repair
 Basement? Yes No Basement Fixtures? Yes No
 Type of Wastewater System** 25% RBS/DRUM System (Initial) Wastewater Flow: 360 GPD
 (See note below, if applicable)
25% RBS/DRUM System (Repair)

Installation Requirements/Conditions

Septic Tank Size 1000 New gallons Number of trenches 4
 Pump Tank Size _____ gallons Exact length of each trench 80 feet Trench Spacing: 9 Feet on Center
 Trenches shall be installed on contour at a Soil Cover: 4 inches
 Maximum Trench Depth of: 24 inches (Maximum soil cover shall not exceed 36" above the trench bottom)
 (Trench bottoms shall be level to +/-1/4" in all directions)
 Pump Requirements: _____ ft. TDH vs. _____ GPM Aggregate Depth: 6 inches below pipe
Replace existing system to accommodate 2 inches above pipe
NEW Pool + Pool House 12 inches total

**WATER LINES (INCLUDING IRRIGATION) MUST BE 10FT. FROM ANY PART OF SEPTIC SYSTEM OR REPAIR AREA.
NO UTILITIES ALLOWED IN INITIAL OR REPAIR DRAIN FIELD AREA.**

**If applicable: I understand the system type specified is different from the type specified on the application. I accept the specifications of this permit.

Owner/Legal Representative Signature: _____ Date: _____

This Construction Authorization is subject to revocation if the site plan, plat, or the intended use changes. The Construction Authorization shall not be transferred when there is a change in ownership of the site. This Construction Authorization is subject to compliance with the provisions of the Laws and Rules for Sewage Treatment and Disposal and to the conditions of this permit. SEE ATTACHED SITE SKETCH

Authorized State Agent: James E. Markhart Date: 9-21-15
 Construction Authorization Expiration Date: 9-21-20

HTE# 15-5-36832R

Permit # 28500

Harnett County Department of Public Health Site Sketch

ISSUED TO: BONITA + JOHN RICHIE PROPERTY LOCATOR: SU 707 NEIGHBORS RD
JASON PEARCE SUBDIVISION _____ LOT # _____

Authorized State Agent: James E. Markant Date: 9-21-15

* Keep Existing TANK TO RUN INTO NEW TANK

* DRAIN LINES TO BE 15' OFF OF SWIMMING POOL.

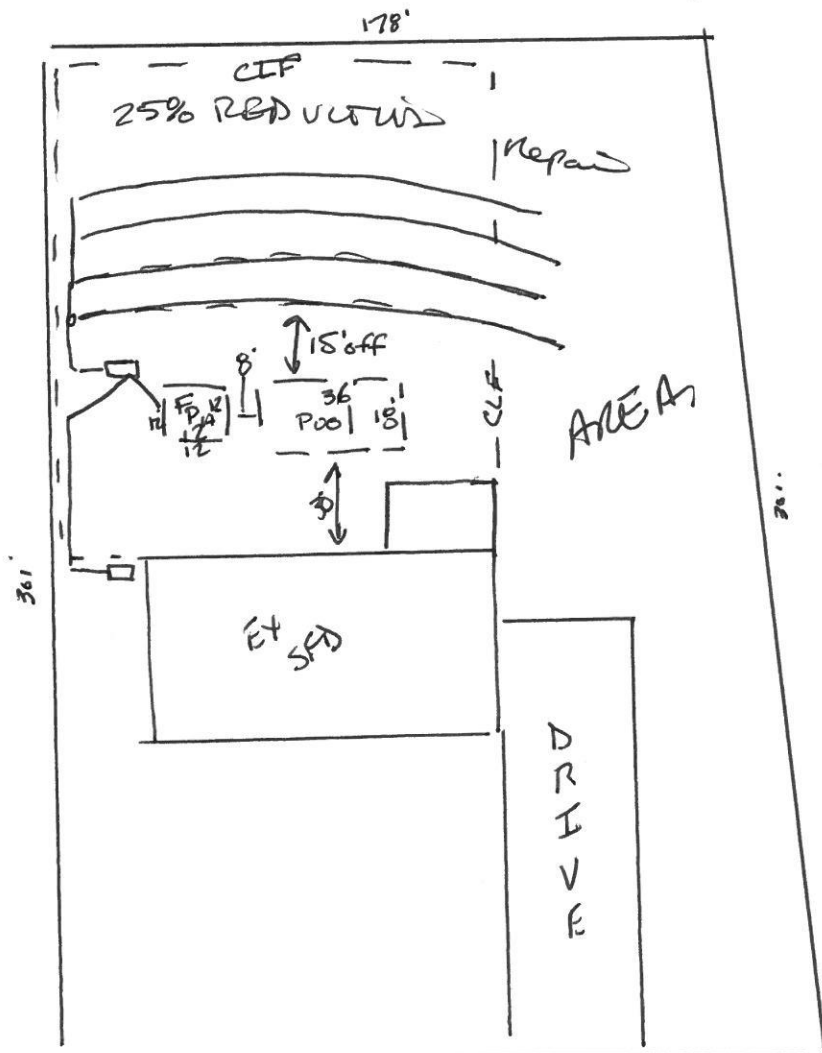

SR 1707 NEIGHBORS RD

