

Initial Application Date: 6-27-14

Application # 145034062

CU# _____

COUNTY OF HARNETT RESIDENTIAL LAND USE APPLICATION

Central Permitting 108 E. Front Street, Lillington, NC 27546 Phone: (910) 893-7525 ext:2 Fax: (910) 893-2793 www.harnett.org/permits

****A RECORDED SURVEY MAP, RECORDED DEED (OR OFFER TO PURCHASE) & SITE PLAN ARE REQUIRED WHEN SUBMITTING A LAND USE APPLICATION****

LANDOWNER: Michael Junio Mailing Address: 127 Wetherby Court

City: Angier State: NC Zip: 27501 Contact No: 240 6769533 Email: Michael Junio
Michael.C.Junio@hotmail.com

APPLICANT*: _____ Mailing Address: _____

City: _____ State: _____ Zip: _____ Contact No: _____ Email: _____

*Please fill out applicant information if different than landowner

CONTACT NAME APPLYING IN OFFICE: _____ Phone # _____

PROPERTY LOCATION: Subdivision: _____ Lot #: 23 Lot Size: _____

State Road # _____ State Road Name: _____ Map Book & Page: 615

Parcel: 07 0691 0023 22 PIN: 0691 58 3214.000

Zoning: RA30 Flood Zone: X Watershed: NA Deed Book & Page: 3115, 394 Power Company*: _____

*New structures with Progress Energy as service provider need to supply premise number _____ from Progress Energy.

PROPOSED USE:

SFD: (Size _____ x _____) # Bedrooms: _____ # Baths: _____ Basement(w/wo bath): _____ Garage: _____ Deck: _____ Crawl Space: _____ Slab: _____ Slab: _____
(Is the bonus room finished? () yes () no w/ a closet? () yes () no (if yes add in with # bedrooms)

Mod: (Size _____ x _____) # Bedrooms _____ # Baths _____ Basement (w/wo bath) _____ Garage: _____ Site Built Deck: _____ On Frame _____ Off Frame _____
(Is the second floor finished? () yes () no Any other site built additions? () yes () no

Manufactured Home: _____ SW _____ DW _____ TW (Size _____ x _____) # Bedrooms: _____ Garage: _____ (site built?) Deck: _____ (site built?)

Duplex: (Size _____ x _____) No. Buildings: _____ No. Bedrooms Per Unit: _____

Home Occupation: # Rooms: _____ Use: _____ Hours of Operation: _____ #Employees: _____

Addition/Accessory/Other: (Size _____ x _____) Use: 24 Ft Above Ground Pool Closets in addition? () yes () no

Water Supply: X County _____ Existing Well _____ New Well (# of dwellings using well _____) *Must have operable water before final

Sewage Supply: _____ New Septic Tank (Complete Checklist) X Existing Septic Tank (Complete Checklist) _____ County Sewer

Does owner of this tract of land, own land that contains a manufactured home within five hundred feet (500') of tract listed above? () yes X no

Does the property contain any easements whether underground or overhead X yes () no

Structures (existing or proposed): Single family dwellings: _____ Manufactured Homes: _____ Other (specify): _____

Required Residential Property Line Setbacks:

Comments: _____

Front Minimum _____ Actual _____

Rear _____

Closest Side _____

Sidestreet/corner lot _____

Nearest Building on same lot _____

SPECIFIC DIRECTIONS TO THE PROPERTY FROM LILLINGTON: _____

PASS CROSS ON 55, MAKE A RIGHT ON SILVER HAYES RD,
GO TO SECOND SUB DIVISION MAKE A RIGHT INTO SUBDIVISION
~~GO STR~~ MAKE A RIGHT AND GO STRAIGHT MIDWAY HOUSE

If permits are granted I agree to conform to all ordinances and laws of the State of North Carolina regulating such work and the specifications of plans submitted. I hereby state that foregoing statements are accurate and correct to the best of my knowledge. Permit subject to revocation if false information is provided.



Signature of Owner or Owner's Agent

27 Jun 19

Date

It is the owner/applicants responsibility to provide the county with any applicable information about the subject property, including but not limited to: boundary information, house location, underground or overhead easements, etc. The county or its employees are not responsible for any incorrect or missing information that is contained within these applications.

This application expires 6 months from the initial date if permits have not been issued

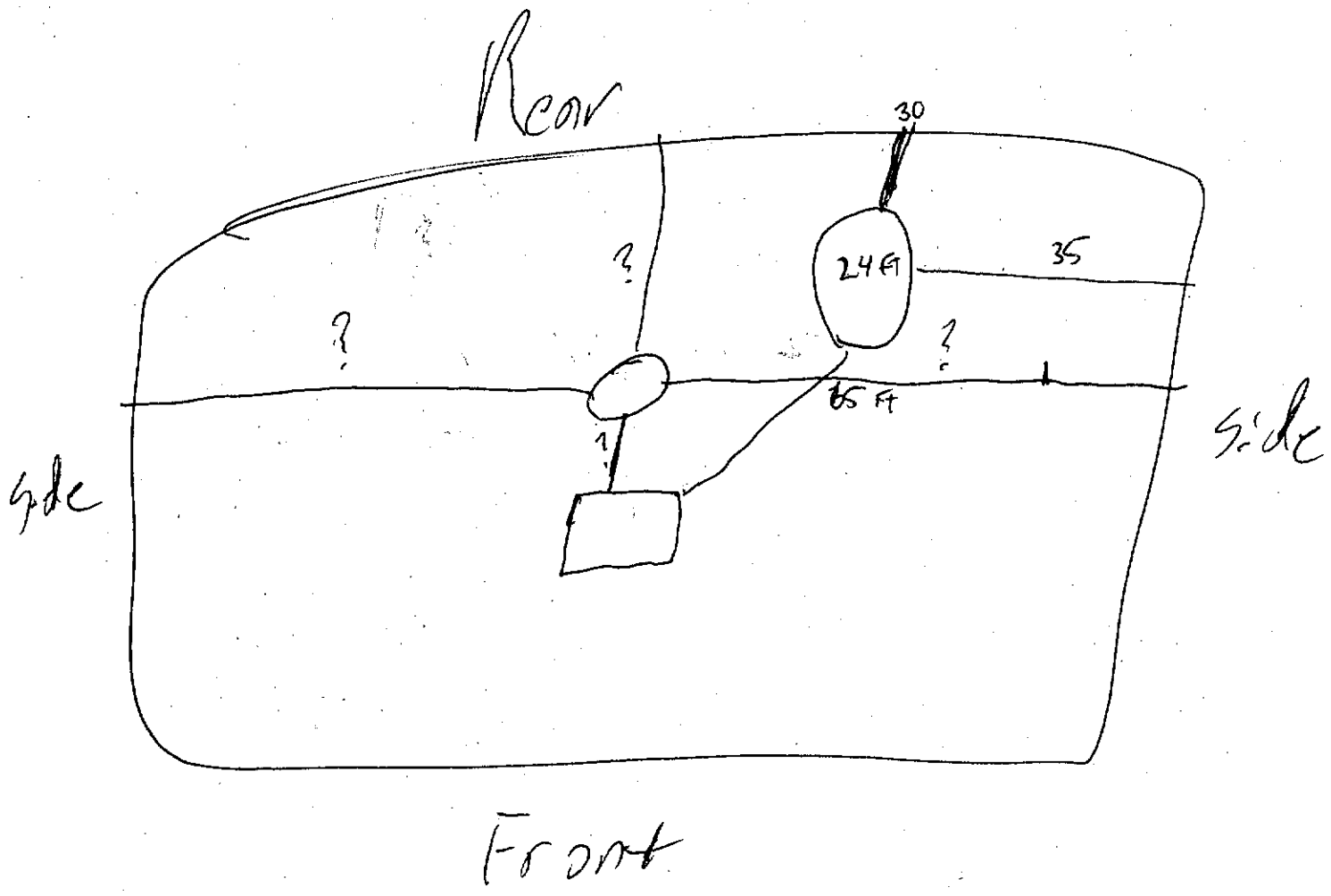

Handwritten scribbles and lines at the top of the page.

SITE PLAN APPROVAL

DISTRICT 1A3

USE

24 Ft Above Ground Pool

#BEDROOMS 0

6-27-14 V.C.M.
Zoning Administrator

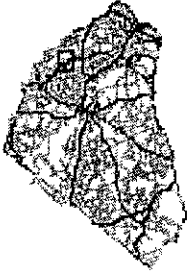

Address Points

Road Centerlines

Major Roads

Rivers

Parcels

County Boundary

Date

City Limits

Harnett_2013.sid

Red: Band_1

Green: Band_2

Blue: Band_3



HARNETT COUNTY, NORTH CAROLINA
GIS/LAND RECORDS

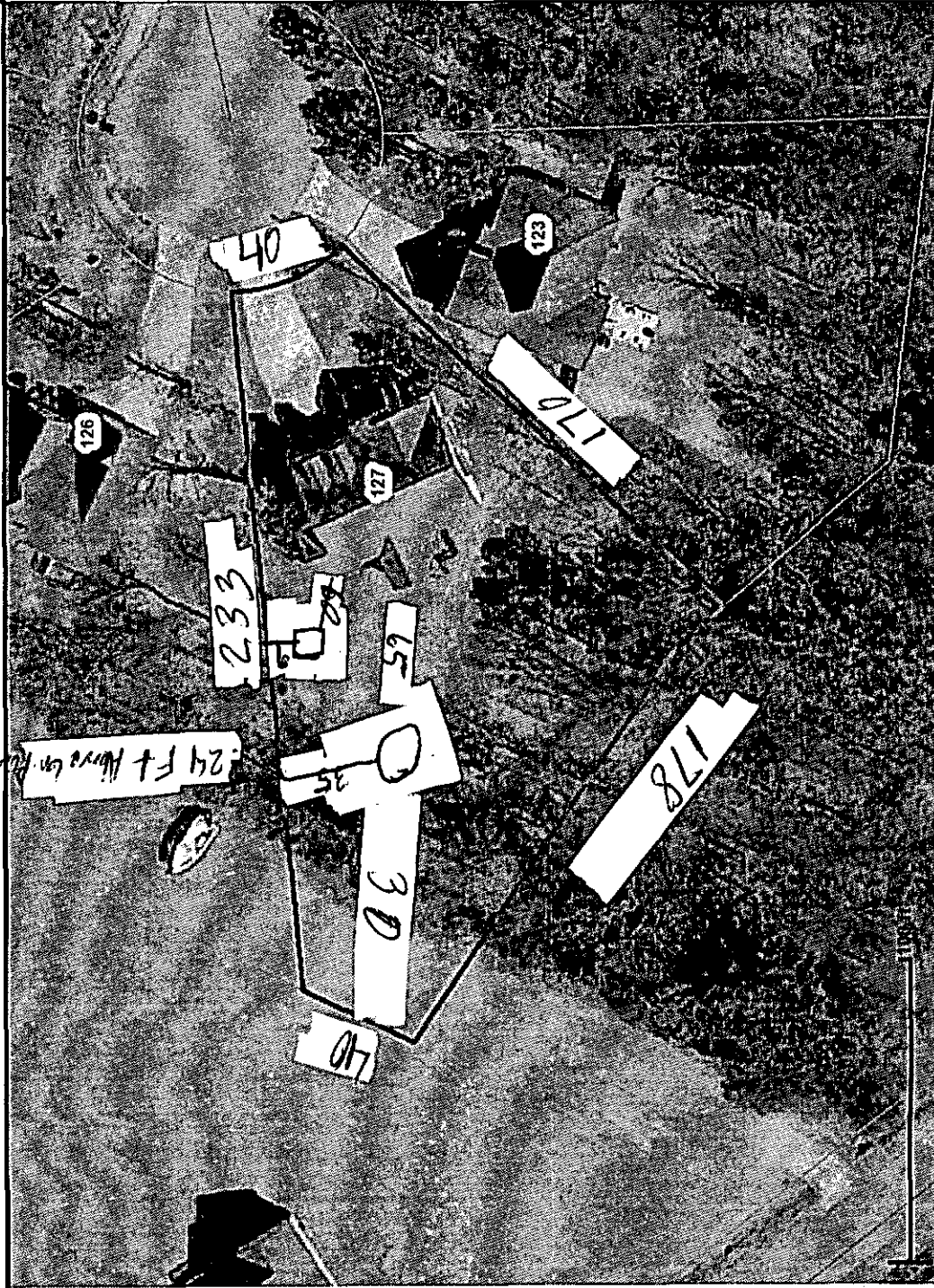

Any use of this map shall be at the sole risk of the user of this map. Although, all effort has been taken to insure accuracy in the data presented, Harnett County makes no warranty, expressed or implied, as to the accuracy of this information represented herein. Any user of this product shall hold harmless Harnett County, its elected officials, employees and agents from and against any claim, damage, loss, action, cause of action, or liability arising from the use of this GIS product.

Harnett County GIS
305 W. Cornelius Harnett Blvd, Suite 100
Lillington NC 27546
Phone: 910-893-7523 www.harnett.org

NAME: Michael Jumu

APPLICATION #: _____

This application to be filled out when applying for a septic system inspection.

County Health Department Application for Improvement Permit and/or Authorization to Construct

IF THE INFORMATION IN THIS APPLICATION IS FALSIFIED, CHANGED, OR THE SITE IS ALTERED, THEN THE IMPROVEMENT PERMIT OR AUTHORIZATION TO CONSTRUCT SHALL BECOME INVALID. The permit is valid for either 60 months or without expiration depending upon documentation submitted. (Complete site plan = 60 months; Complete plat = without expiration)

910-893-7525 option 1

CONFIRMATION # _____

Environmental Health New Septic System Code 800

- **All property irons must be made visible.** Place "pink property flags" on each corner iron of lot. All property lines must be clearly flagged approximately every 50 feet between corners.
- Place "orange house corner flags" at each corner of the proposed structure. Also flag driveways, garages, decks, out buildings, swimming pools, etc. Place flags per site plan developed at/for Central Permitting.
- Place orange Environmental Health card in location that is easily viewed from road to assist in locating property.
- If property is thickly wooded, Environmental Health requires that you clean out the **undergrowth** to allow the soil evaluation to be performed. Inspectors should be able to walk freely around site. **Do not grade property.**
- **All lots to be addressed within 10 business days after confirmation. \$25.00 return trip fee may be incurred for failure to uncover outlet lid, mark house corners and property lines, etc. once lot confirmed ready.**
- After preparing proposed site call the voice permitting system at 910-893-7525 option 1 to schedule and use code 800 (after selecting notification permit if multiple permits exist) for Environmental Health inspection. Please note confirmation number given at end of recording for proof of request.
- Use Click2Gov or IVR to verify results. Once approved, proceed to Central Permitting for permits.

Environmental Health Existing Tank Inspections Code 800

- Follow above instructions for placing flags and card on property.
- Prepare for inspection by removing soil over **outlet end** of tank as diagram indicates, and lift lid straight up (*if possible*) and then **put lid back in place.** (Unless inspection is for a septic tank in a mobile home park)
- **DO NOT LEAVE LIDS OFF OF SEPTIC TANK**
- After uncovering **outlet end** call the voice permitting system at 910-893-7525 option 1 & select notification permit if multiple permits, then use code 800 for Environmental Health inspection. Please note confirmation number given at end of recording for proof of request.
- Use Click2Gov or IVR to hear results. Once approved, proceed to Central Permitting for remaining permits.

SEPTIC

If applying for authorization to construct please indicate desired system type(s): can be ranked in order of preference, must choose one.

- Accepted Innovative Conventional Any
 Alternative Other _____

The applicant shall notify the local health department upon submittal of this application if any of the following apply to the property in question. If the answer is "yes", applicant **MUST ATTACH SUPPORTING DOCUMENTATION**:

- YES NO Does the site contain any Jurisdictional Wetlands?
 YES NO Do you plan to have an irrigation system now or in the future?
 YES NO Does or will the building contain any drains? Please explain. _____
 YES NO Are there any existing wells, springs, waterlines or Wastewater Systems on this property?
 YES NO Is any wastewater going to be generated on the site other than domestic sewage?
 YES NO Is the site subject to approval by any other Public Agency?
 YES NO Are there any Easements or Right of Ways on this property?
 YES NO Does the site contain any existing water, cable, phone or underground electric lines?

If yes please call No Cuts at 800-632-4949 to locate the lines. This is a free service.

I Have Read This Application And Certify That The Information Provided Herein Is True, Complete And Correct. Authorized County And State Officials Are Granted Right Of Entry To Conduct Necessary Inspections To Determine Compliance With Applicable Laws And Rules.

I Understand That I Am Solely Responsible For The Proper Identification And Labeling Of All Property Lines And Corners And Making The Site Accessible So That A Complete Site Evaluation Can Be Performed.

PROPERTY OWNERS OR OWNERS LEGAL REPRESENTATIVE SIGNATURE (REQUIRED)

27 JUN 14
DATE

127 Wetlands Pt

Application # _____

Harnett County Central Permitting

PO Box 65 Lillington, NC 27546 - Ph: 910-893-7525 - Fx: 910-893-2793 - www.harnett.org/permits

Certification of Work Performed By Owner/Contractor (Individual Trade Application)

Owner (s) of Structure: _____ Phone: _____

Owner (s) Mailing Address: _____

Land Owner Name (s): _____ Phone: _____

Construction or Site Address: _____

PIN # _____ Parcel # _____

Job Cost: _____ Description of Work to be done _____

Mechanical: New Unit With Ductwork ___ New Unit Without Ductwork ___ Gas Piping ___ Other ___

Electrical*: 200 Amp ___ <200 Amp ___ Service Change ___ Service Reconnect ___ Other ___

* For Progress Energy customers we need the premise number

Plumbing: Water/Sewer Tap ___ Number of Baths ___ Water Heater ___

Specific Directions to Job from Lillington:

Subdivision: _____ Lot #: _____

I OWNER will provide the EL labor on this structure.
(Contractors Name) (Trade)

I am the building owner or my NC state license number is _____, which entitles me to perform such work on the above structure legally. All work shall comply with the State Building Code and all other applicable State and local laws, ordinances and regulations.

Owner
Contractor's Company Name

Telephone

Address

Email Address

License # _____

Structure Owner / Contractor Signature: _____ Date: 27 July 14

By signing this application you affirm that you have obtained permission from the above listed license holder to purchase permits on their behalf. If doing the work as owner you understand that you cannot rent, lease or sell the listed property for 12 months after completion of the listed work.

***Company name, address, & phone must match information on license**

Selected Parcels Feature

PIN	0691-58-3214.000
[ParcelNumber]	070691 0023 22
REID	0066552
[AccountNumber]	1500008589
[Name1]	JUNIO MICHAEL C
[Name2]	JUNIO CARLA M WIFE
[Address1]	127 WEATHERBY COURT
[Address2]	
[Address3]	
[City]	ANGIER
[State]	NC
[ZipCode]	27501
[ParcelBuildingValue]	133540
[ParcelObxfValue]	
[ParcelLandValue]	30000
[TotalAssessedValue]	163540
[HouseNumber]	000127
[UnitNumber]	
[StreetDirection]	
[StreetName]	WEATHERBY
[StreetType]	CT
[StreetSuffix]	
[LegalLandUnits]	1
[LegalDescription]	LT#23 HUNTERS POINT S/D MP#2006-1128
[LegalLandType]	LT
GIS Calc Acres	0.54
PlatBook	2006
[PlatPage]	1128
[ActualYearBuilt]	2008
[TotalAcutalAreaHeated]	1527
[UseCode]	0100
[DeedBook]	03115
[DeedPage]	0394
[DeedDate]	2013-05-08
[SaleYear]	2013
[SalePrice]	153500
PRC	Click here for PRC070691 0023 22
Zoning	Click here for070691 0023 22
Soils Overlay	Click here for 070691 0023 22

HARNETT COUNTY CENTRAL PERMITTING
P.O. BOX 65
LILLINGTON, NC 27546
For Inspections Call: (910) 893-7525 Fax: (910) 893-2793
Bldg Insp scheduled before 2pm available next business day.

Application Number 14-50034062 Date 7/21/14
Property Address 127 WEATHERBY CT
PARCEL NUMBER 07-0691- - -0023- -22-
Application type description CP SWIMMING POOL
Subdivision Name HUNTERS POINT 45 LOTS
Property Zoning RES/AGRI DIST - RA-30

Owner Contractor

JUNIO MICHAEL C & CARLA M OWNER
127 WEATHEERLY CT
ANGIER NC 27501

Applicant

JUNIO MICHAEL C

--- Structure Information 000 000 24 FT ABOVE GRD POOL
Flood Zone FLOOD ZONE X
Other struct info PROPOSED USE ABOVE GRD POOL
SEPTIC - EXISTING? EXIST

Permit LAND USE PERMIT
Additional desc . . .
Phone Access Code . . . 1046184
Issue Date 7/21/14 Valuation 0
Expiration Date . . . 1/17/15

Permit RESIDENTIAL ELECTRICAL PERMIT
Additional desc . . . POOL
Phone Access Code . . . 1046176
Issue Date 7/21/14 Valuation 0
Expiration Date . . . 7/21/15

Special Notes and Comments

T/S: 06/30/2014 10:33 AM VBROWN ----
127 WEATHERBY COURT ANGIER 27501
HUNTERS POINT SUB DIV #23

HARNETT COUNTY CENTRAL PERMITTING
P.O. BOX 65
LILLINGTON, NC 27546
For Inspections Call: (910) 893-7525 Fax: (910) 893-2793
Bldg Insp scheduled before 2pm available next business day.

Application Number	14-50034062	Page	2
Property Address	127 WEATHERBY CT	Date	7/21/14
PARCEL NUMBER	07-0691- - -0023- -22-		
Application description	CP SWIMMING POOL		
Subdivision Name	HUNTERS POINT 45 LOTS		
Property Zoning	RES/AGRI DIST - RA-30		

Required Inspections

Seq	Phone Insp#	Insp Code	Description	Initials	Date
Permit type LAND USE PERMIT					
999	818	Z818	PZ*ZONING INSPECTION	_____	___/___/___
999	820	Z820	PZ*ZONING/FINAL INSPECTION	_____	___/___/___
Permit type RESIDENTIAL ELECTRICAL PERMIT					
999	211	E211	R*ELEC ABOVE CEILING	_____	___/___/___
999	217	E217	R*ELEC RECONNECT	_____	___/___/___
999	205	E205	R*ELEC UNDER SLAB	_____	___/___/___
999	215	E215	R*ELEC. UND. POOL	_____	___/___/___
999	213	E213	R*ELECTRICAL UNDERGROUND	_____	___/___/___
999	131	R131	ONE TRADE FINAL	_____	___/___/___
999	125	R125	ONE TRADE ROUGH IN	_____	___/___/___