

HTE# 08-5-19667

Har t County Department of Public Health

20029

PERMIT # 24618

Operation Permit

New Installation Septic Tank Repair Nitrification Line Expansion

PROPERTY LOCATION: 561412 Christian Light

Name: (owner) Matt Vaughn

SUBDIVISION MEIS MEADOW

LOT # 45

System Installer: JASON MATTHEWS

Registration # _____

Basement with plumbing: Garage Number of Bedrooms 3

Type of Water Supply: Community Public Well Distance from well _____ feet

System Type: 25% REDUCTION System Type III G Types V and VI Systems expire in 5 years.

(In accordance with Table V a)

Owner must contact Health Department 6 months prior to expiration for permit renewal.

This system has been installed in compliance with applicable North Carolina General Statutes, Rules for Sewage Treatment and Disposal, and all conditions of the Improvement Permit and Construction Authorization.

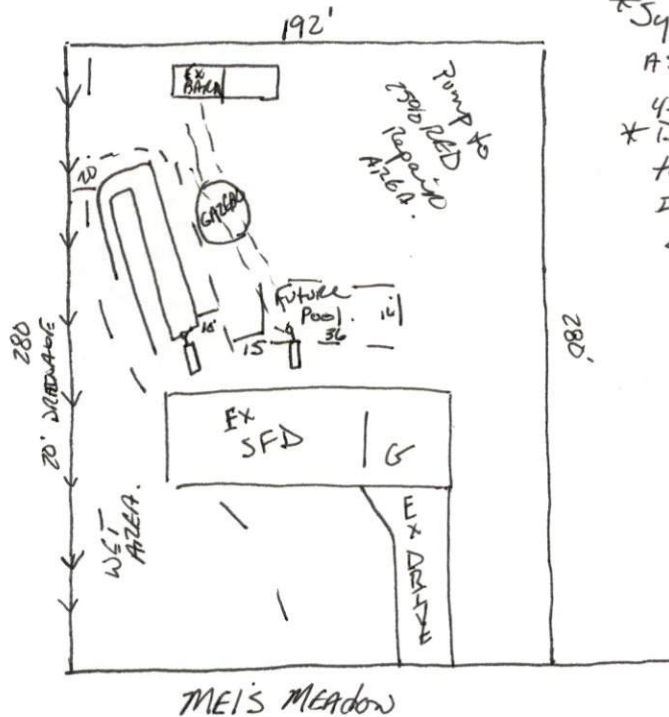

*System INSTALLED AS SPECIFIED!
 4-25-08
 *DIRECTED BY (BMEJWASH) TO ALLOW DISCARD OF TANK IN LANDFILL.
 5-2-08 - DIRECTED BY C BYRD TO ALLOW CHITTING TO DUMP TANK IN LANDFILL.

PERMIT CONDITIONS:

- I. Performance: System shall perform in accordance with Rule .1961.
- II. Monitoring: As required by Rule .1961.
- III. Maintenance: As required by Rule .1961. Other: _____
 Subsurface system operator required? Yes No
 If yes, see attached sheet for additional operation conditions, maintenance and reporting.
- IV. Operation: _____
- V. Other: _____

Following are the specifications for the sewage disposal system on the above captioned property.

Type of system: Conventional Other 25% REDUCTION System Type III Septic Tank: 1000 gallons Pump Tank: _____ gallons
 Subsurface No. of exact length width of depth of
 Drainage Field ditches 2 of each ditch 100 feet ditches 3 feet ditches 18 inches
 French Drain Required: _____ Linear feet

Authorized State Agent James E. Manhart

Date 4-25-08

5-2-08