

MUST meet onsite
MAY Be able to use
Gravel

IMPROVEMENT PERMIT

Be it ordained by the Harnett County Board of Health as follows: Section III, Item B. "No Person shall begin construction of any building at which a septic tank system is to be used for disposal of sewage without first obtaining a written permit from the Harnett County Health Department."

Name: (owner) Daugherty New Installation Septic Tank
Property Location: SR# NC 87 Repairs Nitrification Line
150 Morgan CT
Subdivision North Ridge Lot # 50

Tax ID # _____ Quadrant # _____
Number of Bedrooms Proposed: Existing Lot Size: 100 x 150 x 100 x 150

Basement with Plumbing: Garage: #1 Re Route under ground power AS shown
Water Supply: Well Public Community #2 Install new septic system
Distance From Well: 50 ft. #3 Install Pool

Following is the minimum specifications for sewage disposal system on above captioned property. Subject to final approval.

Type of system: Conventional Other Chamber SYSTEM
Size of tank: Septic Tank: Existing gallons Pump Tank: _____ gallons
Subsurface Drainage Field No. of ditches 1 exact length of each ditch 130 ft. width of ditches 3 ft. depth of ditches 30 3/8 in.
French Drain Required: _____ Linear feet

Date: 6-19-01
Signed: Jon Waters
Environmental Health Specialist

This permit is subject to revocation if site plans or intended use change.

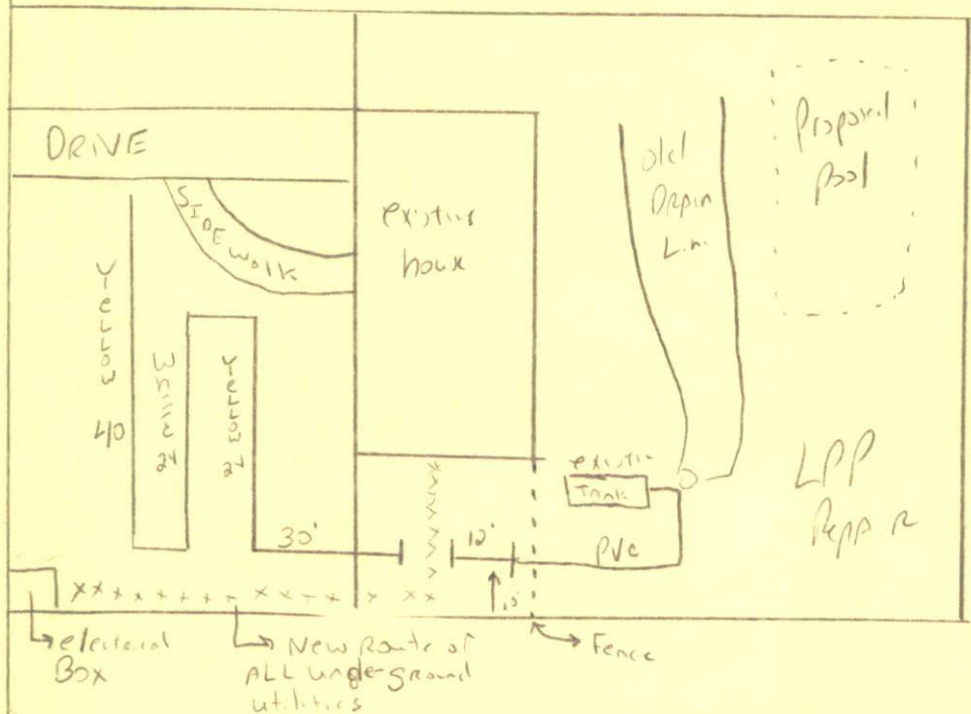

MUST meet onsite
Before Installing
Septic system -
MAY be able to change
to 150' of gravel system
START Lines 5' from
Fence - START Line
Deep enough so that
1st STEP down will be
needed where underground
utilities cross - 3' of
Solid PVC Pipe then
START Lines. Deep enough
so that no STEP down
is needed until the TURN
at the sidewalk.

MUST Place Filter in Tank
MAY INSTALL 150' of gravel INSTEAD of
Chamber