

Initial Application Date: 3/29/2018

Application # 18-50042812  
CU# \_\_\_\_\_

**COUNTY OF HARNETT RESIDENTIAL LAND USE APPLICATION**  
Central Permitting 108 E. Front Street, Lillington, NC 27546 Phone: (910) 893-7525 ext:2 Fax: (910) 893-2793 www.harnett.org/permits

**\*\*A RECORDED SURVEY MAP, RECORDED DEED (OR OFFER TO PURCHASE) & SITE PLAN ARE REQUIRED WHEN SUBMITTING A LAND USE APPLICATION\*\***

LANDOWNER: Triangle Home Pros Mailing Address: 6312 Lauracq LN  
City: Fuquay Varina State: NC Zip: 27526 Contact No: 919-346-1528 Email: THPHomes@bmail.com

APPLICANT\*: \_\_\_\_\_ Mailing Address: \_\_\_\_\_  
City: \_\_\_\_\_ State: \_\_\_\_\_ Zip: \_\_\_\_\_ Contact No: \_\_\_\_\_ Email: \_\_\_\_\_  
\*Please fill out applicant information if different than landowner

CONTACT NAME APPLYING IN OFFICE: Jeff Culver Phone # 919-896-2280

PROPERTY LOCATION: Subdivision: Cokesbury Park Lot #: 34 Lot Size: .35  
State Road # 852 State Road Name: Cokesbury Park LN Map Book & Page: 2004/1072  
Parcel: \_\_\_\_\_ PIN: 0635-58-7657

Zoning: RA20M Flood Zone: NO Watershed: \_\_\_\_\_ Deed Book & Page: 3497/0653 Power Company\*: Duke  
\*New structures with Progress Energy as service provider need to supply premise number \_\_\_\_\_ from Progress Energy.

**PROPOSED USE:**

- SFD: (Size 38 x 42) # Bedrooms: 3 # Baths: 2 1/2 Basement (w/wo bath): \_\_\_\_\_ Garage:  Deck:  Crawl Space:  Slab: \_\_\_\_\_ Monolithic Slab: \_\_\_\_\_  
(Is the bonus room finished? ( ) yes (X) no w/ a closet? ( ) yes ( ) no (If yes add in with # bedrooms))
- Mod: (Size \_\_\_\_\_ x \_\_\_\_\_) # Bedrooms \_\_\_\_\_ # Baths \_\_\_\_\_ Basement (w/wo bath) \_\_\_\_\_ Garage: \_\_\_\_\_ Site Built Deck: \_\_\_\_\_ On Frame \_\_\_\_\_ Off Frame \_\_\_\_\_  
(Is the second floor finished? ( ) yes ( ) no Any other site built additions? ( ) yes ( ) no
- Manufactured Home: \_\_\_\_\_ SW \_\_\_\_\_ DW \_\_\_\_\_ TW (Size \_\_\_\_\_ x \_\_\_\_\_) # Bedrooms: \_\_\_\_\_ Garage: \_\_\_\_\_ (site built? \_\_\_\_\_) Deck: \_\_\_\_\_ (site built? \_\_\_\_\_)
- Duplex: (Size \_\_\_\_\_ x \_\_\_\_\_) No. Buildings: \_\_\_\_\_ No. Bedrooms Per Unit: \_\_\_\_\_
- Home Occupation: # Rooms: \_\_\_\_\_ Use: \_\_\_\_\_ Hours of Operation: \_\_\_\_\_ #Employees: \_\_\_\_\_
- Addition/Accessory/Other: (Size \_\_\_\_\_ x \_\_\_\_\_) Use: \_\_\_\_\_ Closets in addition? ( ) yes ( ) no

Water Supply:  County \_\_\_\_\_ Existing Well \_\_\_\_\_ New Well (# of dwellings using well \_\_\_\_\_) \*Must have operable water before final

Sewage Supply:  New Septic Tank (Complete Checklist) \_\_\_\_\_ Existing Septic Tank (Complete Checklist) \_\_\_\_\_ County Sewer

Does owner of this tract of land, own land that contains a manufactured home within five hundred feet (500') of tract listed above? ( ) yes (X) no

Does the property contain any easements whether underground or overhead (X) yes ( ) no

Structures (existing or proposed): Single family dwellings: new Manufactured Homes: \_\_\_\_\_ Other (specify): \_\_\_\_\_

**Required Residential Property Line Setbacks:**

Front	Minimum	<u>35</u>	Actual	<u>39</u>
Rear		<u>25</u>		<u>100</u>
Closest Side		<u>10</u>		<u>15</u>
Sidestreet/corner lot		<u>NA</u>		<u>NA</u>
Nearest Building on same lot				

Comments: see soil scientist layout & data

SPECIFIC DIRECTIONS TO THE PROPERTY FROM LILLINGTON: 401 N to Christian Light - L - To  
Cokesbury R.d - L - To Cokesbury Park - L - To Address  
852 -

If permits are granted I agree to conform to all ordinances and laws of the State of North Carolina regulating such work and the specifications of plans submitted. I hereby state that foregoing statements are accurate and correct to the best of my knowledge. Permit subject to revocation if false information is provided.

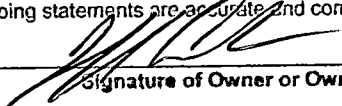
  
\_\_\_\_\_  
Signature of Owner or Owner's Agent

3/29/2018  
Date

\*\*\*It is the owner/applicants responsibility to provide the county with any applicable information about the subject property, including but not limited to: boundary information, house location, underground or overhead easements, etc. The county or its employees are not responsible for any incorrect or missing information that is contained within these applications.\*\*\*

\*\*This application expires 6 months from the initial date if permits have not been issued\*\*

# Triangle Home Pros, LLC Lot# 34 Cokesbury Park 3-Bedroom Layout

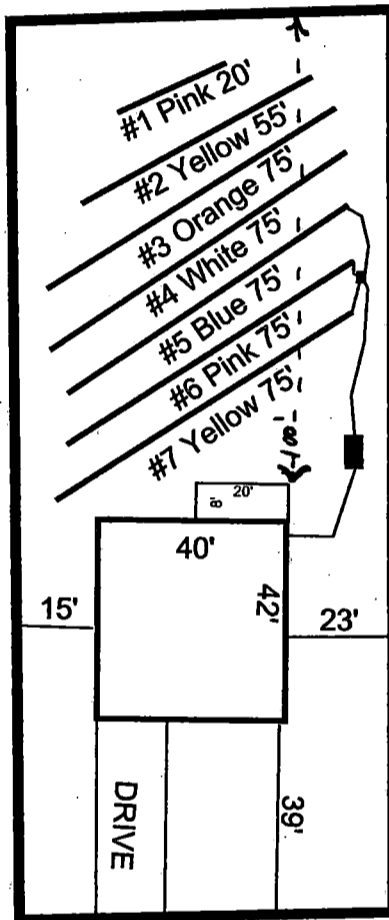

Cokesbury Park Lane

SITE PLAN APPROVAL

DISTRICT PA-20M USE SFD  
 #BEDROOMS 3BD 2.5 BA  
4/16/18 **(BP)**  
 ADMINISTRATOR

System: Gravity to D-Box  
 Lines: 5-7, (225')  
 0.4 LTAR  
 18" Trench Bottom  
 Accepted Status System  
 Repair: Pump to Serial Distribution  
 Lines: 1-4, (225')  
 0.4 LTAR  
 18" Trench Bottom  
 Accepted Status System

\*If plumbing is not sufficient a pump may be required to dose the septic field.

GRAPHIC SCALE *Not to scale*  
 1" = 40'



Adams  
 Soil Consulting  
 919-414-6761  
 Job #468

NAME: Triangle Home Pros

APPLICATION #: 18-50043812

**\*This application to be filled out when applying for a septic system inspection.\***

**County Health Department Application for Improvement Permit and/or Authorization to Construct**

IF THE INFORMATION IN THIS APPLICATION IS FALSIFIED, CHANGED, OR THE SITE IS ALTERED, THEN THE IMPROVEMENT PERMIT OR AUTHORIZATION TO CONSTRUCT SHALL BECOME INVALID. The permit is valid for either 60 months or without expiration depending upon documentation submitted. (Complete site plan = 60 months; Complete plat = without expiration)

910-893-7525 option 1

CONFIRMATION # (B2) 4/16/18 027269

**Environmental Health New Septic System Code 800**

- **All property irons must be made visible.** Place "pink property flags" on each corner iron of lot. All property lines must be clearly flagged approximately every 50 feet between corners.
- Place "orange house corner flags" at each corner of the proposed structure. Also flag driveways, garages, decks, out buildings, swimming pools, etc. Place flags per site plan developed at/for Central Permitting.
- Place orange Environmental Health card in location that is easily viewed from road to assist in locating property.
- If property is thickly wooded, Environmental Health requires that you clean out the undergrowth to allow the soil evaluation to be performed. Inspectors should be able to walk freely around site. **Do not grade property.**
- **All lots to be addressed within 10 business days after confirmation. \$25.00 return trip fee may be incurred for failure to uncover outlet lid, mark house corners and property lines, etc. once lot confirmed ready.**
- After preparing proposed site call the voice permitting system at 910-893-7525 option 1 to schedule and use code 800 (after selecting notification permit if multiple permits exist) for Environmental Health inspection. Please note confirmation number given at end of recording for proof of request.
- Use Click2Gov or IVR to verify results. Once approved, proceed to Central Permitting for permits.

**Environmental Health Existing Tank Inspections Code 800**

- Follow above instructions for placing flags and card on property.
- Prepare for inspection by removing soil over **outlet end** of tank as diagram indicates, and lift lid straight up (*if possible*) and then **put lid back in place.** (Unless inspection is for a septic tank in a mobile home park)
- **DO NOT LEAVE LIDS OFF OF SEPTIC TANK**
- After uncovering **outlet end** call the voice permitting system at 910-893-7525 option 1 & select notification permit if multiple permits, then use code 800 for Environmental Health inspection. Please note confirmation number given at end of recording for proof of request.
- Use Click2Gov or IVR to hear results. Once approved, proceed to Central Permitting for remaining permits.

**SEPTIC**

If applying for authorization to construct please indicate desired system type(s): can be ranked in order of preference, must choose one.

- Accepted       Innovative       Conventional       Any  
 Alternative       Other \_\_\_\_\_

The applicant shall notify the local health department upon submittal of this application if any of the following apply to the property in question. If the answer is "yes", applicant **MUST ATTACH SUPPORTING DOCUMENTATION**:

- YES  NO Does the site contain any Jurisdictional Wetlands?  
 YES  NO Do you plan to have an irrigation system now or in the future?  
 YES  NO Does or will the building contain any drains? Please explain. \_\_\_\_\_  
 YES  NO Are there any existing wells, springs, waterlines or Wastewater Systems on this property?  
 YES  NO Is any wastewater going to be generated on the site other than domestic sewage?  
 YES  NO Is the site subject to approval by any other Public Agency?  
 YES  NO Are there any Easements or Right of Ways on this property?  
 YES  NO Does the site contain any existing water, cable, phone or underground electric lines?

If yes please call No Cuts at 800-632-4949 to locate the lines. This is a free service.

I Have Read This Application And Certify That The Information Provided Herein Is True, Complete And Correct. Authorized County And State Officials Are Granted Right Of Entry To Conduct Necessary Inspections To Determine Compliance With Applicable Laws And Rules.

I Understand That I Am Solely Responsible For The Proper Identification And Labeling Of All Property Lines And Corners And Making The Site Accessible So That A Complete Site Evaluation Can Be Performed.

\_\_\_\_\_  
PROPERTY OWNERS OR OWNERS LEGAL REPRESENTATIVE SIGNATURE (REQUIRED)

3/29/2018  
DATE

**Triangel Home Pros, LLC**  
**Lot #34 - Cokesbury Park**  
 3-Bedroom Home (360 gal./day)

<u>LINE #</u>	<u>COLOR</u>	<u>BS</u>	<u>HI</u>	<u>FS</u>	<u>ELEVATION</u>	<u>LINE LENGTH</u>	<u>Design Length</u>
TBM		2.0		100.0		<u>in field</u>	<u>installation</u>
INST. 1			102.0				
<i>1</i>	<i>Pink</i>			<i>0</i>	<i>102</i>	<i>20</i>	<i>20</i>
<i>2</i>	<i>Yellow</i>			<i>1.5</i>	<i>100.5</i>	<i>55</i>	<i>55</i>
<i>3</i>	<i>Orange</i>			<i>3</i>	<i>99</i>	<i>75</i>	<i>75</i>
<i>4</i>	White			3.8	98.2	85	75
<i>5</i>	Blue			4.5	97.5	75	75
<i>6</i>	Pink			5	97	75	75
<i>7</i>	Yellow			5.4	96.6	75	75

**System**

Lines 5-7

**System Type**

Accepted Status System  
EZ-FLOW

**Repair**

Lines 1-4

Accepted Status System  
EZ-FLOW

**Suggested Soil LARK**

0.40

0.40

**Total Line Length**

225

225

**Square Footage**

675

675

**Proposed Trench Bottom**

18"

18"

**Distribution Method**

Gravity to D-Box

Gravity to D-Box