

ADDRESS . . . : 61 PINTAIL DR SUBDIV: THOMAS MANOR 36LOTS  
CONTRACTOR : SIGNATURE HOME BUILDERS PHONE : (910) 892-9299  
OWNER . . . : DENNING BROTHERS PHONE :  
PARCEL . . . : 13-0630- - -0096- -36-  
APPL NUMBER: 18-50043710 CP NEW RESIDENTIAL (SFD)  
APPL NOTES : BPMN 4/03/18 SHAYLAHS KNOLL #34  
61 PINTAIL DR  
T/S: 05/07/2018 11:48 AM JBROCK ----  
PREMISE # 47045078

STRUCTURE: 000 000 55X50 3BDR 2BTH W/DECK CRWL

FLOOD ZONE . . . . . : FLOOD ZONE X  
# BATHS . . . . . : 2 # BEDROOMS . . . . . : 3.00  
PROPOSED USE . . . . . : SFD SEPTIC - EXISTING? . . . . . : NEW SEPTIC  
WATER SUPPLY . . . . . : COUNTY

PERMIT: CPSF 00 CP \* SFD

TYP/SQ	REQUESTED COMPLETED	INSP RESULT	DESCRIPTION RESULTS/COMMENTS
B101 01	4/27/18 4/27/18	TSG AP	R*BLDG FOOTING / TEMP SVC POLE VRU #: 003119187
A814 01	5/08/18 5/08/18	SB AP	ADDRESS CONFIRMATION TIME: 17:00 VRU #: 003124351 61 PINTAIL DR LILLINGTON 27546 T/S: 05/08/2018 10:32 AM SBENNETT -----
B103 01	5/08/18 5/08/18	TSG AP	R*BLDG FOUND & TEMP SVC POLE TIME: 17:00 VRU #: 003124369 T/S: 05/07/2018 11:49 AM JBROCK ----- CHECK T-POLE PLEASE
B105 01	5/11/18 5/11/18	TSG AP	R*OPEN FLOOR VRU #: 003126059
B104 01	6/13/18 6/13/18	LL AP	R*FOUND & SETBACK VERIF SURVEY TIME: 17:00 VRU #: 003139581 T/S: 06/13/2018 08:02 AM LLUCAS ----- T/S: 06/13/2018 08:02 AM LLUCAS -----
R425 01	6/14/18 6/14/18	TSG DA	FOUR TRADE ROUGH IN TIME: 17:00 VRU #: 003139599 T/S: 06/13/2018 08:03 AM LLUCAS ----- <del>WATER SUPPLY TEST DOWN. DRAIN TST DOWN 3-LADDER</del> FRAMING OVER STAIRS IS REQUIRED TO BE 2X6 @ 16 O/C <del>A02TRUSS HAS BEEN REPAIRED, COULD NOT LOCATE ENG REPAIR LETTER.</del>
R425 02	6/15/18	TI	OK TO SIDE DO NOT INSULATE FOUR TRADE ROUGH IN VRU #: 003140225

*Handwritten signature/initials: JL-DA*

COMMENTS AND NOTES

*Still need letter  
OK to insulate*

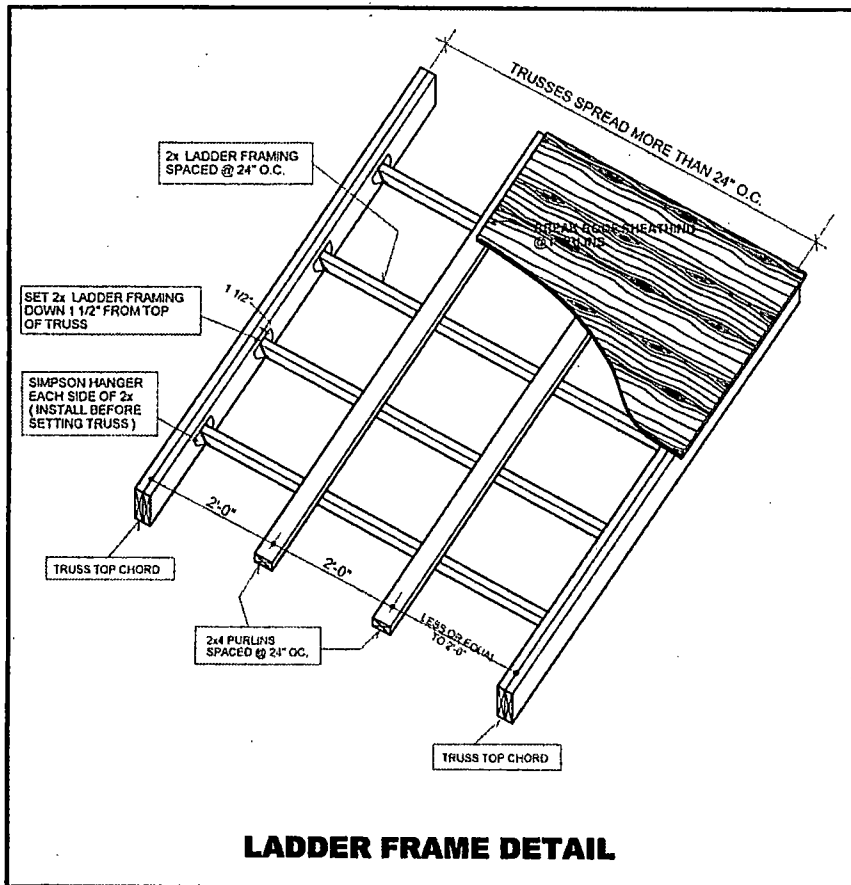

SIZE/GRADE	SPACING	2x4 SPF STUD
2x4 SPF STUD	24" O.C.	4'-6" CLEAR
2x4 SPF #2	24" O.C.	5'-0" CLEAR
2x6 SPF STUD	24" O.C.	7'-0" CLEAR
2x6 SPF #2	24" O.C.	8'-6" CLEAR
2x8 SPF #2	24" O.C.	11'-0" CLEAR
2x8 SYP #2	24" O.C.	12'-0" CLEAR