

Improvement Permit

A building permit cannot be issued with only an Improvement Permit

ISSUED TO: ONEAL, CAMMOTH & ELIZABETH
PROPERTY LOCATION: CLARK RD
SUBDIVISION: CURRAN PLANTATION LOT # 19
Type of Structure: SFD (60'x61')
Proposed Wastewater System Type: 25% REDUCTION SYSTEM
Projected Daily Flow: 600 GPD
Number of bedrooms: 5 Number of Occupants: 10 max
Basement: No
Pump Required: No
Type of Water Supply: Public
Permit valid for: Five years

Authorized State Agent: [Signature] Date: 4/9/18 SEE ATTACHED SITE SKETCH
The issuance of this permit by the Health Department in no way guarantees the issuance of other permits. The permit holder is responsible for checking with appropriate governing bodies in meeting their requirements. This site is subject to revocation if the site plan, plat, or the intended use changes. The Improvement Permit shall not be affected by a change in ownership of the site. This permit is subject to compliance with the provisions of the Laws and Rules for Sewage Treatment and Disposal and to conditions of this permit.

Construction Authorization

(Required for Building Permit)

The construction and installation requirements of Rules .1950, .1952, .1954, .1955, .1956, .1957, .1958, and .1959 are incorporated by references into this permit and shall be met. Systems shall be installed in accordance with the attached system layout.

ISSUED TO: ONEAL, CAMMOTH & ELIZABETH
PROPERTY LOCATION: CLARK RD
SUBDIVISION: CURRAN PLANTATION LOT # 19
Facility Type: SFD (60'x61')
Basement? No
Type of Wastewater System: 25% REDUCTION SYSTEM
(Initial) Wastewater Flow: 600 GPD
25% REDUCTION SYS (Repair)

Installation Requirements/Conditions
Septic Tank Size 1250 gallons
Pump Tank Size 1250 gallons (IF NEEDED)
Number of trenches 1
Exact length of each trench 300 feet
Trench Spacing: 9 Feet on Center
Soil Cover: 6 inches
Maximum Trench Depth of: 18 inches
Pump Requirements: ft. TDH vs. GPM
Aggregate Depth: inches below pipe, inches above pipe, inches total

WATER LINES (INCLUDING IRRIGATION) MUST BE 10FT. FROM ANY PART OF SEPTIC SYSTEM OR REPAIR AREA. NO UTILITIES ALLOWED IN INITIAL OR REPAIR DRAIN FIELD AREA.

**If applicable: I understand the system type specified is different from the type specified on the application. I accept the specifications of this permit.

Owner/Legal Representative Signature: Date:

This Construction Authorization is subject to revocation if the site plan, plat, or the intended use changes. The Construction Authorization shall not be transferred when there is a change in ownership of the site. This Construction Authorization is subject to compliance with the provisions of the Laws and Rules for Sewage Treatment and Disposal and to the conditions of this permit. SEE ATTACHED SITE SKETCH

Authorized State Agent: [Signature] Date: 4/9/18
Construction Authorization Expiration Date: 4/9/23

HTE# 18-5-43579

Permit # 30026

Harnett County Department of Public Health Site Sketch

PROPERTY LOCATION: CLARK RD

ISSUED TO: ONGAL CAMMOTH & ELIZABETH SUBDIVISION CURRIN PLANTATION LOT # 19

Authorized State Agent: ~~REDACTED~~ REAS (OLIVER TOLKSDORF) Date: 4/9/19

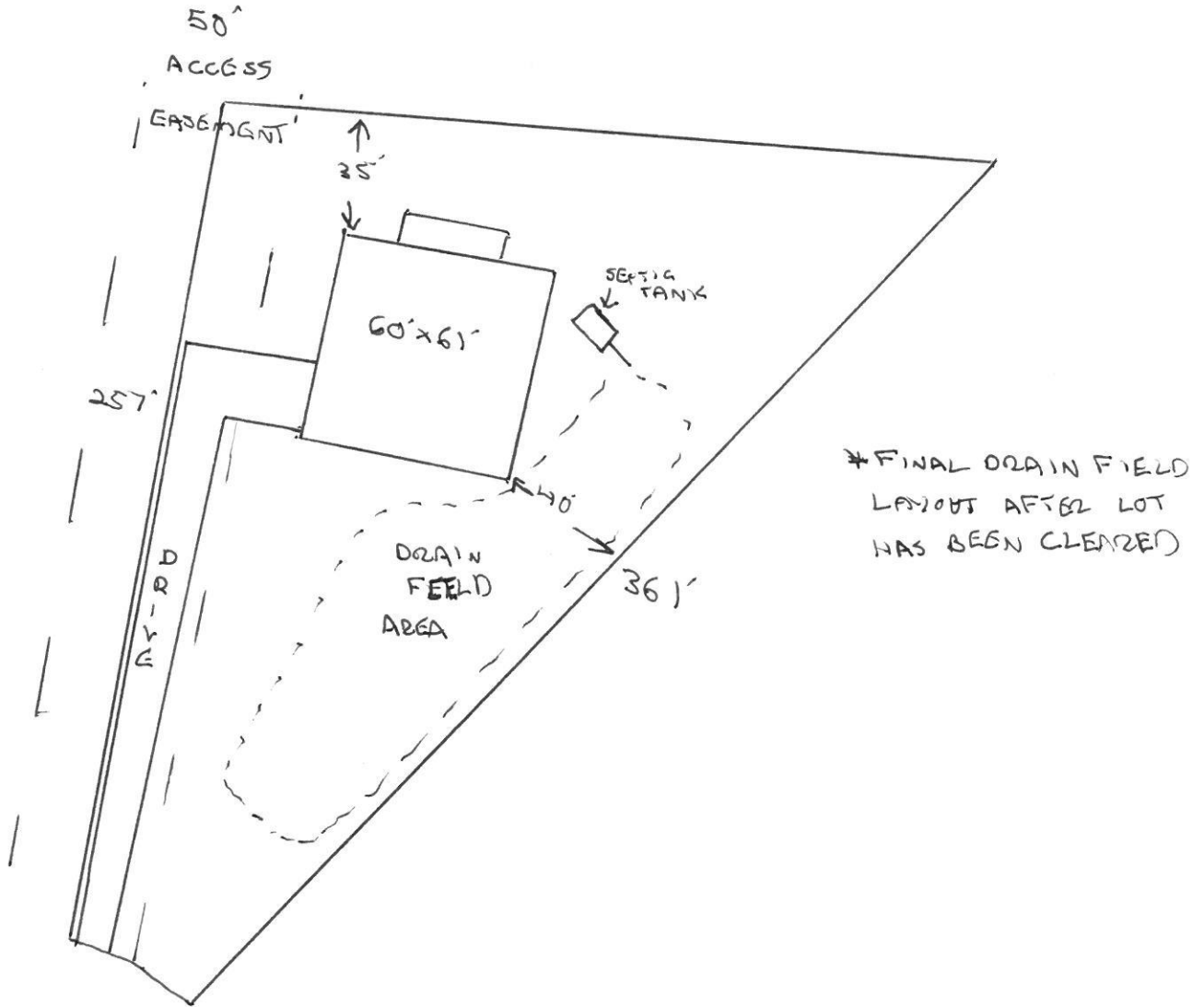

**SOIL/SITE EVALUATION
 for ON-SITE WASTEWATER SYSTEM**

Owner: Applicant:
 Address: Date Evaluated:
 Proposed Facility: *S BORN* Design Flow (.1949): *600 gpd* Property Size:
 Location of Site: Property Recorded:
 Water Supply: Public Individual Well Spring Other
 Evaluation Method: Auger Boring Pit Cut
 Type of Wastewater: Sewage Industrial Process Mixed

P R O F I L E #	.1940 Landscape Position/ Slope %	Horizon Depth (In.)	SOIL MORPHOLOGY .1941		OTHER PROFILE FACTORS				Profile Class & LTAR
			.1941 Structure/ Texture	.1941 Consistence Mineralogy	.1942 Soil Wetness/ Color	.1943 Soil Depth (IN.)	.1956 Sapro Class	.1944 Restr Horiz	
1	<i>LS 2-5</i>	<i>G-67</i>	<i>G S</i>	<i>VFI NSHP</i>	<i>WET @ 32"</i>				<i>S.8</i>
2		<i>0-56</i>	<i>G S</i>	<i>VFI NSHP</i>					<i>S.8</i>
3		<i>0-36</i>	<i>G S</i>	<i>VFI NSHP</i>	<i>STANDING WTR @ 24"</i>				<i>US</i>
21		<i>0-20</i>	<i>G S</i>	<i>VFI NSHP</i>					
		<i>20-40</i>	<i>SBR SCL</i>	<i>F7 SSHP</i>					<i>PS 15</i>

Description	Initial System	Repair System	Other Factors (.1946): Site Classification (.1948): <i>86</i> Evaluated By: <i>OX</i> Others Present: <i>-</i>
Available Space (.1945)	<input checked="" type="checkbox"/>	<input checked="" type="checkbox"/>	
System Type(s)	<i>25' x 20' x 25'</i>	<i>25'</i>	
Site LTAR	<i>15</i>	<i>5</i>	