

ANDREW LANKFORD  
DB 3117, PG 790  
MAP#2004-742

JEFF & LINDA JONES  
DB 2625, PG 899  
MAP#2008-424

S88°24'20"E  
32.20'(F)  
S88°28'24"E  
32.18'(R)

JANE HOLLAND  
DB 267, PG 564  
MAP#2007-1033

N74°12'14"W  
66.31'(F)  
N74°20'57"W  
66.76'(R)

(14)  
THE RESERVE  
MB 2016, PG 161

N76°40'03"W  
49.18'  
(TIE LINE)

TROPHY RIDGE  
50' PUBLIC R/W

CURVE TABLE

CURVE	RADIUS	LENGTH	CH. BEARING	CHORD
C1(R)	25.00'	21.03'	N47°37'12"W	20.41'
C1(F)	25.00'	21.02'	N47°45'01"W	20.40'
C2(R)	50.00'	20.72'	N35°23'39"W	20.58'
C2(F)	50.00'	20.64'	N36°14'08"W	20.49'

201.36'(R)  
200.41'(F)

(13)  
58,797 SF  
1.35 AC

N18°17'07"E  
225.62'(R)  
N18°11'21"E  
225.68'(F)  
20' DRAINAGE EASEMENT

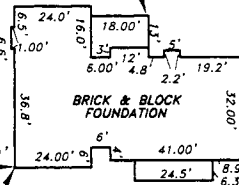

N71°34'08"W  
66.69'(F)  
N71°42'53"W  
66.79'(R)

5' UNDERGROUND  
UTILITY EASEMENT

447.96'(F)  
448.45'(R)  
S18°10'54"W  
S18°17'07"W

(12)  
THE RESERVE  
MB 2016, PG 161

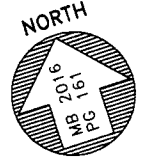
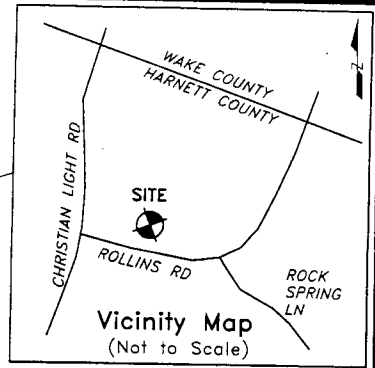

LEGEND

- R/W-RIGHT OF WAY
- DB-DEED BOOK
- PG-PAGE
- EIR-EXISTING IRON REBAR
- SF-SQUARE FEET
- AC-ACRE(S)
- PB-PLAT BOOK
- AG-ABOVE GROUND
- BG-BELOW GROUND
- (F)-FIELD MEASUREMENT
- (R)-RECORDED MEASUREMENT
- EMN-EXISTING MAG NAIL
- SURVEYED LINE
- EASEMENT LINE
- LINE NOT SURVEYED

FOUNDATION SURVEY

PROPERTY OF: WATERMARK HOMES, INC.  
ADDRESS: 92 TROPHY RIDGE  
CITY: NEAR FUQUAY VARINA, NC  
COUNTY: HARNETT  
TAX PIN: 0645-47-8262.000

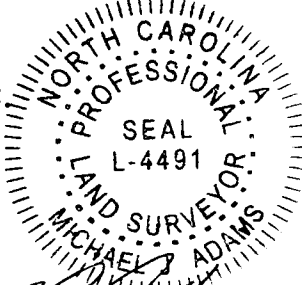

TOWNSHIP: HECTOR'S CREEK  
DATE: FEB 14, 2018  
SCALE: 1" = 60'  
REFERENCE: LOT 13  
THE RESERVE  
MB 2016, PG 161

MICHAEL J. ADAMS PLS-L-4491  
CFS NC-075

MINIMUM SETBACKS:  
35'-FRONT  
10'-SIDE  
25'-REAR

GRAPHIC SCALE

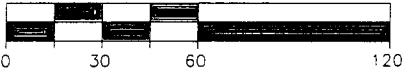

M.A.P.S. SURVEYING, INC.  
C-2589  
1306 FORT BRAGG ROAD  
FAYETTEVILLE, NC 28305  
PHN: (910)484-6432  
www.mapsurveying.com

DRAWN BY: MJA

I CERTIFY THAT THIS MAP WAS DRAWN UNDER MY SUPERVISION FROM AN ACTUAL SURVEY MADE UNDER MY SUPERVISION, DEED DESCRIPTION RECORDED IN MB 2016, PG 161, THAT THE BOUNDARIES NOT SURVEYED ARE INDICATED AS DRAWN FROM INFORMATION IN MB 2016, PG 161; THAT THE RATIO OF PRECISION OR POSITIONAL ACCURACY IS GREATER THAN 1:10,000; AND THAT THIS MAP MEETS THE REQUIREMENTS OF THE STANDARDS OF PRACTICE FOR LAND SURVEYING IN NORTH CAROLINA (21 NCAC 56.1600). THIS MAP IS NOT DRAWN IN ACCORDANCE WITH GS 47-30. THIS 14TH DAY OF FEBRUARY, 2018.