

ADDRESS . . : 3610 KIPLING RD
 CONTRACTOR : STE GENERAL CONTRACTORS, LLC
 OWNER . . . : MORGAN MARVIN & AMBER
 PARCEL . . . : 05-0633- - -0032- -05-
 APPL NUMBER: 17-50042688 CP NEW RESIDENTIAL (SFD)
 DIRECTIONS : T/S: 11/02/2017 08:46 AM LLUCAS ----
 401 N TO L ON CHRISTIAN LIGHT RD - PASS
 BOB & NANS STORE - TAKE RIGHT ONTO
 KIPLING RD - LOT 4 IS ON THE LEFT

SUBDIV: PHELMA B ROGERS & WILLIAM H
 PHONE : (910) 891-5465
 PHONE :

STRUCTURE: 000 000 55X62 5BDR 3BTH W/GAR W/DEC CRWL FN BON

FLOOD ZONE : FLOOD ZONE X
 # BATHS : 3 # BEDROOMS : 5.00
 PROPOSED USE : SFD SEPTIC - EXISTING? : NEW
 WATER SUPPLY : COUNTY

PERMIT: CPSF 00 CP * SFD

TYP/SQ	REQUESTED COMPLETED	INSP RESULT	DESCRIPTION RESULTS/COMMENTS
A814 01	11/21/17 11/21/17	SB AP	ADDRESS CONFIRMATION TIME: 17:00 VRU #: 003055951 3610 KIPLING RD FUQUAY VARINA 27526 T/S: 11/21/2017 09:12 AM SBENNETT -----
B101 01	11/21/17 11/21/17	BS AP	R*BLDG FOOTING / TEMP SVC POLE TIME: 17:00 VRU #: 003055969 T/S: 11/20/2017 08:42 AM JBROCK ----- T/S: November 21, 2017 09:59 AM BSUTTON ----- no tpole on site
B103 01	12/06/17 12/06/17	MC AP	R*BLDG FOUND & TEMP SVC POLE VRU #: 003062312 T/S: 12/06/2017 03:17 PM MCOOK -----
B105 01	12/13/17 12/13/17	MC DA	R*OPEN FLOOR VRU #: 003065869 T/S: 12/13/2017 01:51 PM MCOOK ----- 1. missing all point loads
B105 02	12/14/17 12/14/17	MC AP	R*OPEN FLOOR TIME: 17:00 VRU #: 003066776 T/S: 12/13/2017 01:51 PM JBROCK ----- T/S: 12/14/2017 03:37 PM MCOOK -----
R425 01	1/23/18 <u>11</u>	TI <u>AP</u>	FOUR TRADE ROUGH IN VRU #: 003078136

COMMENTS AND NOTES

A A TAKLA ENGINEERING, PLLC

Consulting. Design. Efficiency.



ANDY A. TAKLA, EI
919-423-0470
ANDYTAKLA@TAKLAENGR.COM
Cert. #A-29014

ATEF A. TAKLA, PE
919-358-1758
ATEFTAKLA@TAKLAENGR.COM
Lic. #14578

ALFRED A. TAKLA, EI
919-332-7903
ALFREDTAKLA@TAKLAENGR.COM
Cert. #A-20939

NC Firm License No. P-1446
PO Box 71298 Durham NC 27722

FIELD REPORT

Date: 1/12/18
Project: 3610 Kipling RD
Location: Farmway-Varina, NC
Company: _____
Care of: Shane McLeod

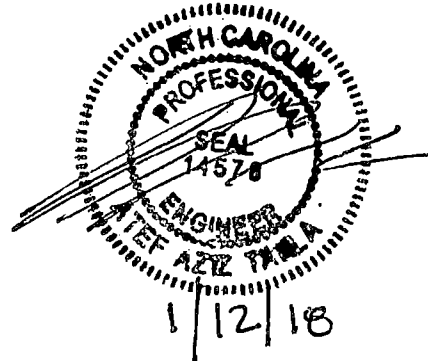

AS REQUESTED A-TAKLA VISITED THE PROPERTY and observed THE entire framing of THE House and FOUND adequate, per Plans and meets NCSRC - 2012 Edition.

NOTE Install Braces at Left side Gable end wall. (2) - 2x6 Purlins with (2) 2x4 Braces @ 40" o.c

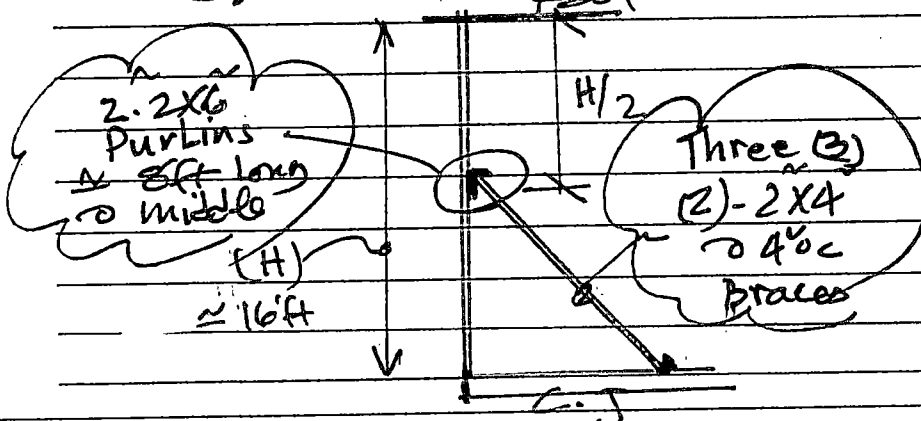

Limitations of Inspection Services provided are in accordance with the standard of practice for structural engineering and within the limits imposed by scope, schedule and budget. The determinations contained in this report are based on conditions observed at the time of the evaluation. No guarantees or warranties, expressed or implied, under this Agreement or otherwise, shall be construed in connection with services provided. Sequencing, and means and methods of construction are considered beyond the scope of this report.