

HTE# 17-5-42609

Harnett County Department of Public Health

29747

Improvement Permit

A building permit cannot be issued with only an Improvement Permit

ISSUED TO: ATLANTIC CONSTRUCTION PROPERTY LOCATION: WILL LUCAS RD
 SUBDIVISION: SWEETWATER LOT # 26
 NEW REPAIR EXPANSION
 Type of Structure: SFO (50'x50') Site Improvements required prior to Construction Authorization Issuance: _____
 Proposed Wastewater System Type: 25% REDUCTION SYSTEM
 Projected Daily Flow: 480 GPD
 Number of bedrooms: 4 Number of Occupants: 8 max
 Basement Yes No
 Pump Required: Yes No May be required based on final location and elevations of facilities
 Type of Water Supply: Community Public Well Distance from well _____ feet Permit valid for: Five years
 No expiration
 Permit conditions: _____

Authorized State Agent: [Signature] REHS Date: 11/15/17 SEE ATTACHED SITE SKETCH

The issuance of this permit by the Health Department in no way guarantees the issuance of other permits. The permit holder is responsible for checking with appropriate governing bodies in meeting their requirements. This site is subject to revocation if the site plan, plat, or the intended use changes. The Improvement Permit shall not be affected by a change in ownership of the site. This permit is subject to compliance with the provisions of the Laws and Rules for Sewage Treatment and Disposal and to conditions of this permit.

Construction Authorization

(Required for Building Permit)

The construction and installation requirements of Rules .1950, .1952, .1954, .1955, .1956, .1957, .1958, and .1959 are incorporated by references into this permit and shall be met. Systems shall be installed in accordance with the attached system layout.

ISSUED TO: ATLANTIC CONSTRUCTION PROPERTY LOCATION: WILL LUCAS RD
 SUBDIVISION: SWEETWATER LOT # 26
 Facility Type: SFO (50'x50') New Expansion Repair
 Basement? Yes No Basement Fixtures? Yes No
 Type of Wastewater System** 25% REDUCTION SYSTEM (Initial) Wastewater Flow: 480 GPD
 (See note below, if applicable 25% REDUCTION SYSTEM (Repair))

Installation Requirements/Conditions

Septic Tank Size <u>1000</u> gallons	Number of trenches <u>1</u>	Exact length of each trench <u>240</u> feet	Trench Spacing: <u>9</u> Feet on Center
Pump Tank Size _____ gallons	Trenches shall be installed on contour at a	Maximum Trench Depth of: <u>48-60</u> inches	Soil Cover: <u>36"</u> inches
	(Trench bottoms shall be level to +/-1/4"	in all directions)	(Maximum soil cover shall not exceed 36" above the trench bottom)

Pump Requirements: _____ ft. TDH vs. _____ GPM _____ inches below pipe
 Aggregate Depth: _____ inches above pipe
 Conditions: _____ inches total

**WATER LINES (INCLUDING IRRIGATION) MUST BE 10FT. FROM ANY PART OF SEPTIC SYSTEM OR REPAIR AREA.
 NO UTILITIES ALLOWED IN INITIAL OR REPAIR DRAIN FIELD AREA.**

**If applicable: I understand the system type specified is different from the type specified on the application. I accept the specifications of this permit.

Owner/Legal Representative Signature: _____ Date: _____

This Construction Authorization is subject to revocation if the site plan, plat, or the intended use changes. The Construction Authorization shall not be transferred when there is a change in ownership of the site. This Construction Authorization is subject to compliance with the provisions of the Laws and Rules for Sewage Treatment and Disposal and to the conditions of this permit. SEE ATTACHED SITE SKETCH

Authorized State Agent: [Signature] REHS Date: 11/15/17
 Construction Authorization Expiration Date: 11/15/22

HTE# 17-5-42609

Permit # 29747

Harnett County Department of Public Health Site Sketch

ISSUED TO: ATLANTIC CONSTRUCTION PROPERTY LOCATOR: WILL LUCAS RD
SUBDIVISION: SWEETWATER LOT # 26

Authorized State Agent: ~~REHS (OLIVER TOLKSDORF)~~ Date: 11/15/17

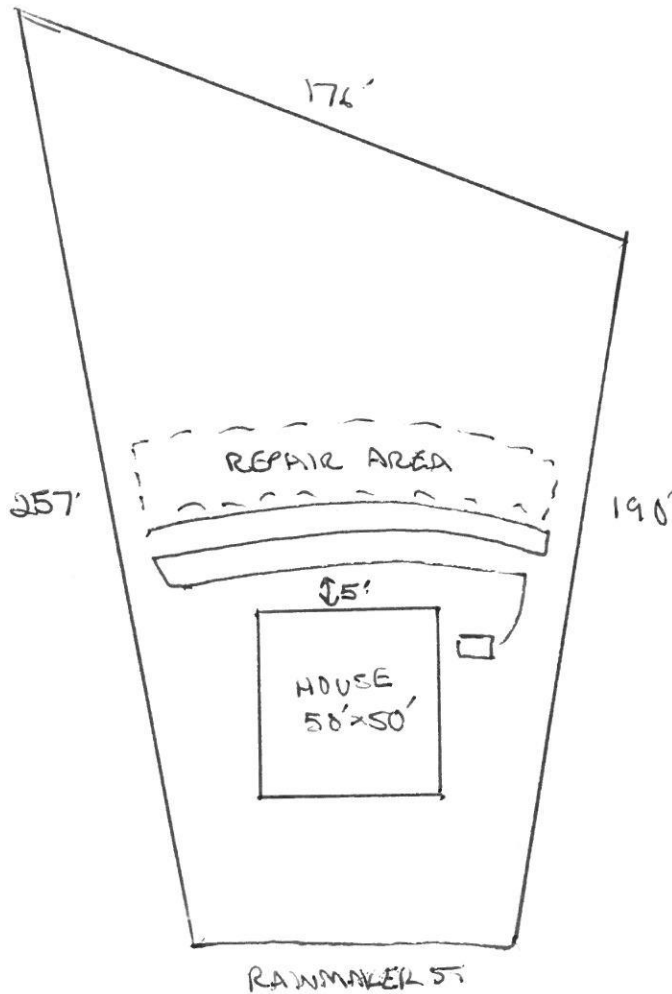

**SOIL/SITE EVALUATION
 for ON-SITE WASTEWATER SYSTEM**

Owner: Applicant:
 Address: Date Evaluated:
 Proposed Facility: UBOcm Design Flow (.1949): 480 gpd Property Size:
 Location of Site: Property Recorded:
 Water Supply: Public Individual Well Spring Other
 Evaluation Method: Auger Boring Pit Cut
 Type of Wastewater: Sewage Industrial Process Mixed

P R O F I L E #	.1940 Landscape Position/ Slope %	Horizon Depth (In.)	SOIL MORPHOLOGY .1941		OTHER PROFILE FACTORS				Profile Class & LTAR
			.1941 Structure/ Texture	.1941 Consistence Mineralogy	.1942 Soil Wetness/ Color	.1943 Soil Depth (IN.)	.1956 Sapro Class	.1944 Restr Horiz	
1	LS 0-2	0-10	G S	VFA ns/np					
		10-24	SBK SCL	F2 SS/SP					
		24-41	SBK CL	F2 SS/SP					PS .5
		48-72	G S	VFA ns/np					
2		0-12	G S	VFA ns/np					
		12-30	SBK SCL	F2 SS/SP					
		30-42	SBK CL	F2 SS/SP					PS .5
		42-68	G S	VFA ns/np					

Description	Initial System	Repair System	Other Factors (.1946): Site Classification (.1948): Evaluated By: Others Present:
Available Space (.1945)	<input checked="" type="checkbox"/>	<input type="checkbox"/>	
System Type(s)	<u>25" R60</u>		
Site LTAR	<u>.5</u>	<u>.5</u>	

124" @ 48"-60"