

HTE# 17-5-424982

Harnett County Department of Public Health

29779

Improvement Permit

A building permit cannot be issued with only an Improvement Permit

ISSUED TO: Gary Robinson Homes, LLC PROPERTY LOCATION: 248 Saddle Ln. (Bruce Johnson Rd.)
 NEW REPAIR EXPANSION SUBDIVISION: Johnson Farms LOT # 16
 Type of Structure: 3BR 50'x40' SFD Site Improvements required prior to Construction Authorization Issuance: _____
 Proposed Wastewater System Type: 25% Reduction Sys.
 Projected Daily Flow: 360 GPD
 Number of bedrooms: 3 Number of Occupants: 6 max
 Basement Yes No
 Pump Required: Yes No May be required based on final location and elevations of facilities
 Type of Water Supply: Community Public Well Distance from well _____ feet Permit valid for: Five years
 Permit conditions: _____ No expiration

Authorized State Agent: [Signature] Date: 12/21/2017 SEE ATTACHED SITE SKETCH
 The issuance of this permit by the Health Department in no way guarantees the issuance of other permits. The permit holder is responsible for checking with appropriate governing bodies in meeting their requirements. This site is subject to revocation if the site plan, plat, or the intended use changes. The Improvement Permit shall not be affected by a change in ownership of the site. This permit is subject to compliance with the provisions of the Laws and Rules for Sewage Treatment and Disposal and to conditions of this permit.

Construction Authorization

(Required for Building Permit)

The construction and installation requirements of Rules .1950, .1952, .1954, .1955, .1956, .1957, .1958, and .1959 are incorporated by references into this permit and shall be met. Systems shall be installed in accordance with the attached system layout.

ISSUED TO: Gary Robinson Homes, LLC PROPERTY LOCATION: 248 Saddle Ln. (Bruce Johnson Rd.)
 SUBDIVISION: Johnson Farms LOT # 16
 Facility Type: 3BR 50'x40' SFD New Expansion Repair
 Basement? Yes No Basement Fixtures? Yes No
 Type of Wastewater System** 25% Reduction system (Initial) Wastewater Flow: 360 GPD
 (See note below, if applicable
Pump to 25% Red. Sys. (Repair)

Installation Requirements/Conditions

Septic Tank Size <u>1000</u> gallons	Number of trenches <u>1</u>	Exact length of each trench <u>270</u> feet	Trench Spacing: <u>9</u> Feet on Center
Pump Tank Size _____ gallons	Trenches shall be installed on contour at a Maximum Trench Depth of: <u>24</u> inches (Trench bottoms shall be level to +/-1/4" in all directions)	Soil Cover: <u>17</u> inches (Maximum soil cover shall not exceed 36" above the trench bottom)	
Pump Requirements: _____ ft. TDH vs. _____ GPM		Aggregate Depth: _____ inches below pipe	_____ inches above pipe
Conditions: _____		_____ inches total	

WATER LINES (INCLUDING IRRIGATION) MUST BE 10FT. FROM ANY PART OF SEPTIC SYSTEM OR REPAIR AREA. NO UTILITIES ALLOWED IN INITIAL OR REPAIR DRAIN FIELD AREA.

**If applicable: I understand the system type specified is different from the type specified on the application. I accept the specifications of this permit.

Owner/Legal Representative Signature: _____ Date: _____

This Construction Authorization is subject to revocation if the site plan, plat, or the intended use changes. The Construction Authorization shall not be transferred when there is a change in ownership of the site. This Construction Authorization is subject to compliance with the provisions of the Laws and Rules for Sewage Treatment and Disposal and to the conditions of this permit. SEE ATTACHED SITE SKETCH

Authorized State Agent: [Signature] Date: 12/21/2017
ANDREW CURRAN Construction Authorization Expiration Date: 12/21/2020

HTE# 17-5-424982

Permit # 29779

Harnett County Department of Public Health Site Sketch

PROPERTY LOCATION: 248 Saddle Ln. (Bruce Johnson Rd)

ISSUED TO: Gary Robinson Homes, LLC SUBDIVISION Johnson Farms LOT # 16

Authorized State Agent: *Andrew Corrin* Date: 12/21/2017
ANDREW CORRIN

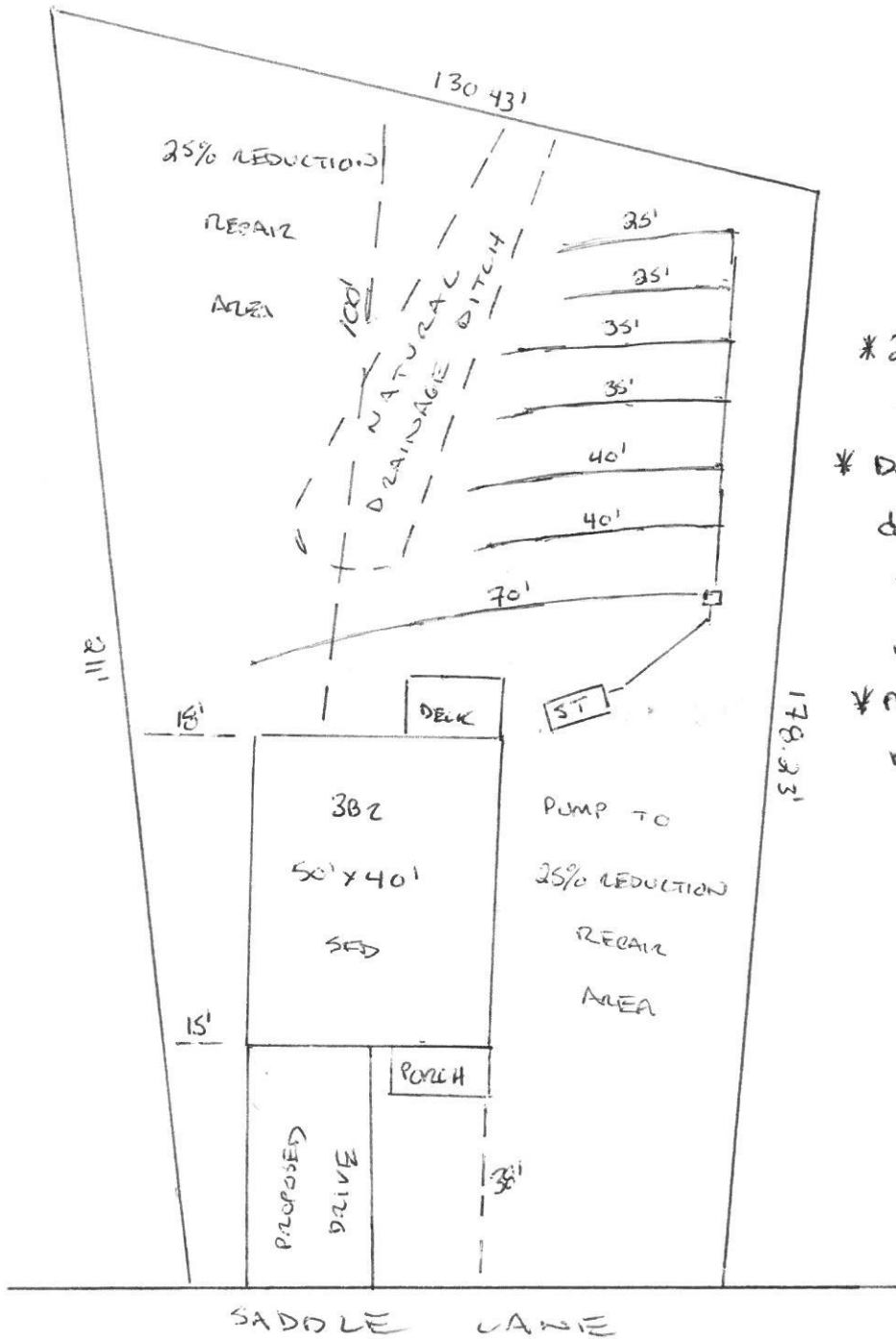

- * 270FT 25% reduction chamber required
- * Deck specifications dependent on final location of septic with 5ft setback
- * May require to meet onsite prior to install