

ADDRESS : 78 VIC MCLEOD CT
 CONTRACTOR : WJH LLC
 OWNER : MASTIN BAKER INVESTMENTS LLC
 PARCEL : 07-0589- - -0102- -34-
 APPL NUMBER: 17-50042299 CP NEW RESIDENTIAL (SFD)
 DIRECTIONS : T/S: 09/19/2017 09:02 AM JBROCK ----
 COTTLESTONE #30
 210 S TAKE L ONTO S MAIN ST THEN R ONTO
 E FRONT ST
 CALLED IN PREMISE 1/10/18 LL @3:11PM
 PREMISE#13602734

SUBDIV: J L STONE
 PHONE : (336) 282-3606
 PHONE :

APPL NOTES : BPMN 12/07/17 T/S: 12/07/2017 01:40 PM BPETRICH --
 PREMISE 13602734

STRUCTURE: 000 000 38X38 4BDR 2.5BA MONO W/ GARAGE

FLOOD ZONE : FLOOD ZONE X
 # BEDROOMS : 4000000.00 PROPOSED USE : SFD
 SEPTIC - EXISTING? : NEW TANK WATER SUPPLY : COUNTY

PERMIT: CPSF 00 CP * SFD

| TYP/SQ | REQUESTED COMPLETED | INSP RESULT | DESCRIPTION RESULTS/COMMENTS |
|---------|----------------------|-------------|---|
| A814 01 | 11/27/17 11/27/17 | SB AP | ADDRESS CONFIRMATION TIME: 17:00 VRU #: 003057478 78 VIC MCLEOD CT COATS 27521 T/S: 11/27/2017 11:14 AM SBENNETT ----- |
| P309 01 | 11/28/17 11/28/17 | DT AP | R*PLUMB UNDER SLAB TIME: 17:00 VRU #: 003057494 T/S: 11/27/2017 09:05 AM JBROCK ----- T/S: 11/28/2017 12:08 PM DETAYLOR ----- |
| B114 01 | 12/13/17 12/13/17 | DT DA | R*BLDG MONO SLAB/TEMP SVC POLE TIME: 17:00 VRU #: 003065265 T/S: 12/12/2017 08:54 AM BPETRICH ----- T/S: 12/13/2017 01:52 PM DETAYLOR ----- Replace plastic |
| B114 02 | 12/15/17 12/15/17 | DT AP | R*BLDG MONO SLAB/TEMP SVC POLE TIME: 17:00 VRU #: 003067428 T/S: 12/14/2017 01:54 PM BPETRICH ----- T/S: 12/14/2017 01:55 PM BPETRICH ----- T/S: 12/15/2017 03:27 PM DETAYLOR ----- |
| E207 01 | 1/02/18 1/02/18 | DT AP | R*ELEC TEMP SERVICE POLE TIME: 17:00 VRU #: 003072188 T/S: 12/29/2017 01:32 PM BPETRICH ----- DUKE DIDN'T HAVE THE POLES SET IN TIME FOR MONO SLAB INSPECTION T/S: 01/02/2018 01:57 PM DETAYLOR ----- |
| R425 01 | 1/16/18 1/16/18 | BP CA | FOUR TRADE ROUGH IN TIME: 17:00 VRU #: 003076288 T/S: 01/12/2018 01:49 PM BPETRICH ----- T/S: 01/16/2018 09:38 AM BPETRICH ----- CANCELLED PER MARK COATS |
| B104 01 | 1/22/18 1/22/18 | JB AP | R*FOUND & SETBACK VERIF SURVEY TIME: 17:00 VRU #: 003078037 T/S: 01/22/2018 08:34 AM JBROCK ----- |
| R425 02 | 2/12/18 2/12/18 | KS DA | FOUR TRADE ROUGH IN TIME: 17:00 VRU #: 003088002 T/S: 02/09/2018 01:33 PM JBROCK ----- 1. Plann calls for 3 jack studs at end of garage door opening. 2. 2x4 to the left of garage door shall be double-bored over 60 percent. 3. Trap in garage leaking. 4. F08 floor truss at base of stairs has gussets that no longer are attached. Need truss engineer's repair. 5. Drain stand pipe empty in hall bath. (leak from trap) 6. |

ADDRESS : 78 VIC MCLEOD CT
CONTRACTOR : WJH LLC
OWNER : MASTIN BAKER INVESTMENTS LLC
PARCEL : 07-0589- - -0102- -34--
APPL NUMBER: 17-50042299 CP NEW RESIDENTIAL (SFD)

SUBDIV: J L STONE
PHONE : (336) 282-3606
PHONE :

| TYP/SQ | REQUESTED COMPLETED | INSP RESULT | DESCRIPTION RESULTS/COMMENTS |
|---------|------------------------|----------------|---|
| | | | Need roof boots installed on vents. 7. Garage portal framing calls for 2 Simpson c516 straps. 8. Cannot use short nails in floor truss hangars to attach to the lsl in kitchen. |
| R425 03 | 2/21/18 2/21/18 | DT DA | FOUR TRADE ROUGH IN TIME: 17:00 VRU #: 003091857 T/S: 02/20/2018 10:40 AM BPETRICH ----- /S: 02/21/2018 02:40 PM DETAYLOR ----- Previous violation still not corrected. Truss repair at bottom of stairs and bracked for overnotched stud Okay to side and insulate |
| I129 01 | 2/26/18 | TI | R*INSULATION INSPECTION TIME: 17:00 VRU #: 003093895 T/S: 02/23/2018 09:49 AM JBROCK ----- |
| R425 04 | 2/26/18 | TI | FOUR TRADE ROUGH IN TIME: 17:00 VRU #: 003093887 T/S: 02/23/2018 09:49 AM JBROCK ----- |

----- COMMENTS AND NOTES -----

UFP Mid Atlantic LLC, 5631 S. NC 82, Durlington, NC 8-150 s Dec 12 2017 MITek Industries, Inc. Tue Feb 13 09:04:03 2018 Page 1
 ID: BZC??A0uifZkx8j2bx78t3zkCR3-4Y69w59hqADxiofH9D100Qt2M.tb27eMcLYPrsdzicac

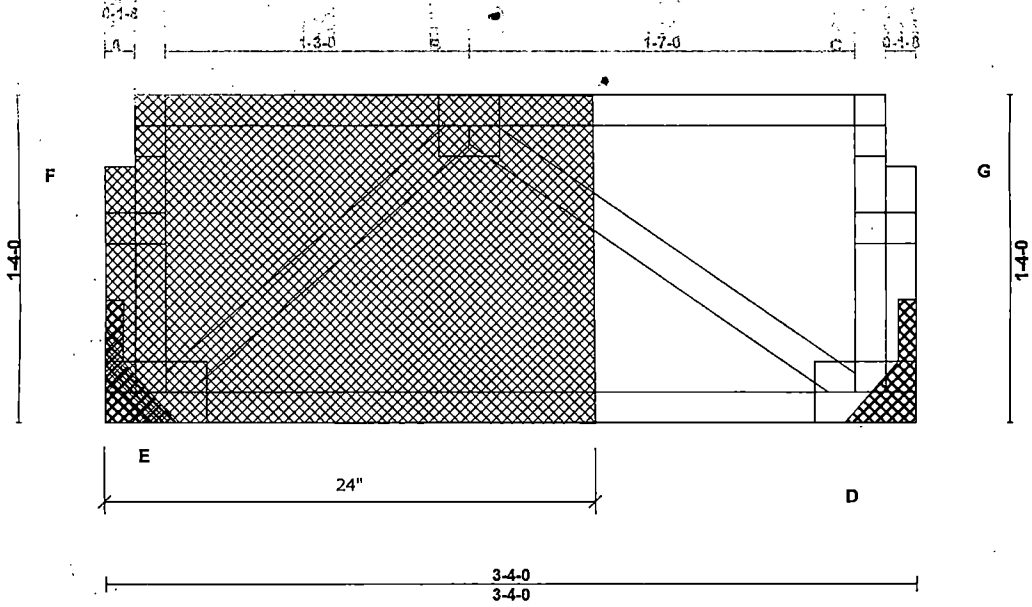

Repair for damaged plates at A, F and E.

Attach 3/4" Plywood or OSB (23/32" APA Rated Sheathing Exposure 1) as shown to each face of truss with 10d (.131" x 3") nails 4" oc in all members.

Plate Offsets (X,Y) - [D:0-2-0,Edge], [E:0-2-0,Edge]

| | | | | | |
|---------------|----------------------|----------|-----------------------------|---------------|---------------|
| LOADING (psf) | SPACING- 2-0-0 | CSI. | DEFL. in (loc) l/defl L/d | PLATES | GRIP |
| TCLL 40.0 | Plate Grip DOL 1.00 | TC 0.14 | Vert(LL) 0.00 E **** 480 | MT20 | 244/190 |
| TCDL 10.0 | Lumber DOL 1.00 | BC 0.11 | Vert(TL) -0.02 D-E >999 240 | | |
| BCLL 0.0 | Rep Stress Incr YES | WB 0.04 | Horz(TL) 0.00 D n/a n/a | | |
| BCLL 5.0 | Code IRC2009/TPI2007 | Matrix-P | | | |
| | | | | Weight: 21 lb | FT = 4%F, 1%E |

| | |
|---|---|
| LUMBER- TOP CHORD 2x4 SP No.2(flat) BOT CHORD 2x4 SP No.2(flat) WEBS 2x4 SP No.3(flat) | BRACING- TOP CHORD Structural wood sheathing directly applied or 3-4-0 oc purlins, except end verticals. BOT CHORD Rigid ceiling directly applied or 10-0-0 oc bracing. |
|---|---|

REACTIONS. (lb/size) E=163/Mechanical, D=163/Mechanical

FORCES. (lb) - Max. Comp./Max. Ten. - All forces 250 (lb) or less except when shown.

- NOTES- (4)
- 1) All plates are 1.5x3 MT20 unless otherwise indicated.
 - 2) This truss is designed in accordance with the 2009 International Residential Code sections R502.11.1 and R802.10.2 and referenced standard ANSI/TPI 1.
 - 3) Recommend 2x6 strongbacks, on edge, spaced at 10-0-0 oc and fastened to each truss with 3-10d (.131" X 3") nails. Strongbacks to be attached to walls at their outer ends or restrained by other means.
 - 4) This repair has been prepared based on information and use conditions supplied by client. Designer has made a good faith effort to outline damage and repair conditions as reported by client. When actual field conditions do not approximate those indicated on this drawing, client shall immediately inform the engineer and refrain from applying the repair.

LOAD CASE(S) Standard

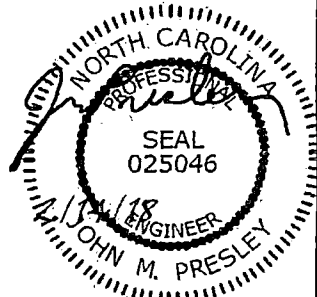

This truss is to be fabricated per ANSI/TPI quality requirements. Plates shall be of size and type shown and centered at joints unless otherwise noted. This design is based upon parameters shown, and is for an individual building component to be installed and loaded vertically. Applicability of design parameters and proper incorporation of component is responsibility of the Building Designer. Building Designer shall verify all design information on this sheet for conformance with conditions and requirements of the specific building and governing codes and ordinances. Building Designer accepts responsibility for the correctness or accuracy of the design information as it may relate to a specific building. Certification is valid only when truss is fabricated by a UFP company. Bracing shown is for lateral support of truss members only and does not replace erection and permanent bracing. Refer to Building Component Safety Information (BCSI) for general guidance regarding storage, delivery, erection and bracing available from SBCA and Truss Plate Institute.

