

**SOIL/SITE EVALUATION  
 for ON-SITE WASTEWATER SYSTEM**

Owner: \_\_\_\_\_ Applicant: Mc Cusker Homes  
 Address: 1460 Olive Branch Date Evaluated:  
 Proposed Facility: 432 SFS Design Flow (.1949): 480 GPD Property Size: 7.48 AC  
 Location of Site: \_\_\_\_\_ Property Recorded: Yes  
 Water Supply:  Public  Individual  Well  Spring  Other  
 Evaluation Method:  Auger Boring  Pit  Cut  
 Type of Wastewater:  Sewage  Industrial Process  Mixed

P R O F I L E #	.1940 Landscape Position/ Slope %	Horizon Depth (In.)	SOIL MORPHOLOGY .1941		OTHER PROFILE FACTORS				Profile Class & LTAR
			.1941 Structure/ Texture	.1941 Consistence Mineralogy	.1942 Soil Wetness/ Color	.1943 Soil Depth (IN.)	.1956 Sapro Class	.1944 Restr Horiz	
1,2	L 2%	0-20	CL LS	FR S/H 1/2 sp					PS
		20-42	OK SLL	FI S P 1/2 sp	7.5YR 7/1 @ 40"	42+			0.35
3	L 2%	0-18	CL LS	FR S/H 1/2 sp					U/RS
		18-28	OK SLL	FI S P 1/2 sp	7.5YR 7/1 @ 26"	28+			0.35
4	L 2%	0-18	CL LS	FR S/H 1/2 sp					U
		18-24	OK SLL	FI S P 1/2 sp	7.5YR 7/1 @ 18"	24+			-
* Soil consistent w/ A. Adams, LSS Report									

Description	Initial System	Repair System	Other Factors (.1946):
Available Space (.1945)	<input checked="" type="checkbox"/>	<input checked="" type="checkbox"/>	Site Classification (.1948): <u>Provisionally suitable</u>
System Type(s)	<u>25% red</u>	<u>25% red</u>	Evaluated By: <u>Andrew Curran, DEHS</u>
Site LTAR	<u>0.35</u>	<u>0.35</u>	Others Present:

COMMENTS: \_\_\_\_\_

LANDSCAPE POSITIONS	GROUP	TEXTURES	.1955 LTAR	CONSISTENCE MOIST	WET
R-RIDGE	I	S-SAND	1.2 - 0.8	VFR-VERY FRIABLE	NS-NON-STICKY
S-SHOULDER SLOPE		LS-LOAMY SAND		FR-FRIABLE	SS-SLIGHTY STICKY
L-LINEAR SLOPE	II	SL-SANDY LOAM	0.8 - 0.6	FI-FIRM	S-STICKY
FS-FOOT SLOPE		L-LOAM		VFI-VERY FIRM	VS-VERY STICKY
N-NOSE SLOPE	III	SI-SILT	0.6 - 0.3	EFI-EXTREMELY FIRM	NP-NON-PLASTIC
H-HEAD SLOPE		SIL-SILT LOAM			SP-SLIGHTLY STICKY
CC-CONCLAVE SLOPE	IV	CL-CLAY LOAM	0.4 - 0.1		P-PLASTIC
CV-CONVEX SLOPE		SCL-SANDY CLAY LOAM			VP-VERY PLASTIC
T-TERRACE		SIC-SILTY CLAY			
FP-FLOOD PLAN		C-CLAY			
		SC-SANDY CLAY			

STRUCTURE

- SG-SINGLE GRAIN
- M- MASSIVE
- CR-CRUMB
- GR-GRANULAR
- SBK-SUBANGULAR BLOCKY
- ABK-ANGULAR BLOCKY
- PL-PLATY
- PR-PRISMATIC

MINERALOGY

- SLIGHTLY EXPANSIVE
- EXPANSIVE

Show profile locations and other site features (dimensions, references or benchmark, and North)

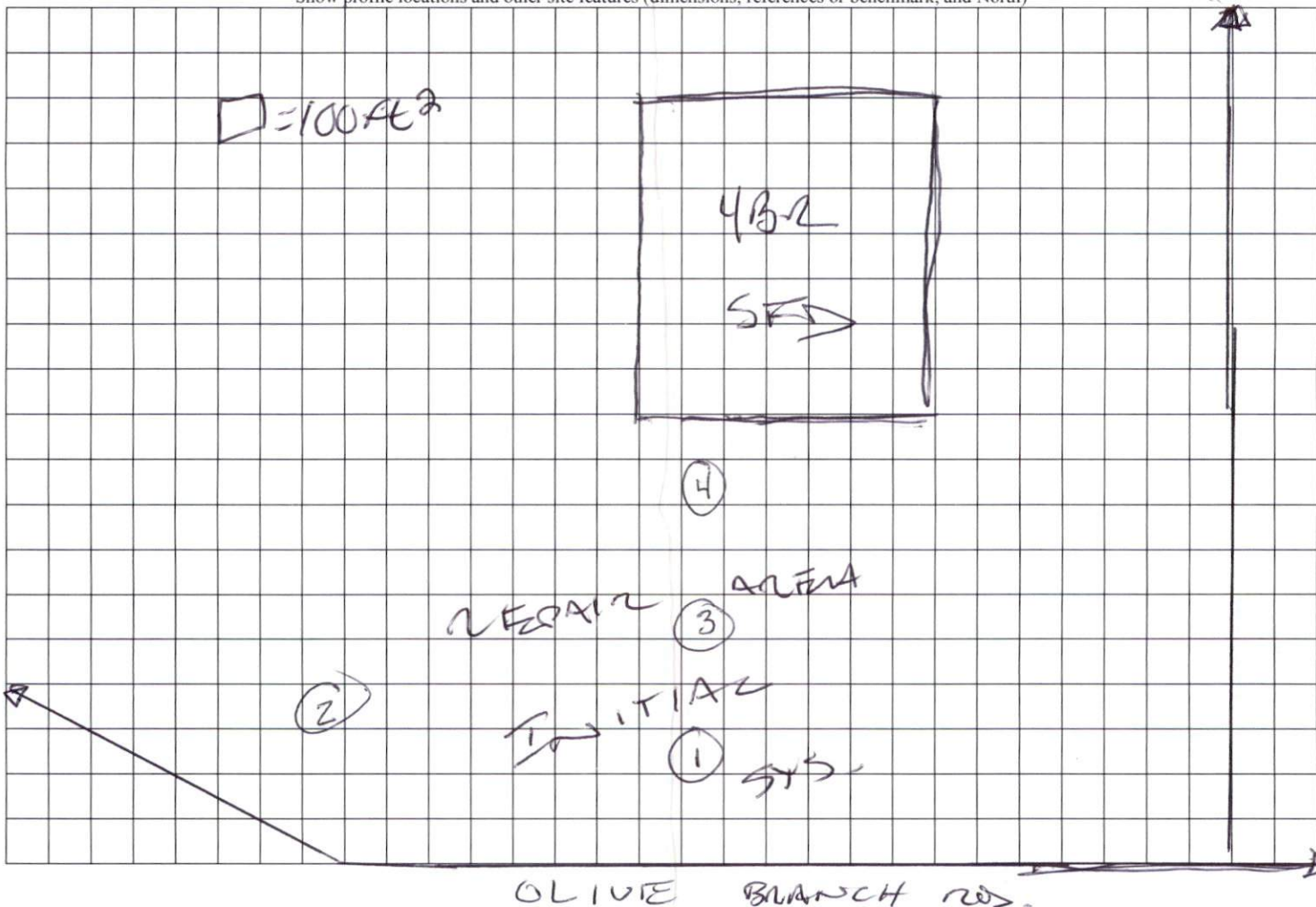

Rodney Lantroop  
4- Bedroom  
1460 Olive Branch Road

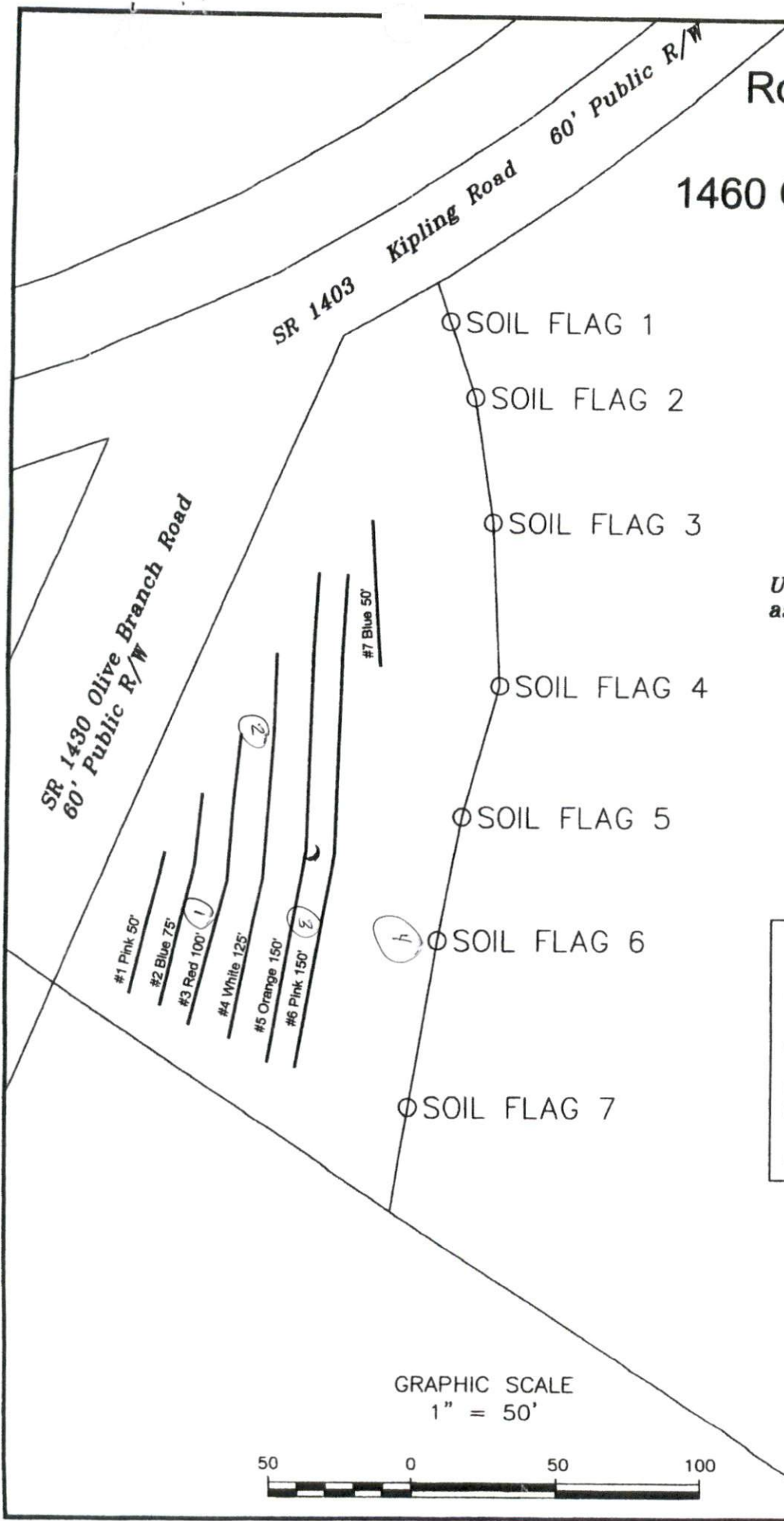

*Usable Soil line  
as flagged by Alex Adams, LLS*

System: Pressure Manifold  
Lines: 1-4, (350')  
0.35 LTAR  
18" Trench Bottom  
Accepted Status System  
Repair: Pressure Manifold  
Lines: 5-7, (300')  
0.35 LTAR  
12" Trench Bottom  
Accepted Status System

GRAPHIC SCALE  
1" = 50'



Adams  
Soil Consulting  
919-414-6761  
Job #521