

HTE# 17-5-41996R

Harnett County Department of Public Health

30038

Improvement Permit

A building permit cannot be issued with only an Improvement Permit

ISSUED TO: PRECISION CUSTOM HOMES PROPERTY LOCATION: NAVAMO TRAIL
 NEW REPAIR EXPANSION SUBDIVISION: SUMMERLIN LOT # 18
 Type of Structure: SFO (50x45) Site Improvements required prior to Construction Authorization Issuance:
 Proposed Wastewater System Type: 25% REDUCTION SYSTEM
 Projected Daily Flow: 360 GPD
 Number of bedrooms: 3 Number of Occupants: 6 max
 Basement Yes No
 Pump Required: Yes No May be required based on final location and elevations of facilities
 Type of Water Supply: Community Public Well Distance from well _____ feet Permit valid for: Five years
 Permit conditions: FENCE OFF FLAGGED DRAIN FIELD TO PREVENT ANY TRAFFIC FROM DISTURBING THE AREA No expiration

Authorized State Agent: [Signature] Date: 4/26/19 SEE ATTACHED SITE SKETCH

The issuance of this permit by the Health Department in no way guarantees the issuance of other permits. The permit holder is responsible for checking with appropriate governing bodies in meeting their requirements. This site is subject to revocation if the site plan, plat, or the intended use changes. The Improvement Permit shall not be affected by a change in ownership of the site. This permit is subject to compliance with the provisions of the Laws and Rules for Sewage Treatment and Disposal and to conditions of this permit.

Construction Authorization

(Required for Building Permit)

The construction and installation requirements of Rules .1950, .1952, .1954, .1955, .1956, .1957, .1958, and .1959 are incorporated by references into this permit and shall be met. Systems shall be installed in accordance with the attached system layout.

ISSUED TO: PRECISION CUSTOM HOMES PROPERTY LOCATION: NAVAMO TRAIL
 SUBDIVISION: SUMMERLIN LOT # 19
 Facility Type: SFO (50x45) New Expansion Repair
 Basement? Yes No Basement Fixtures? Yes No
 Type of Wastewater System** 25% REDUCTION SYSTEM (Initial) Wastewater Flow: 360 GPD
 (See note below, if applicable 25% REDUCTION SYS (Repair))

Installation Requirements/Conditions

Septic Tank Size 1000 gallons
 Pump Tank Size _____ gallons
 Number of trenches 1
 Exact length of each trench 245 feet
 Trench Spacing: 9 Feet on Center
 Trenches shall be installed on contour at a
 Maximum Trench Depth of: 12 inches (Maximum soil cover shall not exceed 36" above the trench bottom)
 (Trench bottoms shall be level to $\pm 1/4"$ in all directions) BELOW NATURAL GRADE
 Pump Requirements: _____ ft. TDH vs. _____ GPM _____ inches below pipe
 Aggregate Depth: _____ inches above pipe
 Conditions: CURTAIN DRAIN REQUIRED - SEE ALL CONDITIONS ON SITE SKETCH _____ inches total

**WATER LINES (INCLUDING IRRIGATION) MUST BE 10FT. FROM ANY PART OF SEPTIC SYSTEM OR REPAIR AREA.
 NO UTILITIES ALLOWED IN INITIAL OR REPAIR DRAIN FIELD AREA.**

**If applicable: I understand the system type specified is different from the type specified on the application. I accept the specifications of this permit.

Owner/Legal Representative Signature: _____ Date: _____

This Construction Authorization is subject to revocation if the site plan, plat, or the intended use changes. The Construction Authorization shall not be transferred when there is a change in ownership of the site. This Construction Authorization is subject to compliance with the provisions of the Laws and Rules for Sewage Treatment and Disposal and to the conditions of this permit.

SEE ATTACHED SITE SKETCH

Authorized State Agent: [Signature] Date: 2/21/19
 Construction Authorization Expiration Date: 2/21/24

HTE# 17-5-41996R

Permit # 30038

Harnett County Department of Public Health Site Sketch

PROPERTY LOCATOR: 17 NAVAHO TRAIL

ISSUED TO: PRECISION CUSTOM HOMES SUBDIVISION Summerlin LOT # 18

Authorized State Agent: ~~_____~~ ALAN (OLIVER) TOLKSON Date: 2/21/19

- * CURTAIN DRAIN
 - 48" TO 6" DEEP
 - APPROX 225' LONG
 - LINE LOWER SIDE W/ PLASTIC
 - INSTALL JUST AFTER FOUNDATION TO GIVE DRAIN FIELD AREA TIME TO DRY

- * HARNETT COUNTY TO BE ON SITE DURING DRAIN FIELD INSTALLATION. SCHEDULE AT LEAST 3 DAYS PRIOR TO INSTALLATION

- * DRAIN FIELD AREA IS CURRENTLY FENCED OFF. NO CONSTRUCTION ACTIVITY IS ALLOWED IN DRAIN FIELD AREA

- * CONTACT HCHD WITH ANY QUESTIONS

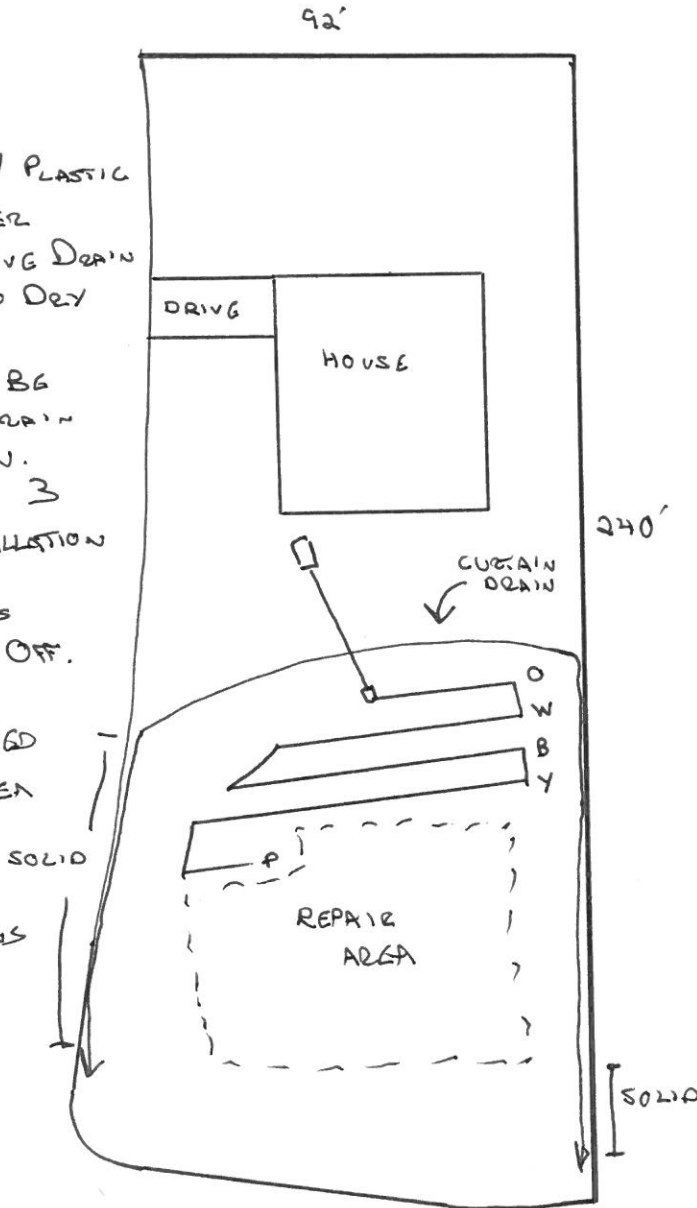

Southeastern Soil & Environmental Associates, Inc.

P.O. Box 9321
Fayetteville, NC 28311
Phone/Fax (910) 822-4540
Email mike@southeasternsoil.com

SUMMERLIN LOT 18

REVISED
SEPTIC LAYOUT
AFTER LOT
DISTURBANCE

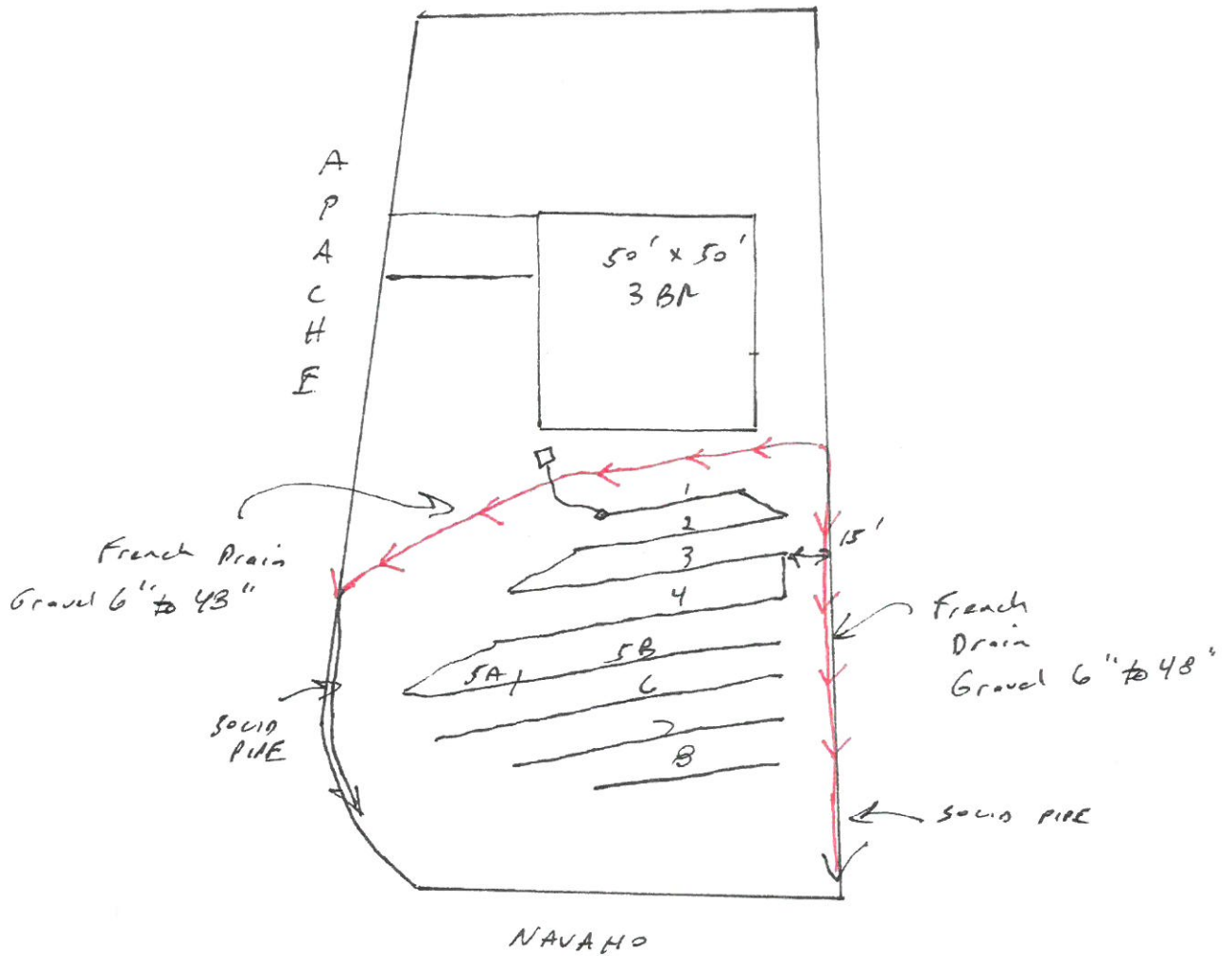

1" = 40'

SOUTHEASTERN SOIL & ENVIRONMENTAL ASSOC., INC.

PROPOSED SUBSURFACE WASTE DISPOSAL SYSTEM DETAIL SHEET (REVISED 3/27/18) AFTER GRADING

SUBDIVISION: SUMMERLIN

LOT 18

INITIAL SYSTEM: APPROVED 25% REDUCTION

REPAIR APPROVED 25% REDUCTION

DISTRIBUTION: SERIAL

DISTRIBUTION SERIAL

BENCHMARK: 100.0

LOCATION TOP OF PLASTIC PIPE NEAR PC

NO. BEDROOMS: 3

LTAR 0.4 gpd / ft²

| LINE | FLAG COLOR | ELEVATION | LENGTH |
|------|------------|-----------|-------------|
| 1 | O | 104.25 | 40' |
| 2 | W | 103.75 | 50' |
| 3 | B | 103.18 | 65' |
| 4 | Y | 102.84 | 70' |
| 5A | P | 102.25 | 20' |
| | | | <u>245'</u> |
| 5B | P | 102.25 | 60' |
| 6 | W | 101.72 | 85' |
| 7 | B | 100.75 | 60' |
| 8 | Y | 100.17 | 40' |
| | | | <u>245'</u> |

In. tie system

BY MEAWEN / BC Royne

DATE 03/26/18

TYPICAL PROFILE 12-0 (mixed fill)
0-10 LS (Vfr, wgr)
10-36 sll (F₁/F₂, shll)
C1 2 > 27"

⊕ THERE SHALL BE NO GRADING,
 CUTTING, LOGGING OR OTHER SOIL
 DISTURBANCE IN SEPTIC AREA

⊕ ANY DISTURBANCE MAY CAUSE A SITE

* Recommend installation oversight
 as trench depth may need to vary

TO BECOME UNSUITABLE
 ⊕ DESIGN DOES NOT GUARANTEE
 FUNCTIONALITY FOR A SPECIFIC
 LENGTH OF TIME

* recommend installing French Drain after foundation to
 allow septic area to dry out.