

ADDRESS : 135 HEATHERWOOD DR
CONTRACTOR :
OWNER : MCKEE HOMES LLC
PARCEL : 03-9589-01- -1021- -10-
APPL NUMBER: 17-50041778 CP NEW RESIDENTIAL (SFD)
DIRECTIONS : T/S: 07/06/2017 08:53 AM JBROCK ----
OAKMONT #178 - 135 HEATHERWOOD DR

STRUCTURE: 000 000 38.4X64.4 3BDR MONO W/ GARAGE & PATIO
FLOOD ZONE : FLOOD ZONE X
BEDROOMS : 3000000.00
SEPTIC - EXISTING? : NEW TANK
PROPOSED USE : SFD
WATER SUPPLY : COUNTY

PERMIT: CPSF 00 CP * SFD

TYP/SQ	REQUESTED COMPLETED	INSP RESULT	DESCRIPTION RESULTS/COMMENTS
P309 01	8/24/17	JLP	R*PLUMB UNDER SLAB VRU #: 003016441
	8/24/17	DA	Head test down.
B104 01	8/25/17	TI	R*FOUND & SETBACK VERIF SURVEY VRU #: 003017225
	8/24/17	CA	
A814 01	8/28/17	SB	ADDRESS CONFIRMATION TIME: 17:00 VRU #: 003018470
	8/29/17	AP	135 HEATHERWOOD DR LILLINGTON 27546 T/S: 08/29/2017 08:59 AM SBENNETT T/S: 08/29/2017 09:03 AM SBENNETT
P309 02	8/28/17	JH	R*PLUMB UNDER SLAB TIME: 17:00 VRU #: 003017654
	8/28/17	AP	T/S: 08/25/2017 02:35 PM LLUCAS T-POLE PASSED
B114 01	8/31/17	JH	R*BLDG MONO SLAB/TEMP SVC POLE VRU #: 003019205
	8/31/17	CA	PER CHRIS
B114 02	9/08/17	JH	R*BLDG MONO SLAB/TEMP SVC POLE VRU #: 003022605
	9/08/17	AP	PER ENGINEER LETTER
B104 02	10/06/17	JB	R*FOUND & SETBACK VERIF SURVEY TIME: 17:00 VRU #: 003035243
	10/06/17	AP	
R425 01	10/09/17	TSG	FOUR TRADE ROUGH IN TIME: 17:00 VRU #: 003035250
	10/09/17	DA	T/S: 10/06/2017 09:08 AM JBROCK FRAMER WORKING ON HOUSE ,,NOT READY
R425 02	10/10/17	JH	FOUR TRADE ROUGH IN TIME: 17:00 VRU #: 003036357
	10/10/17	DP	T/S: 10/09/2017 01:29 PM JBROCK 1) Plug joints 4' from corners. 2) Seal hole in air barrier under stairs on garage wall. 3) Need engineer letter for holes drilled in 2ply lvls in laundry room & half bath. 4) 100 psi on water line test. 5) Anchor all interior load bearing walls per code. 6) Missing T2 hold down straps per plans. 7) Install porch post per plans. 8) Fasten toilet flanges per code. 9) Fire block top plate over toilet in half bath. 10) 6 studs under each end of 4ply lvls in kitchen per plans. 11) Fire caulk hole in top plate at frig. 12) Missing nails in floor truss hanger on 4 ply lvl at back wall in kitchen. 13) 5 studs under 3ply lvls in living room to left of fire box. 14) Need engineer letter for over bored studs to right of fire box. 15) Nail air barrier in chas in front bed closet upstairs every 24" per code. 16) 10 psi on gas line test.

DO NOT INSULATE OK TO SIDE

CONTINUED ONTO NEXT PAGE

PREPARED 10/17/17, 14:16:54
Harnett County

INSPECTION TICKET
INSPECTOR: IVR

PAGE 31
DATE 10/18/17

ADDRESS : 135 HEATHERWOOD DR
CONTRACTOR :
OWNER : MCKEE HOMES LLC
PARCEL : 03-9589-01- -1021- -10-
APPL NUMBER: 17-50041778 CP NEW RESIDENTIAL (SFD)

SUBDIV: OAKMONT PH 2 SECT 1 30LTS
PHONE :
PHONE :

TYP/SQ	REQUESTED COMPLETED	INSP RESULT	DESCRIPTION RESULTS/COMMENTS
R425 03	10/18/17	SI AI	FOUR TRADE ROUGH IN TIME: 17:00 VRU #: 003040292 T/S: 10/17/2017 10:04 AM JBROCK

COMMENTS AND NOTES

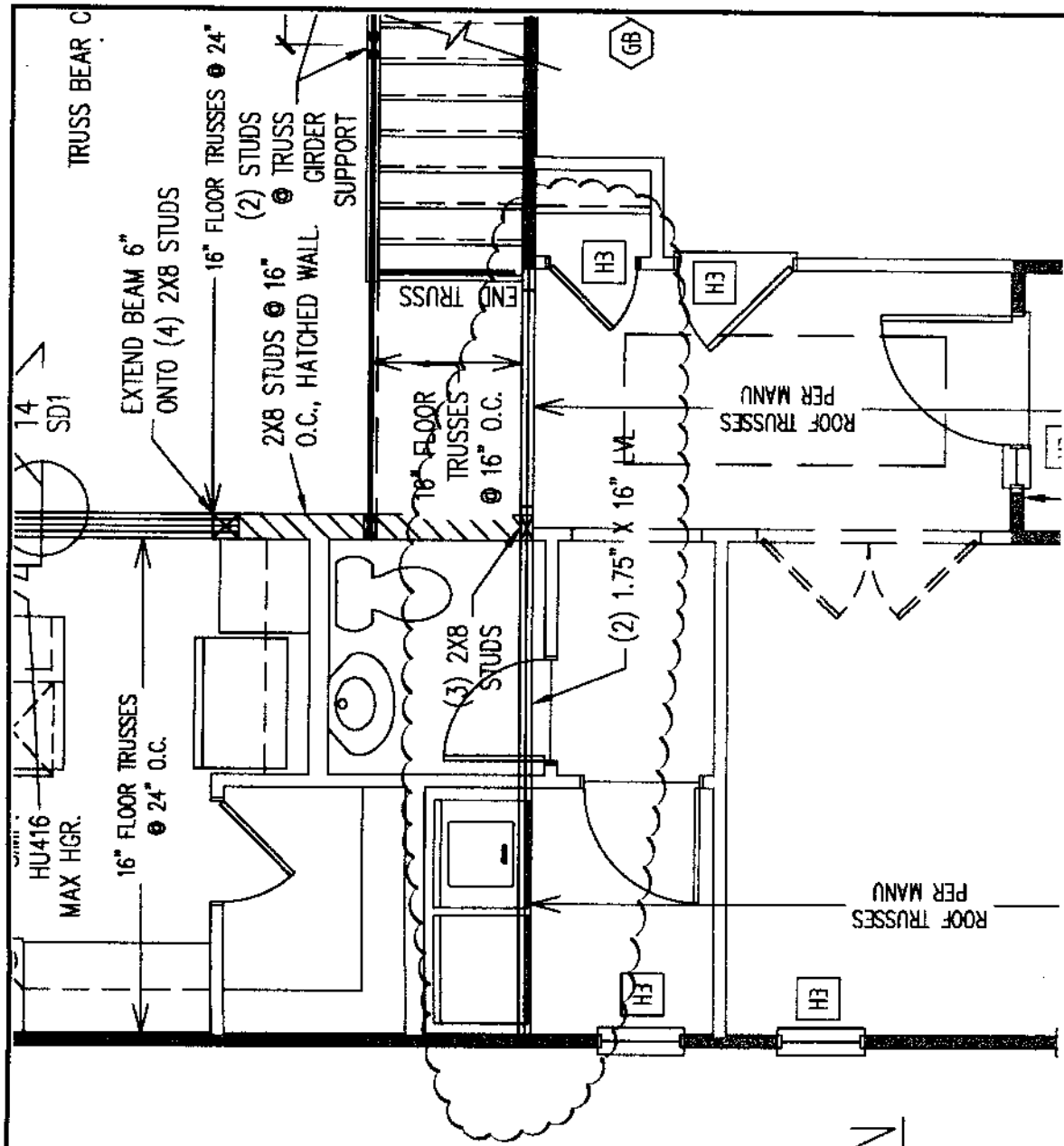

(5) SMALL HOLES DRILLED IN TOP OF LVL FOR WIRING. ENGINEER HAS VERIFIED THAT BEAM IS STILL SUFFICIENT FOR ORIGINALLY DESIGNED LOADS. NO CORRECTIVE ACTION REQUIRED

1ST FLOOR FRAMING PLAN

WALLS AND CEILING

1/4" = 1'-0"

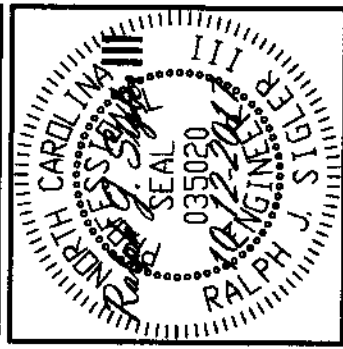

Engineering
Lech
ASSOCIATES, P.A.
 STRUCTURAL ENGINEERS
 License No. C-3870
 183 Wind Chime Court, Suite 100
 Raleigh, North Carolina 27615
 (919) 844-1661 Fax (919) 844-1665

CLIENT:	MCKEE HOMES, INC.
SCOPE:	HOLES DRILLED IN BEAM
LOT #:	78 OAKMONT VALLEY VIEW
ENG:	RS/DTN
REV:	
DATE:	10-12-2017

PARENT NO.
16-29-026

PROJECT NO.
17-75-822

SHEET NO.
S1

1 of 1

P3 BEAM CONNECTION

Hanger shall apply load equally to each ply or special design required

P4 STEEL COLUMN & WOOD COLUMN

Framing details such as joists and sheathing shall be provided to prevent beam from twisting or rotating at support

P6 FLOOR BEAM (Flush ceiling)

Top mount hangers recommended

Check stiffener/filler requirements depending on load and hanger type

Prevent the beam from rotating by using rim or blocking

P7 CONCRETE WALL

NOTE: Protect wood from contact with concrete as required by code

Simpson GLB, USP LBS or equal seat

Q1 WINDOW/DOOR HEADER

Rim Board

Provide specified or prescriptive bearing length

Q2 WINDOW/DOOR HEADER

Continuous plate

Provide specified or prescriptive bearing length

BEAM HOLE DETAILS

1 foot

Minimum 2 x diameter of larger hole

1 foot

1/3 beam depth

Area B

Area A

Area B

1/3 span length

Clear span

Q4 MASONRY HANGER

Simpson WM, USP MPH, or equal hanger

NOTE: Protect wood from contact with concrete as required by code

- NOTES:**
1. These guidelines apply to uniformly loaded beams selected from the Quick Reference Tables or the Uniform Load Tables or designed with LP's design/specification software only. For all other applications, such as beams with concentrated loads, please contact your LP® SolidStart® Engineered Wood Products distributor for assistance.
 2. Round holes can be drilled anywhere in "Area A" provided that: no more than four holes are cut, with the minimum spacing described in the diagram. The maximum hole size is 1-1/2" for depths up to 9-1/4", and 2" for depths greater than 9-1/4".
 3. Rectangular holes are NOT allowed.
 4. DO NOT drill holes in cantilevers without prior approval from the project designer.
 5. Other hole sizes and configurations MAY be possible with further engineering analysis. For more information, contact your LP SolidStart Engineered Wood Products distributor.
 6. Up to three 3/4" holes may be drilled in "Area B" to accommodate wiring and/or water lines. These holes shall be at least 12" apart. The holes shall be located in the middle third of the depth, or a minimum of 3" from the bottom and top of the beam. For beams shallower than 9-1/4", locate holes at mid-depth.
 7. Protect plumbing holes from moisture.