

**SOIL/SITE EVALUATION  
 for ON-SITE WASTEWATER SYSTEM**

Owner: — Applicant: *Alexis James*  
 Address: *Lot 23 Cottleston Rd* Date Evaluated: *02/28/17*  
 Proposed Facility: *432 SFD* Design Flow (.1949): *480 GPD* Property Size: *0.56 AC*  
 Location of Site: Property Recorded: *Yes*  
 Water Supply:  Public  Individual  Well  Spring  Other  
 Evaluation Method:  Auger Boring  Pit  Cut  
 Type of Wastewater:  Sewage  Industrial Process  Mixed

P R O F I L E #	.1940 Landscape Position/ Slope %	Horizon Depth (In.)	SOIL MORPHOLOGY .1941		OTHER PROFILE FACTORS				Profile Class & LTAR
			.1941 Structure/ Texture	.1941 Consistence Mineralogy	.1942 Soil Wetness/ Color	.1943 Soil Depth (IN.)	.1956 Sapro Class	.1944 Restr Horiz	
1	L 1%	0-12	GR SL	FA SSSP Sep					PS
		12-48	GR SCL	FI S P Sep		48			0.4
2	L 1%	0-10	GR SL	FA SSSP Sep					PS
		10-48	GR SCL	FI S P Sep		48			0.4
3	L 1%	0-12	GR SL	FA SSSP Sep					PS
		12-40	GR SCL	FI S P Sep					PS
		40+	Passive mud.	—		40			0.4

Description	Initial System	Repair System	Other Factors (.1946): Site Classification (.1948): <i>Provisionally Suitable</i> Evaluated By: <i>Andrew Curnin, RCHS</i> Others Present:
Available Space (.1945)	<i>25% Red</i>	<i>25% Red</i>	
System Type(s)	<i>25% Red</i>	<i>25% Red</i>	
Site LTAR	<i>0.4</i>	<i>0.4</i>	

COMMENTS: \_\_\_\_\_

LANDSCAPE POSITIONS	GROUP	TEXTURES	.1955 LTAR	CONSISTENCE MOIST	WET
R-RIDGE	I	S-SAND	1.2 - 0.8	VFR-VERY FRIABLE FR-FRIABLE	NS-NON-STICKY SS-SLIGHTLY STICKY
S-SHOULDER SLOPE L-LINEAR SLOPE		LS-LOAMY SAND			
FS-FOOT SLOPE	II	SL-SANDY LOAM	0.8 - 0.6	FI-FIRM VFI-VERY FIRM EFI-EXTREMELY FIRM	S-STICKY VS-VERY STICKY NP-NON-PLASTIC
N-NOSE SLOPE H-HEAD SLOPE		L-LOAM			
CC-CONCLAVE SLOPE	III	SI-SILT	0.6 - 0.3		SP-SLIGHTLY STICKY P-PLASTIC VP-VERY PLASTIC
CV-CONVEX SLOPE		SIL-SILT LOAM			
T-TERRACE		CL-CLAY LOAM			
FP-FLOOD PLAN		SCL-SANDY CLAY LOAM			
	IV	SIC-SILTY CLAY C-CLAY SC-SANDY CLAY	0.4 - 0.1		

STRUCTURE  
 SG-SINGLE GRAIN  
 M-MASSIVE  
 CR-CRUMB  
 GR-GRANULAR  
 SBK-SUBANGULAR BLOCKY  
 ABK-ANGULAR BLOCKY  
 PL-PLATY  
 PR-PRISMATIC

MINERALOGY  
 SLIGHTLY EXPANSIVE  
 EXPANSIVE

Show profile locations and other site features (dimensions, references or benchmark, and North)



← CONTOUR →

LOT 24

LOT 27

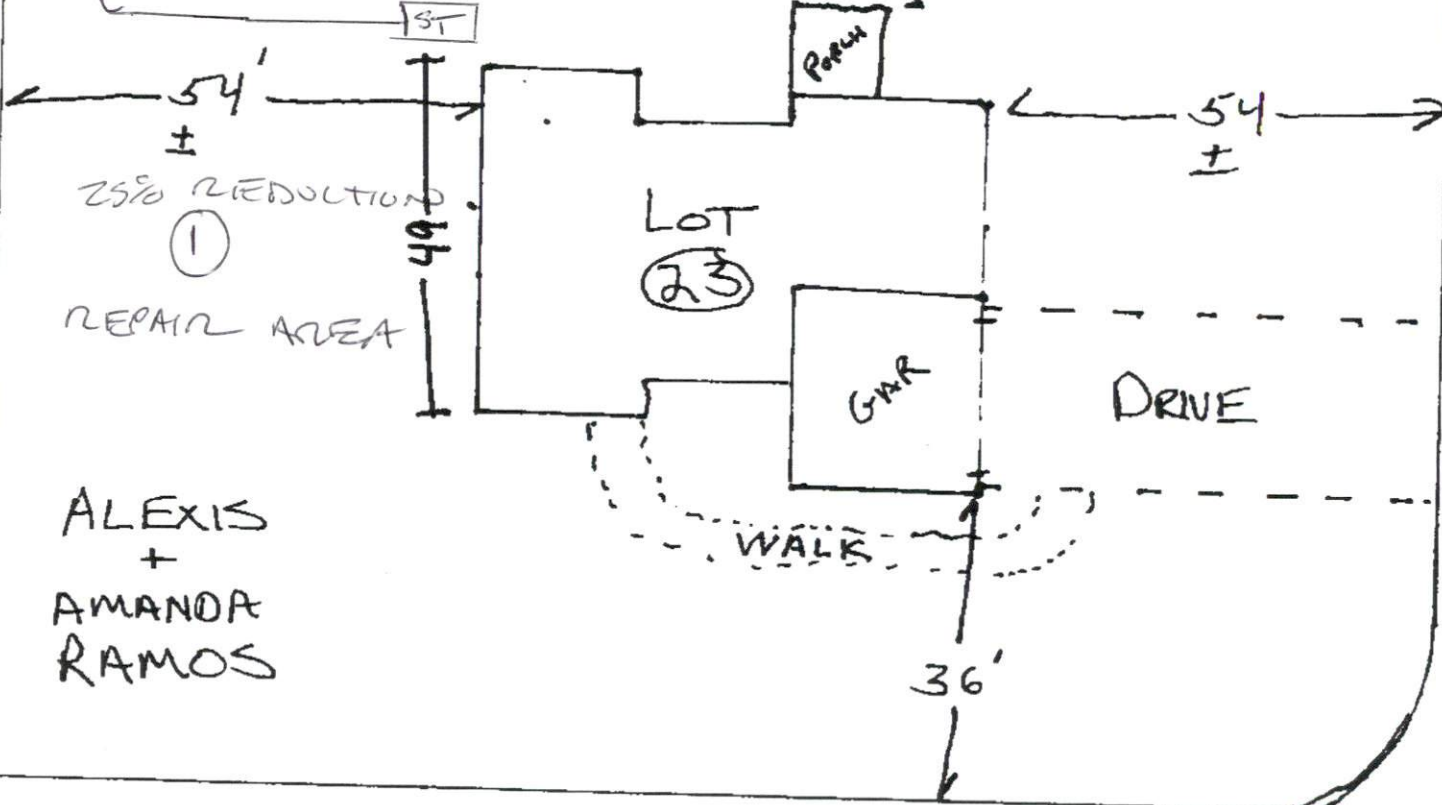
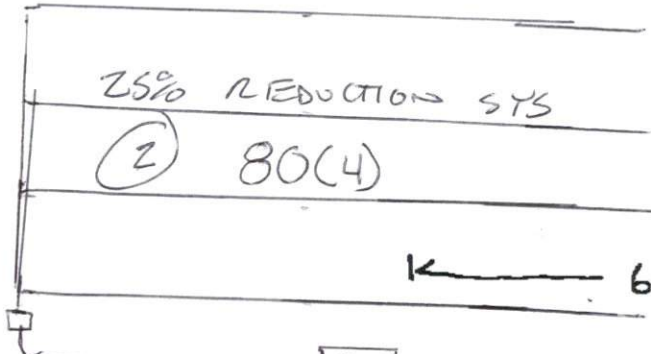

ALEXIS + AMANDA RAMOS

SITE PLAN APPROVAL

DISTRICT: RA-40 USE: SFD

#BEDROOMS: 4

DATE: 6/15/17

ZONING ADMINISTRATOR

VIC McLOUD COURT

\* bin fall down from back to front

275 COTTLE LAKE DRIVE