

HTE# 17-5-41619

# Harnett County Department of Public Health

29559

## Improvement Permit

A building permit cannot be issued with only an Improvement Permit

ISSUED TO: Signature Homes Builders PROPERTY LOCATION: Moan Rd (SR 1863)  
 NEW  REPAIR  EXPANSION  SUBDIVISION \_\_\_\_\_ LOT # 3  
 Type of Structure: 4BR SFD (55'x50') Site Improvements required prior to Construction Authorization Issuance: \_\_\_\_\_  
 Proposed Wastewater System Type: 25% Reduction Sys.  
 Projected Daily Flow: 480 GPD  
 Number of bedrooms: 4 Number of Occupants: 8 max  
 Basement  Yes  No  
 Pump Required:  Yes  No  May be required based on final location and elevations of facilities  
 Type of Water Supply:  Community  Public  Well Distance from well \_\_\_\_\_ feet Permit valid for:  Five years  
 Permit conditions: \_\_\_\_\_  No expiration

Authorized State Agent: [Signature] Date: 07/10/2017 SEE ATTACHED SITE SKETCH  
 The issuance of this permit by the Health Department in no way guarantees the issuance of other permits. The permit holder is responsible for checking with appropriate governing bodies in meeting their requirements. This site is subject to revocation if the site plan, plat, or the intended use changes. The Improvement Permit shall not be affected by a change in ownership of the site. This permit is subject to compliance with the provisions of the Laws and Rules for Sewage Treatment and Disposal and to conditions of this permit.

## Construction Authorization

(Required for Building Permit)

The construction and installation requirements of Rules .1950, .1952, .1954, .1955, .1956, .1957, .1958, and .1959 are incorporated by references into this permit and shall be met. Systems shall be installed in accordance with the attached system layout.

ISSUED TO: Signature Homes Builders PROPERTY LOCATION: Moan Rd (SR 1853)  
 SUBDIVISION \_\_\_\_\_ LOT # 3  
 Facility Type: 4BR SFD (55'x50')  New  Expansion  Repair  
 Basement?  Yes  No Basement Fixtures?  Yes  No  
 Type of Wastewater System\*\* 25% reduction system (Initial) Wastewater Flow: 480 GPD  
 (See note below, if applicable  AT-GRABIE  
25% reduction system (Repair)  
**Installation Requirements/Conditions**  
 Septic Tank Size 1250 gallons Number of trenches 5  
 Pump Tank Size \_\_\_\_\_ gallons Exact length of each trench 60 feet Trench Spacing: 9 Feet on Center  
 Trenches shall be installed on contour at a Soil Cover: 8 inches  
 Maximum Trench Depth of: 20 inches (Maximum soil cover shall not exceed 36" above the trench bottom)  
 (Trench bottoms shall be level to +/-1/4" in all directions)  
 Pump Requirements: \_\_\_\_\_ ft. TDH vs. \_\_\_\_\_ GPM Aggregate Depth: 6 inches below pipe  
 \_\_\_\_\_ 2 inches above pipe  
 \_\_\_\_\_ 12 inches total

**WATER LINES (INCLUDING IRRIGATION) MUST BE 10FT. FROM ANY PART OF SEPTIC SYSTEM OR REPAIR AREA. NO UTILITIES ALLOWED IN INITIAL OR REPAIR DRAIN FIELD AREA.**

*\*\*If applicable: I understand the system type specified is different from the type specified on the application. I accept the specifications of this permit.*

Owner/Legal Representative Signature: \_\_\_\_\_ Date: \_\_\_\_\_

This Construction Authorization is subject to revocation if the site plan, plat, or the intended use changes. The Construction Authorization shall not be transferred when there is a change in ownership of the site. This Construction Authorization is subject to compliance with the provisions of the Laws and Rules for Sewage Treatment and Disposal and to the conditions of this permit. SEE ATTACHED SITE SKETCH

Authorized State Agent: [Signature] Date: 07/10/2017  
 Construction Authorization Expiration Date: 07/10/2022

HTE# 17-5-41619

Permit # 29559

# Harnett County Department of Public Health Site Sketch

ISSUED TO: Signature Home Bldg PROPERTY LOCATOR: Mann Rd. (SR 1853)  
SUBDIVISION \_\_\_\_\_ LOT # 3

Authorized State Agent: [Signature] Date: 07/10/2017

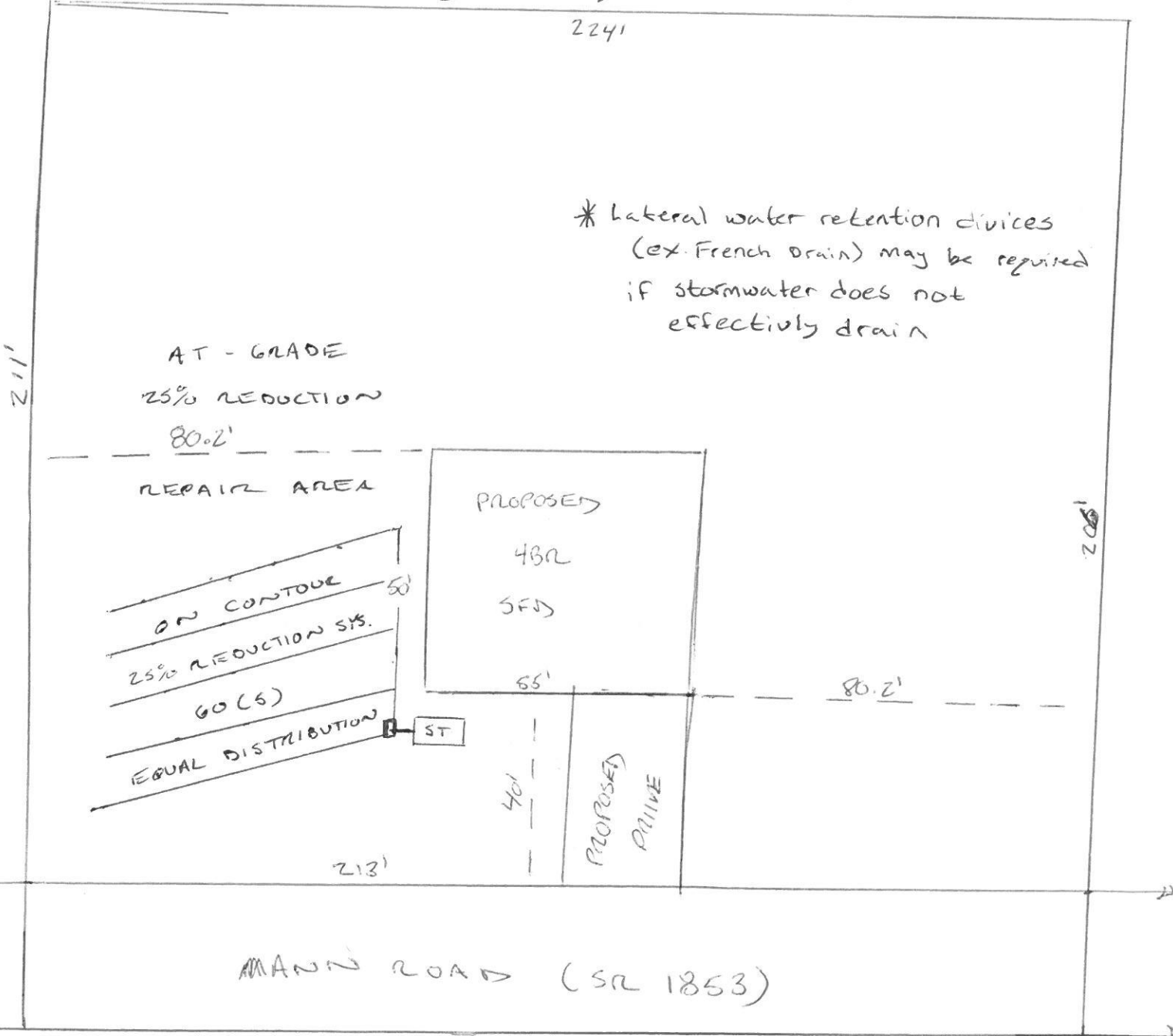

\* 4 750E lines may be used if space is available

**SOIL/SITE EVALUATION  
 for ON-SITE WASTEWATER SYSTEM**

Owner: \_\_\_\_\_ Applicant: Manna Rd.  
 Address: Signature Here Bldg Date Evaluated: 06/26/17  
 Proposed Facility: 432 SFD Design Flow (.1949): 480 GPD Property Size: 1.05 AC  
 Location of Site: \_\_\_\_\_ Property Recorded: \_\_\_\_\_  
 Water Supply:  Public  Individual  Well  Spring  Other  
 Evaluation Method:  Auger Boring  Pit  Cut  
 Type of Wastewater:  Sewage  Industrial Process  Mixed

P R O F I L E #	.1940 Landscape Position/ Slope %	Horizon Depth (In.)	SOIL MORPHOLOGY		OTHER PROFILE FACTORS				Profile Class & LTAR
			.1941		.1942 Soil Wetness/ Color	.1943 Soil Depth (IN.)	.1956 Sapro Class	.1944 Restr Horiz	
			.1941 Structure/ Texture	.1941 Consistence Mineralogy					
1	L 2%	0-12	GL SL	FL SSS Ksp					PS
		12-40	BK SLL	FI SP Ssp	7.5% @ 36"	40			0.4
2,3	L 2%	0-10	GL SL	FL SSS Ksp					U/PS
		10-40	BK SLL	FI SP Ssp	7.5% @ 34"	40			0.4
4	L 2%	0-12	GL SL	FL SSS Ksp					U/PS
		12-40	BK SLL	FI SP Ssp	7.5% @ 30"	40			0.4
5	L 2%	0-8	GL SL	FL SSS Ksp					PS
		8-40	BK SLL	FI SP Ssp	7.5% @ 38"	40			0.4

Description	Initial System	Repair System	Other Factors (.1946): Site Classification (.1948): <u>Unsuitable/Provisionally Suitable</u> Evaluated By: <u>Andrew Curran, REHS</u> Others Present: _____
Available Space (.1945)	<u>✓</u>	<u>✓</u>	
System Type(s)	<u>25% Red</u>	<u>25% Red</u>	
Site LTAR	<u>0.4</u>	<u>0.4</u>	