

Improvement Permit

A building permit cannot be issued with only an Improvement Permit

ISSUED TO: Wynn Construction Inc. PROPERTY LOCATION: 51429 Chalybeate RD. SUBDIVISION: Avery Pond LOT # 42. Includes checkboxes for NEW, REPAIR, EXPANSION, and various permit conditions.

Authorized State Agent: James E. Markham Date: 6-13-17 SEE ATTACHED SITE SKETCH. The issuance of this permit by the Health Department in no way guarantees the issuance of other permits.

Construction Authorization (Required for Building Permit)

The construction and installation requirements of Rules .1950, .1952, .1954, .1955, .1956, .1957, .1958, and .1959 are incorporated by references into this permit and shall be met.

ISSUED TO: Wynn Construction Inc. PROPERTY LOCATION: 51429 Chalybeate RD. SUBDIVISION: Avery Pond LOT # 42. Facility Type: SFD. Includes checkboxes for New, Expansion, Repair.

Installation Requirements/Conditions. Septic Tank Size: 1200 gallons. Pump Tank Size: 1200 gallons. Number of trenches: 6. Trench Spacing: 2 feet on center. Aggregate Depth: 12 inches total.

WATER LINES (INCLUDING IRRIGATION) MUST BE 10FT. FROM ANY PART OF SEPTIC SYSTEM OR REPAIR AREA. NO UTILITIES ALLOWED IN INITIAL OR REPAIR DRAIN FIELD AREA.

\*\*If applicable: I understand the system type specified is different from the type specified on the application. I accept the specifications of this permit.

Owner/Legal Representative Signature: \_\_\_\_\_ Date: \_\_\_\_\_

This Construction Authorization is subject to revocation if the site plan, plat, or the intended use changes. SEE ATTACHED SITE SKETCH

Authorized State Agent: James E. Markham Date: 6-13-17 Construction Authorization Expiration Date: 6-13-22

HTE# 17-5-41490

Permit # 29392

# Harnett County Department of Public Health Site Sketch

PROPERTY LOCATOR: 501429 Chalybeate Rd

ISSUED TO: Wynn Construction Inc SUBDIVISION Avery Pond LOT # 42

Authorized State Agent: James E. Mahan Date: 6-13-17

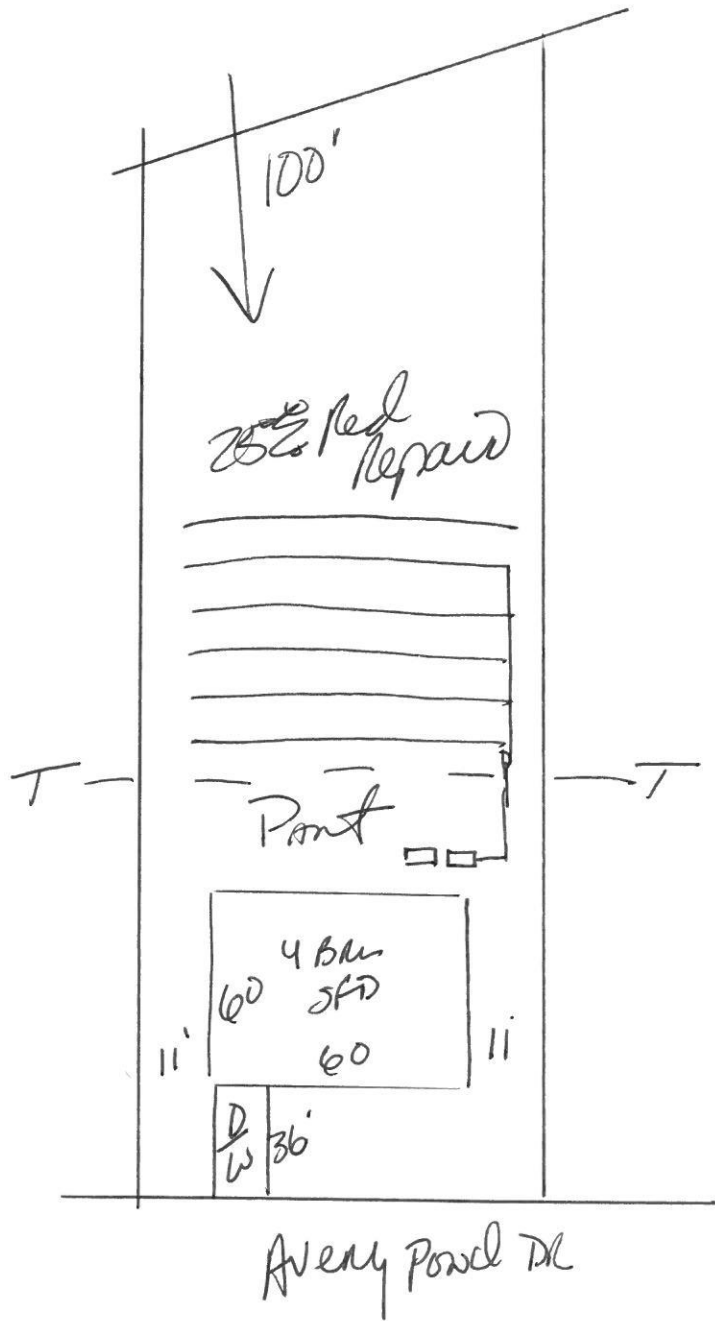

**SOIL/SITE EVALUATION  
 for ON-SITE WASTEWATER SYSTEM**

Owner: Applicant: *WYNN*  
 Address: Date Evaluated: *6-6-17*  
 Proposed Facility: *SFD* Design Flow (.1949): *400* Property Size:  
 Location of Site: Property Recorded:  
 Water Supply:  Public  Individual  Well  Spring  Other  
 Evaluation Method:  Auger Boring  Pit  Cut  
 Type of Wastewater:  Sewage  Industrial Process  Mixed

P R O F I L E #	.1940 Landscape Position/ Slope %	Horizon Depth (In.)	SOIL MORPHOLOGY .1941		OTHER PROFILE FACTORS				Profile Class & LTAR
			.1941 Structure/ Texture	.1941 Consistence Mineralogy	.1942 Soil Wetness/ Color	.1943 Soil Depth (IN.)	.1956 Sapro Class	.1944 Restr Horiz	
<i>1</i>	<i>T-45</i>	<i>0-36</i>	<i>SL</i>	<i>FLGANDNP</i>					
		<i>36-48</i>	<i>SL silty</i>	<i>FLGANDNP</i>	<i>46" 75% 2.1</i>				<i>.3</i>
<i>2.3</i>	<i>T-45</i>	<i>0-24</i>	<i>SL</i>	<i>FLGANDNP</i>					
		<i>24-48</i>	<i>SL silty</i>	<i>FLGANDNP</i>	<i>42" 75% 2.1</i>				<i>.3</i>

Description	Initial System <input checked="" type="checkbox"/>	Repair System <input checked="" type="checkbox"/>	Other Factors (.1946):
Available Space (.1945)			Site Classification (.1948):
System Type(s)	<i>2.3</i>	<i>2.3</i>	Evaluated By: <i>[Signature]</i>
Site LTAR	<i>2.3</i>	<i>.3</i>	Others Present: