

HTE# 17-5-41020

# Harnett County Department of Public Health

29377

## Improvement Permit

A building permit cannot be issued with only an Improvement Permit

ISSUED TO: Wynn Construction Inc PROPERTY LOCATION: 511429 Chalybeate RD  
 NEW  REPAIR  EXPANSION  SUBDIVISION: Avery Road LOT # 63  
 Type of Structure: SFD Site Improvements required prior to Construction Authorization Issuance:  
 Proposed Wastewater System Type: 25% reduction  
 Projected Daily Flow: 480 GPD  
 Number of bedrooms: 4 Number of Occupants: 8 max  
 Basement  Yes  No  
 Pump Required:  Yes  No  May be required based on final location and elevations of facilities  
 Type of Water Supply:  Community  Public  Well Distance from well \_\_\_\_\_ feet Permit valid for:  Five years  
 Permit conditions: \_\_\_\_\_  No expiration

Authorized State Agent: James E. Markon Date: 4-25-17 SEE ATTACHED SITE SKETCH  
 The issuance of this permit by the Health Department in no way guarantees the issuance of other permits. The permit holder is responsible for checking with appropriate governing bodies in meeting their requirements. This site is subject to revocation if the site plan, plat, or the intended use changes. The Improvement Permit shall not be affected by a change in ownership of the site. This permit is subject to compliance with the provisions of the Laws and Rules for Sewage Treatment and Disposal and to conditions of this permit.

## Construction Authorization

(Required for Building Permit)

The construction and installation requirements of Rules .1950, .1952, .1954, .1955, .1956, .1957, .1958, and .1959 are incorporated by references into this permit and shall be met. Systems shall be installed in accordance with the attached system layout.

ISSUED TO: Wynn Construction Inc PROPERTY LOCATION: 511429 Chalybeate RD  
 Facility Type: SFD  New  Expansion  Repair  
 Basement?  Yes  No Basement Fixtures?  Yes  No  
 Type of Wastewater System\*\* Pup to 25% reduction (Accepted) (initial) Wastewater Flow: 480 GPD  
 (See note below, if applicable)  Pup to 25% reduction (Repair)  
 Installation Requirements/Conditions  
 Septic Tank Size 1200 gallons Exact length of each trench 100 feet Trench Spacing: 9 Feet on Center  
 Pump Tank Size 1200 gallons Trenches shall be installed on contour at a Soil Cover: 6 inches  
 Maximum Trench Depth of: 22-718 inches (Maximum soil cover shall not exceed 36" above the trench bottom)  
 (Trench bottoms shall be level to +/-1/4" in all directions)  
 Pump Requirements: \_\_\_\_\_ ft. TDH vs. \_\_\_\_\_ GPM Aggregate Depth: 6 inches below pipe  
 Conditions: \_\_\_\_\_ 2 inches above pipe  
12 inches total

**WATER LINES (INCLUDING IRRIGATION) MUST BE 10FT. FROM ANY PART OF SEPTIC SYSTEM OR REPAIR AREA.  
NO UTILITIES ALLOWED IN INITIAL OR REPAIR DRAIN FIELD AREA.**

\*\*If applicable: I understand the system type specified is different from the type specified on the application. I accept the specifications of this permit.

Owner/Legal Representative Signature: \_\_\_\_\_ Date: \_\_\_\_\_

This Construction Authorization is subject to revocation if the site plan, plat, or the intended use changes. The Construction Authorization shall not be transferred when there is a change in ownership of the site. This Construction Authorization is subject to compliance with the provisions of the Laws and Rules for Sewage Treatment and Disposal and to the conditions of this permit. SEE ATTACHED SITE SKETCH

Authorized State Agent: James E. Markon Date: 4-25-17  
 Construction Authorization Expiration Date: 4-25-22

HTE# 17-5-41020

Permit # 29377

# Harnett County Department of Public Health Site Sketch

ISSUED TO: Wynn Construction Inc PROPERTY LOCATION: 511429 Chalybeate RD  
SUBDIVISION: Avery Pond LOT # 63

Authorized State Agent: James E. Manhart DATE: 4-25-07

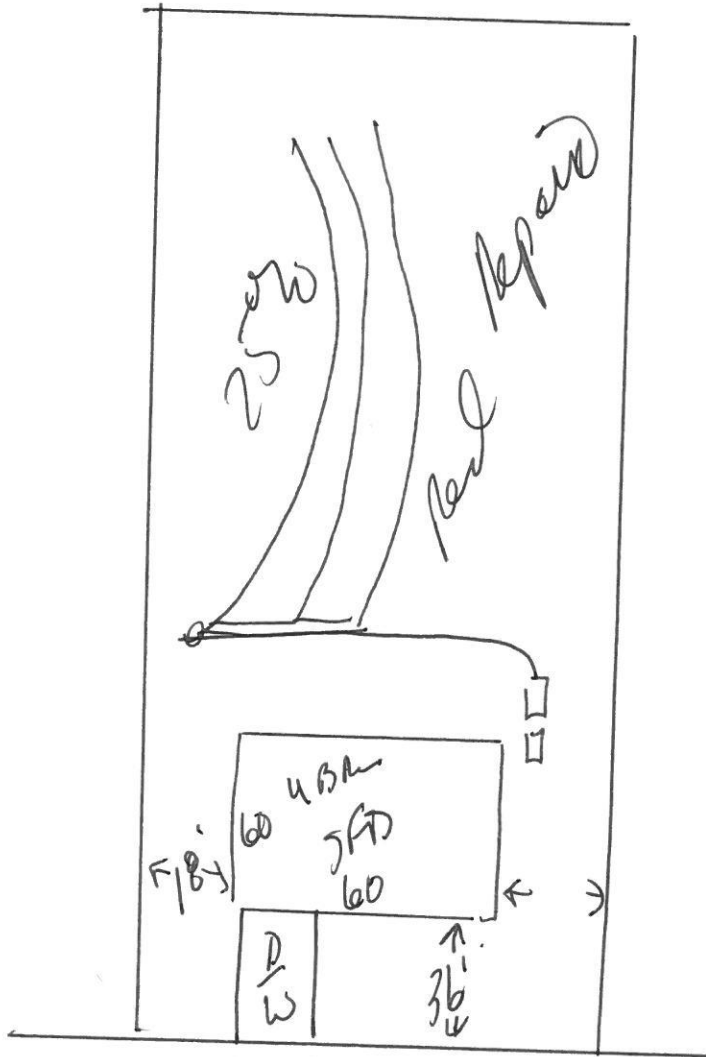

Avery Pond DR

