

Initial Application Date: 01/20/17

AU-36

Application # 1750040975
CU# _____

COUNTY OF HARNETT RESIDENTIAL LAND USE APPLICATION

Central Permitting 108 E. Front Street, Lillington, NC 27546 Phone: (910) 893-7525 ext:2 Fax: (910) 893-2793 www.harnett.org/permits

****A RECORDED SURVEY MAP, RECORDED DEED (OR OFFER TO PURCHASE) & SITE PLAN ARE REQUIRED WHEN SUBMITTING A LAND USE APPLICATION****

LANDOWNER: Royal Oaks Building Group, LLC Atkins Village LLC Mailing Address: 1210 Trinity Road, Suite 102

City: Raleigh State: NC Zip: 27607 Contact No: 919-233-3886 Email: jmxoley@royaloakshomes.com

APPLICANT*: Royal Oaks Building Group Mailing Address: 1210 Trinity Road

City: Raleigh State: NC Zip: 27607 Contact No: 919-233-3886 Email: jmxoley@royaloakshomes.com

*Please fill out applicant information if different than landowner

CONTACT NAME APPLYING IN OFFICE: John Moxley Phone # 919-233-3886 / 321

PROPERTY LOCATION: Subdivision: Atkin's Village Lot #: 36 Lot Size: 1.21

State Road # 17 State Road Name: Afton Court Map Book & Page: 2017 / 38

Parcel: 040664-0020-38 PIN: 0664-67-8487.000

Zoning: RA30 Flood Zone: N/A Watershed: N/A Deed Book & Page: 3285 / 570 Power Company*: South River

*New structures with Progress Energy as service provider need to supply premise number _____ from Progress Energy.

PROPOSED USE:

SFD: (Size 55' x 42') # Bedrooms: 3 # Baths: 3.5 Basement(w/wo bath): _____ Garage: Deck: Crawl Space: Slab: _____ Slab: _____
(Is the bonus room finished? () yes () no w/ a closet? () yes () no (if yes add in with # bedrooms)

Mod: (Size _____ x _____) # Bedrooms _____ # Baths _____ Basement (w/wo bath) _____ Garage: _____ Site Built Deck: _____ On Frame _____ Off Frame _____
(Is the second floor finished? () yes () no Any other site built additions? () yes () no

Manufactured Home: _____ SW _____ DW _____ TW (Size _____ x _____) # Bedrooms: _____ Garage: _____ (site built? _____) Deck: _____ (site built? _____)

Duplex: (Size _____ x _____) No. Buildings: _____ No. Bedrooms Per Unit: _____

Home Occupation: # Rooms: _____ Use: _____ Hours of Operation: _____ #Employees: _____

Addition/Accessory/Other: (Size _____ x _____) Use: _____ Closets in addition? () yes () no

Water Supply: County _____ Existing Well _____ New Well (# of dwellings using well _____) *Must have operable water before final

Sewage Supply: New Septic Tank (Complete Checklist) _____ Existing Septic Tank (Complete Checklist) _____ County Sewer

Does owner of this tract of land, own land that contains a manufactured home within five hundred feet (500') of tract listed above? () yes () no

Does the property contain any easements whether underground or overhead () yes () no

Structures (existing or proposed): Single family dwellings: New Home Manufactured Homes: _____ Other (specify): _____

Required Residential Property Line Setbacks:

Front	Minimum	<u>35'</u>	Actual	<u>36.6'</u>
Rear		<u>25'</u>		<u>>25'</u>
Closest Side		<u>10'</u>		<u>29.5'</u>
Sidestreet/corner lot		<u>20'</u>		<u>32'</u>
Nearest Building on same lot				

Comments: House size changed
of Bedrooms changed

SPECIFIC DIRECTIONS TO THE PROPERTY FROM LILLINGTON: North on 401; Right onto Rawls Church Road; Right onto Atkins road
left onto Atkins Village Court

If permits are granted I agree to conform to all ordinances and laws of the State of North Carolina regulating such work and the specifications of plans submitted. I hereby state that foregoing statements are accurate and correct to the best of my knowledge. Permit subject to revocation if false information is provided.

John Mosley
Signature of Owner or Owner's Agent

6/12/2017
Date

It is the owner/applicants responsibility to provide the county with any applicable information about the subject property, including but not limited to: boundary information, house location, underground or overhead easements, etc. The county or its employees are not responsible for any incorrect or missing information that is contained within these applications.

This application expires 6 months from the initial date if permits have not been issued

PLOT PLAN FOR
ROYAL OAKS BUILDING GROUP, LLC

17 AFTON COURT
 LOT 36, ATKINS VILLAGE, PHASE THREE
 BLACK RIVER TOWNSHIP, HARNETT COUNTY, NORTH CAROLINA

STUART ADAMS HAIR AND CATHY TAYLOR HAIR
 DB 1419, PG 693
 DB 1448, PG 394
 DB 1654, PG 834
 DB 2128, PG 476
 MAP NO. 2000, PG 325
 MAP NO. 2000, PG 624
 MAP NO. 2002, PG 953
 MAP NO. 2005, PG 713

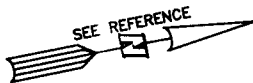

N02°41'22"E 148.36'

N77°50'11"W 425.11'

SETBACK LINES

36
 1.23 AC.

S71°57'05"E 451.92'

35

LEGEND

- BFP BACK FLOW PREVENTER
- CURB INLET
- CLEANOUT
- ECM EXISTING CONCRETE MONUMENT
- EDH EXISTING DRILL HOLE
- EIS EXISTING IRON STAKE
- EIP EXISTING IRON PIPE
- EM ELECTRIC METER
- EPK EXISTING PK NAIL
- ES ELECTRIC STUB
- FLARED END SECTION
- FIRE HYDRANT
- FO FIBER OPTIC PEDESTAL
- GM GAS METER
- INV. INVERT
- LIGHT POLE
- ⊗ MANHOLE SANITARY SEWER
- NDH NEW DRILL HOLE
- NIP NEW IRON PIPE
- NPK NEW PK NAIL
- OHW OVERHEAD WIRES
- PNS POINT NOT SET
- PUE PUBLIC UTILITY EASEMENT
- TBC TOP BACK of CURB
- TELEPHONE PEDESTAL
- TRANSFORMER
- CABLE TV PEDESTAL
- UTILITY POLE
- WATER METER
- WATER VALVE
- YARD INLET
- () FIELD MEASUREMENT

37

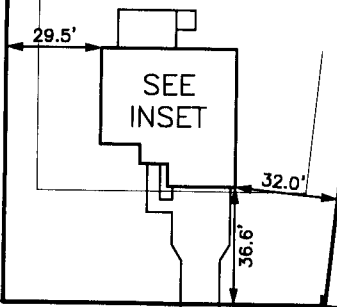

S12°09'49"W 99.06' C1

AFTON COURT
 50' PUBLIC R/W

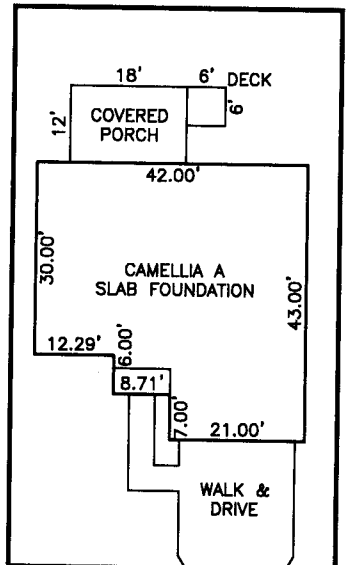

INSET SCALE: 1"=30'

SETBACK INFO

FRONT: _____ 35'
 REAR: _____ 25'
 SIDES: _____ 10'

REFERENCES:

B.M. 2017, PG. 38-39

IMPERVIOUS SURFACE TABLE

HOUSE.....	1,590 S.F.
PORCH.....	220 S.F.
DECK.....	40 S.F.
WALK & DRIVE.....	640 S.F.
TOTAL IMPERVIOUS.....	2,490 S.F.

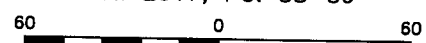

SITE PLAN APPROVAL