

AS-BUILT IMPROVEMENTS FOR
ROYAL OAKS BUILDING GROUP, LLC
 24 AFTON COURT
 LOT 33, ATKINS VILLAGE, PHASE THREE
 BLACK RIVER TOWNSHIP, HARNETT COUNTY, NORTH CAROLINA

ATKINS ROAD
 60' PUBLIC R/W

L1 S12°37'29"E 75.98' C1
 10'x70' SIGHT TRIANGLE

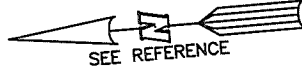

NUMBER	RADIUS'	DELTA	ARC'	CHORD BRG.	CHORD'
C1	25.00	102°09'57"	44.58	S38°27'30"W	38.90
C2	255.00	16°57'30"	75.47	S81°03'43"W	75.20
C3	205.00	13°27'12"	48.13	S79°18'34"W	48.02
C4	25.00	106°07'39"	46.31	N40°54'02"W	39.97
C5	35.00	65°41'03"	40.12	N45°00'21"E	37.96
C6	50.00	92°04'50"	80.36	N31°48'27"E	71.98

NUMBER	DIRECTION	DISTANCE
L1	S12°38'37"E	20.62'

20' DRAINAGE EASEMENT
 SETBACK LINES
 S89°10'48"E 322.36'
 S89°32'28"W 373.18'

(34)
 (33)
 1.438 AC.

WELLS OAKS DRIVE
 50' PUBLIC R/W

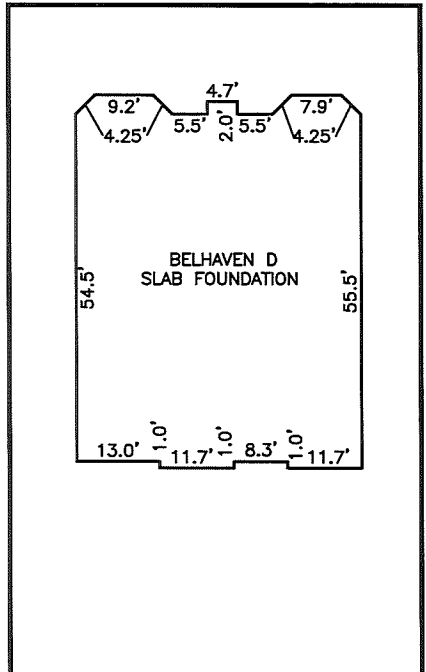

INSET: SCALE: 1"=30'

LEGEND

- BFP BACK FLOW PREVENTER
- CI CURB INLET
- CO CLEANOUT
- ECM EXISTING CONCRETE MONUMENT
- EDH EXISTING DRILL HOLE
- EIS EXISTING IRON STAKE
- EIP EXISTING IRON PIPE
- EM ELECTRIC METER
- EPK EXISTING PK NAIL
- ES ELECTRIC STUB
- FE FLARED END SECTION
- FH FIRE HYDRANT
- FO FIBER OPTIC PEDESTAL
- GM GAS METER
- INV INVERT
- LP LIGHT POLE
- MS MANHOLE SANITARY SEWER
- NDH NEW DRILL HOLE
- NIP NEW IRON PIPE
- NPX NEW PK NAIL
- OHV OVERHEAD WIRES
- PNS POINT NOT SET
- PUE PUBLIC UTILITY EASEMENT
- TBC TOP BACK OF CURB
- TP TELEPHONE PEDESTAL
- TR TRANSFORMER
- CTV CABLE TV PEDESTAL
- UP UTILITY POLE
- WM WATER METER
- WV WATER VALVE
- YI YARD INLET
- () FIELD MEASUREMENT

SETBACK INFO

FRONT: _____ 35'
 REAR: _____ 25'
 SIDES: _____ 10'

REFERENCES:

B.M. 2017, PG. 38-39

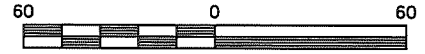

SCALE: 1" = 60'

NOTES

1. NOT FOR RECORDING IN MAP BOOKS.
2. THIS SURVEY SUBJECT TO ANY FACTS THAT MAY BE DISCLOSED BY A FULL AND ACCURATE TITLE SEARCH.
3. THIS MAP IS NOT A CERTIFIED SURVEY AND HAS NOT BEEN REVIEWED BY A LOCAL GOVERNMENT AGENCY FOR COMPLIANCE WITH ANY APPLICABLE LAND DEVELOPMENT REGULATIONS

WAKE COUNTY, NORTH CAROLINA

I CERTIFY THAT THIS MAP WAS DRAWN UNDER MY SUPERVISION FROM AN ACTUAL SURVEY MADE UNDER MY SUPERVISION; THAT THE IMPROVEMENTS LIE WHOLLY UPON THE LOT AND THAT THERE WERE NO ENCROACHMENTS OBSERVED EXCEPT AS SHOWN, AND THAT THE SURVEY IS OF AN EXISTING PARCEL OR PARCELS OF LAND.

AFTON COURT
 50' PUBLIC R/W

Charles R. Piratzky

6-28-17

CHARLES R. PIRATZKY, P.L.S.
 L-2813

DATE



DATE: 6-27-17
 Q:\FieldLoc\AKV34CLR33FDN.txt

RWK, PA
 engineering ~ surveying
 Corporate License: C-1771
 101 W. Main St., Suite 202
 Garner, NC 27529
 Phone (919) 779-4854
 Fax (919) 779-4056