

Initial Application Date: 9.6.17
~~02/13/2017~~

Application # 1-150040765 P.
CU# 1100

COUNTY OF HARNETT RESIDENTIAL LAND USE APPLICATION
Central Permitting 108 E. Front Street, Lillington, NC 27546 Phone: (910) 893-7525 ext:2 Fax: (910) 893-2793 www.harnett.org/permits

"A RECORDED SURVEY MAP, RECORDED DEED (OR OFFER TO PURCHASE) & SITE PLAN ARE REQUIRED WHEN SUBMITTING A LAND USE APPLICATION"

LANDOWNER: Jason Williams & Lorrile Mailing Address: 52 Harcest Ridge Dr.
City: Angier State: NC Zip: 27501 Contact No: 919-9241040 Email: jwilliams84@aol.com

APPLICANT: Same Mailing Address: _____
City: _____ State: _____ Zip: _____ Contact No: _____ Email: _____
*Please fill out applicant information if different than landowner

CONTACT NAME APPLYING IN OFFICE: Jason Williams Phone # 919-924-1040

PROPERTY LOCATION: Subdivision: Stephen M. Buffkin Map 2003-625 Lot #: 5 Lot Size: 10
State Road # _____ State Road Name: Buffkin Ln Map Book & Page: 2003, 625
Parcel: 040672000405 PIN: 0672-03-5073, 5000
Zoning: RA-30 Flood Zone: - Watershed: - Deed Book & Page: 3471, 444 Power Company*: Duke Progress

*New structures with Progress Energy as service provider need to supply premise number _____ from Progress Energy.

PROPOSED USE:

SFD: (Size 58'8" x 60'2") # Bedrooms: 4 # Baths: 3 Basement(w/wo bath): _____ Garage: 2 Deck: Crawl Space: Slab: _____ Slab: _____
(Is the bonus room finished? () yes () no w/ a closet? () yes () no (if yes add in with # bedrooms)

Mod: (Size _____ x _____) # Bedrooms _____ # Baths _____ Basement (w/wo bath) _____ Garage: _____ Site Built Deck: _____ On Frame _____ Off Frame _____
(Is the second floor finished? () yes () no Any other site built additions? () yes () no

Manufactured Home: _____ SW _____ DW _____ TW (Size _____ x _____) # Bedrooms: _____ Garage: _____ (site built? _____) Deck: _____ (site built? _____)

Duplex: (Size _____ x _____) No. Buildings: _____ No. Bedrooms Per Unit: _____

Home Occupation: # Rooms: _____ Use: _____ Hours of Operation: _____ #Employees: _____

Addition/Accessory/Other: (Size _____ x _____) Use: _____ Closets in addition? () yes () no

Water Supply: County _____ Existing Well _____ New Well (# of dwellings using well _____) *Must have operable water before final

Sewage Supply: New Septic Tank (Complete Checklist) Existing Septic Tank (Complete Checklist) _____ County Sewer

Does owner of this tract of land, own land that contains a manufactured home within five hundred feet (500') of tract listed above? () yes no

Does the property contain any easements whether underground or overhead () yes no

Structures (existing or proposed): Single family dwellings: 1 Manufactured Homes: _____ Other (specify): proposed pool and detached garage

Required Residential Property Line Setbacks:

	Minimum	Actual
Front	<u>35</u>	<u>372'</u>
Rear	<u>25</u>	<u>41'</u>
Closest Side	<u>10</u>	<u>209'</u>
Sidestreet/corner lot	<u>20</u>	<u>-</u>
Nearest Building on same lot	<u>10</u>	<u>10</u>

Comments: customer wants septic relocated so they can add an underground pool.

SPECIFIC DIRECTIONS TO THE PROPERTY FROM LILLINGTON: From 401 Liddington Drive toward Angier 401 becomes 210. Turn right on Matthew Mill Pond Rd, turn right on to Butkin Ln. Follow dirt road, drive through gated drive. Driveway goes to the left to the home site.

If permits are granted I agree to conform to all ordinances and laws of the State of North Carolina regulating such work and the specifications of plans submitted. I hereby state that foregoing statements are accurate and correct to the best of my knowledge. Permit subject to revocation if false information is provided.

Jacobs & Jane Williams / 2-17-17
Signature of Owner or Owner's Agent / Date

It is the owner/applicants responsibility to provide the county with any applicable information about the subject property, including but not limited to: boundary information, house location, underground or overhead easements, etc. The county or its employees are not responsible for any incorrect or missing information that is contained within these applications.

This application expires 6 months from the initial date if permits have not been issued

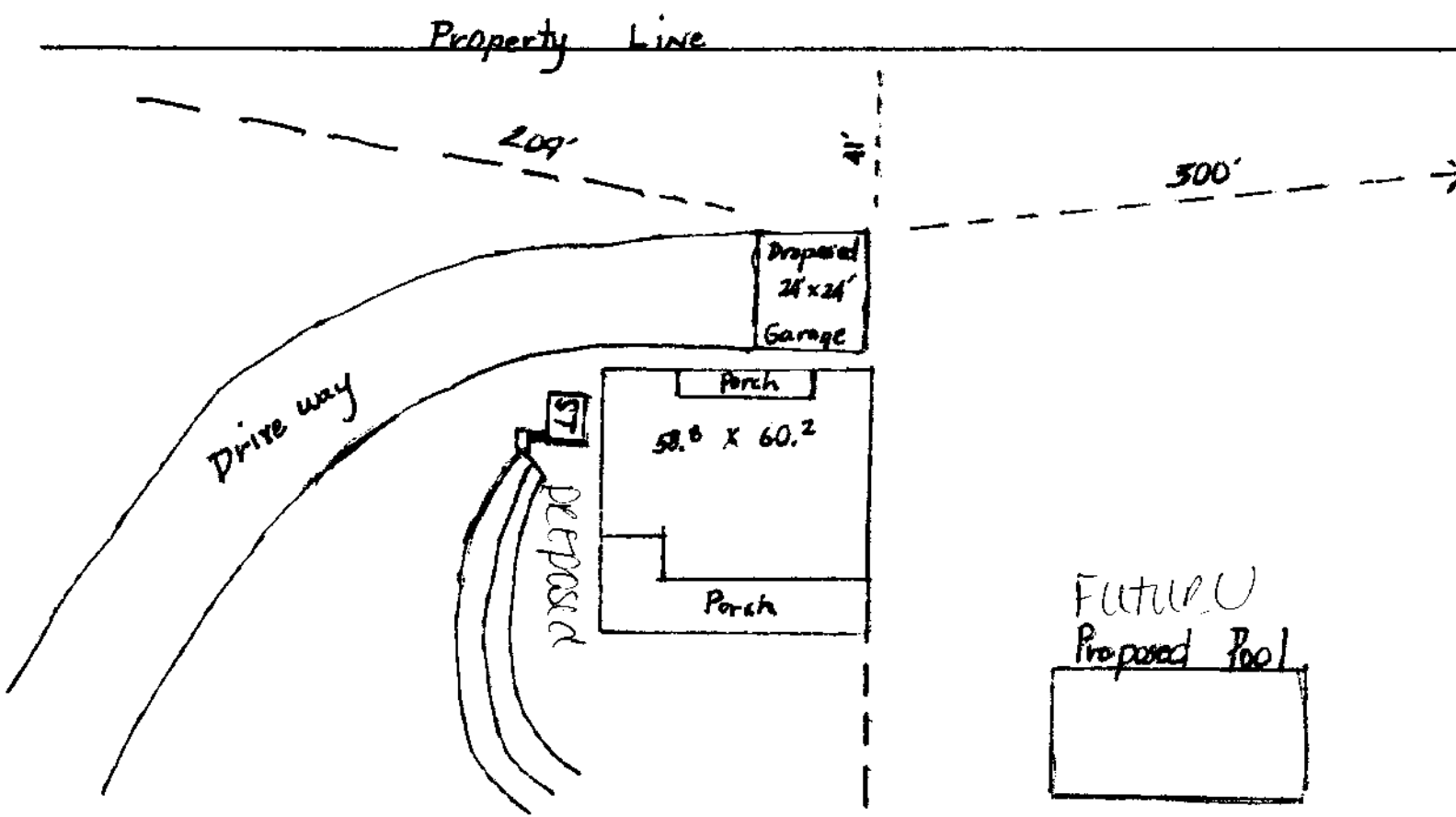

Proposed Septic Relocation

Permit # 29332

Jason & Lorrie Williams
229 Buf Kin Lane
Angier N.C.

Bim Builders
Denny 919 524 5852

↓ RLVISA

SITE PLAN APPROVAL

DISTRICT RA2C USE SFD

#BEDROOMS 4

9.6.17 dj.dunsm
ZONING ADMINISTRATOR