

Improvement Permit

A building permit cannot be issued with only an Improvement Permit

ISSUED TO: THOMAS & RYE GALLOWAY PROPERTY LOCATION: TIRZAH DRIVE SUBDIVISION: THOMAS LASATER LOT # 5
NEW [X] REPAIR [] EXPANSION []
Type of Structure: SFD (85'x76')
Proposed Wastewater System Type: Pump To 25% REDUCTION SYSTEM
Projected Daily Flow: 360 GPD
Number of bedrooms: 3 Number of Occupants: 6 max
Basement [] Yes [X] No
Pump Required: [X] Yes [] No [] May be required based on final location and elevations of facilities
Type of Water Supply: [] Community [X] Public [] Well Distance from well 100* feet
Permit conditions: Permit valid for: [X] Five years [] No expiration

Authorized State Agent: [Signature] Date: 4/26/17 SEE ATTACHED SITE SKETCH
The issuance of this permit by the Health Department in no way guarantees the issuance of other permits. The permit holder is responsible for checking with appropriate governing bodies in meeting their requirements. This site is subject to revocation if the site plan, plat, or the intended use changes. The Improvement Permit shall not be affected by a change in ownership of the site. This permit is subject to compliance with the provisions of the Laws and Rules for Sewage Treatment and Disposal and to conditions of this permit.

Construction Authorization

(Required for Building Permit)

The construction and installation requirements of Rules .1950, .1952, .1954, .1955, .1956, .1957, .1958, and .1959 are incorporated by references into this permit and shall be met. Systems shall be installed in accordance with the attached system layout.

ISSUED TO: THOMAS & RYE GALLOWAY PROPERTY LOCATION: TIRZAH DRIVE SUBDIVISION: THOMAS LASATER LOT # 5
Facility Type: SFD (85'x76') [X] New [] Expansion [] Repair
Basement? [] Yes [X] No Basement Fixtures? [] Yes [X] No
Type of Wastewater System** Pump To 25% REDUCTION SYSTEM (Initial) Wastewater Flow: 360 GPD
(See note below, if applicable []) Pump To 25% Red. (Repair)

Installation Requirements/Conditions
Septic Tank Size 1000 gallons
Pump Tank Size 1000 gallons
Number of trenches 4
Exact length of each trench 50 feet
Trench Spacing: 9 Feet on Center
Soil Cover: 6-12 inches
Maximum Trench Depth of: 18-24 inches
(Trench bottoms shall be level to +/-1/4" in all directions)
(Trench bottoms shall be level to +/-1/4" in all directions)
Pump Requirements: ft. TDH vs. GPM
Aggregate Depth: inches below pipe, inches above pipe, inches total

WATER LINES (INCLUDING IRRIGATION) MUST BE 10FT. FROM ANY PART OF SEPTIC SYSTEM OR REPAIR AREA. NO UTILITIES ALLOWED IN INITIAL OR REPAIR DRAIN FIELD AREA.

**If applicable: I understand the system type specified is different from the type specified on the application. I accept the specifications of this permit.

Owner/Legal Representative Signature: Date:

This Construction Authorization is subject to revocation if the site plan, plat, or the intended use changes. The Construction Authorization shall not be transferred when there is a change in ownership of the site. This Construction Authorization is subject to compliance with the provisions of the Laws and Rules for Sewage Treatment and Disposal and to the conditions of this permit. SEE ATTACHED SITE SKETCH

Authorized State Agent: [Signature] Date: 4/26/17
Construction Authorization Expiration Date: 4/26/22

HTE# 17-540672

Permit # 29504

Harnett County Department of Public Health Site Sketch

ISSUED TO: THOMAS & RYE GALLOWAY PROPERTY LOCATOR: TIOZAH DRIVE
SUBDIVISION THOMAS LASATER LOT # 5

Authorized State Agent: ~~REDS (OLIVER TOLKSDORF)~~ Date: 4/26/17

* DRAIN FIELD TO BE
LAVED OUT AFTER
LOT IS CLEARED

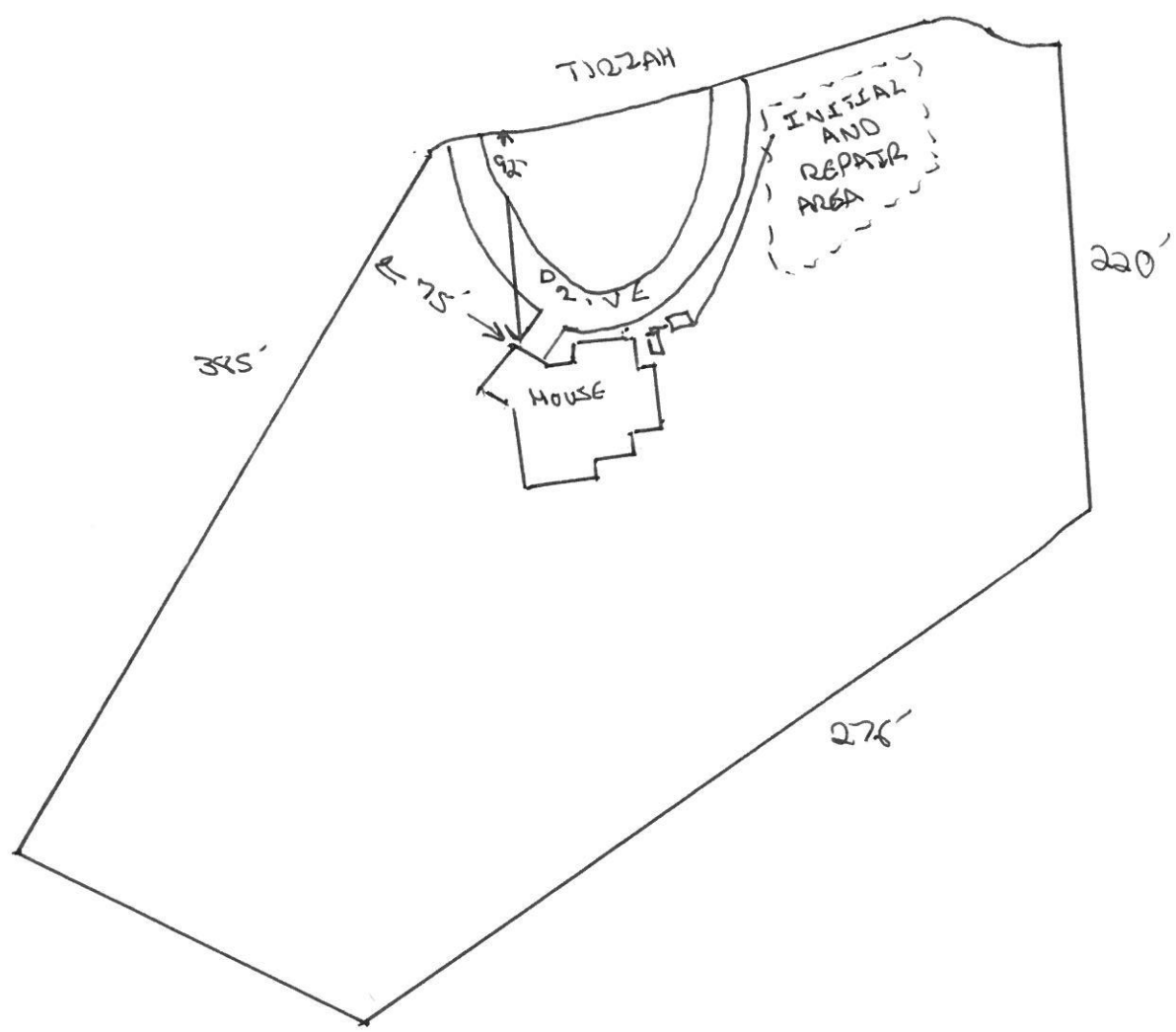

**SOIL/SITE EVALUATION
 for ON-SITE WASTEWATER SYSTEM**

Owner: Applicant:
 Address: Date Evaluated:
 Proposed Facility: 3 BDRM Design Flow (.1949): 360 gpd Property Size:
 Location of Site: Property Recorded:
 Water Supply: Public Individual Well Spring Other
 Evaluation Method: Auger Boring Pit Cut
 Type of Wastewater: Sewage Industrial Process Mixed

P R O F I L E #	.1940 Landscape Position/ Slope %	Horizon Depth (In.)	SOIL MORPHOLOGY .1941		OTHER PROFILE FACTORS				Profile Class & LTAR
			.1941 Structure/ Texture	.1941 Consistence Mineralogy	.1942 Soil Wetness/ Color	.1943 Soil Depth (IN.)	.1956 Sapro Class	.1944 Restr Horiz	
1	<u>L5 3-10</u>	<u>0-9</u>	<u>G SL</u>	<u>VFA NSLP</u>					
		<u>9"</u>	<u>C</u>	<u>F1 SLP</u>	<u>10-27/2@10"</u>				<u>US</u>
2		<u>0-10</u>	<u>G SL</u>	<u>VFA NSLP</u>					
		<u>10"</u>	<u>C</u>	<u>FR SLP</u>	<u>CR 2 @ 12"</u>				<u>US</u>
3	<u>L5 2-5</u>	<u>0-36</u>	<u>G S</u>	<u>VFA NSLP</u>					
		<u>36-48</u>	<u>G SL</u>	<u>VFA NSLP</u>					<u>S .6</u>
4		<u>0-24</u>	<u>G S</u>	<u>VFA NSLP</u>					<u>S .4</u>
5		<u>0-48</u>	<u>G S</u>	<u>VFA NSLP</u>					<u>S .8</u>

Description	Initial System	Repair System	Other Factors (.1946): Site Classification (.1948): <u>05</u> Evaluated By: <u>DX</u> Others Present: <u>—</u>
Available Space (.1945)	<input checked="" type="checkbox"/>	<input checked="" type="checkbox"/>	
System Type(s)	<u>0 VHP</u>	<u>25 gpd</u>	
Site LTAR	<u>.6</u>	<u>.5</u>	