

Improvement Permit

A building permit cannot be issued with only an Improvement Permit

PROPERTY LOCATION: 494 Cross Link Dr. (Chalybeate Springs rd.)
SR 1441

ISSUED TO: Comfort Homes Inc. SUBDIVISION Cross Link Place LOT # 11

NEW REPAIR EXPANSION
Type of Structure: 3BR SFD (64' x 46')
Proposed Wastewater System Type: LS% Red System

Site Improvements required prior to Construction Authorization Issuance: _____

Projected Daily Flow: 360 GPD
Number of bedrooms: 3 Number of Occupants: 6 max

Basement Yes No

Pump Required: Yes No May be required based on final location and elevations of facilities

Type of Water Supply: Community Public Well Distance from well _____ feet

Permit valid for: Five years
 No expiration

Permit conditions: _____

Authorized State Agent: [Signature] Date: 03/01/17 SEE ATTACHED SITE SKETCH

The issuance of this permit by the Health Department in no way guarantees the issuance of other permits. The permit holder is responsible for checking with appropriate governing bodies in meeting their requirements. This site is subject to revocation if the site plan, plat, or the intended use changes. The Improvement Permit shall not be affected by a change in ownership of the site. This permit is subject to compliance with the provisions of the Laws and Rules for Sewage Treatment and Disposal and to conditions of this permit.

Construction Authorization

(Required for Building Permit)

The construction and installation requirements of Rules .1950, .1952, .1954, .1955, .1956, .1957, .1958, and .1959 are incorporated by references into this permit and shall be met. Systems shall be installed in accordance with the attached system layout.

ISSUED TO: Comfort Homes Inc. PROPERTY LOCATION: 494 Cross Link Dr. (Chalybeate Springs rd.)
SR 1441

Facility Type: 3BR SFD (64' x 46') New Expansion Repair
SUBDIVISION Cross Link Place LOT # 11

Basement? Yes No Basement Fixtures? Yes No

Type of Wastewater System** Pump to 25% Reduction System (Initial) Wastewater Flow: 300 GPD
(See note below, if applicable)

Pump to 25% Red. System (Repair)

Installation Requirements/Conditions

Septic Tank Size 1000 gallons
Pump Tank Size _____ gallons

Number of trenches 3
Exact length of each trench 90 feet
Trenches shall be installed on contour at a
Maximum Trench Depth of: 24 inches
(Trench bottoms shall be level to +/-1/4"
in all directions)

Trench Spacing: 9 Feet on Center
Soil Cover: 12 inches
(Maximum soil cover shall not exceed
36" above the trench bottom)

Pump Requirements: _____ ft. TDH vs. _____ GPM

Aggregate Depth: 6 inches below pipe
2 inches above pipe
12 inches total

Conditions: _____

**WATER LINES (INCLUDING IRRIGATION) MUST BE 10FT. FROM ANY PART OF SEPTIC SYSTEM OR REPAIR AREA.
NO UTILITIES ALLOWED IN INITIAL OR REPAIR DRAIN FIELD AREA.**

**If applicable: I understand the system type specified is different from the type specified on the application. I accept the specifications of this permit.

Owner/Legal Representative Signature: _____ Date: _____

This Construction Authorization is subject to revocation if the site plan, plat, or the intended use changes. The Construction Authorization shall not be transferred when there is a change in ownership of the site. This Construction Authorization is subject to compliance with the provisions of the Laws and Rules for Sewage Treatment and Disposal and to the conditions of this permit. SEE ATTACHED SITE SKETCH

Authorized State Agent: [Signature] Date: 03/01/17
Construction Authorization Expiration Date: 03/01/22

HTE# 17-5-40663

Permit # 29324

Harnett County Department of Public Health Site Sketch

PROPERTY LOCATOR: 494 Cross Link Dr. (Chalchewee Springs Rd)
SF 1441

ISSUED TO: Comfort Homes, Inc. SUBDIVISION Cross Link Place LOT # 11

Authorized State Agent: [Signature] Date: 03/01/17

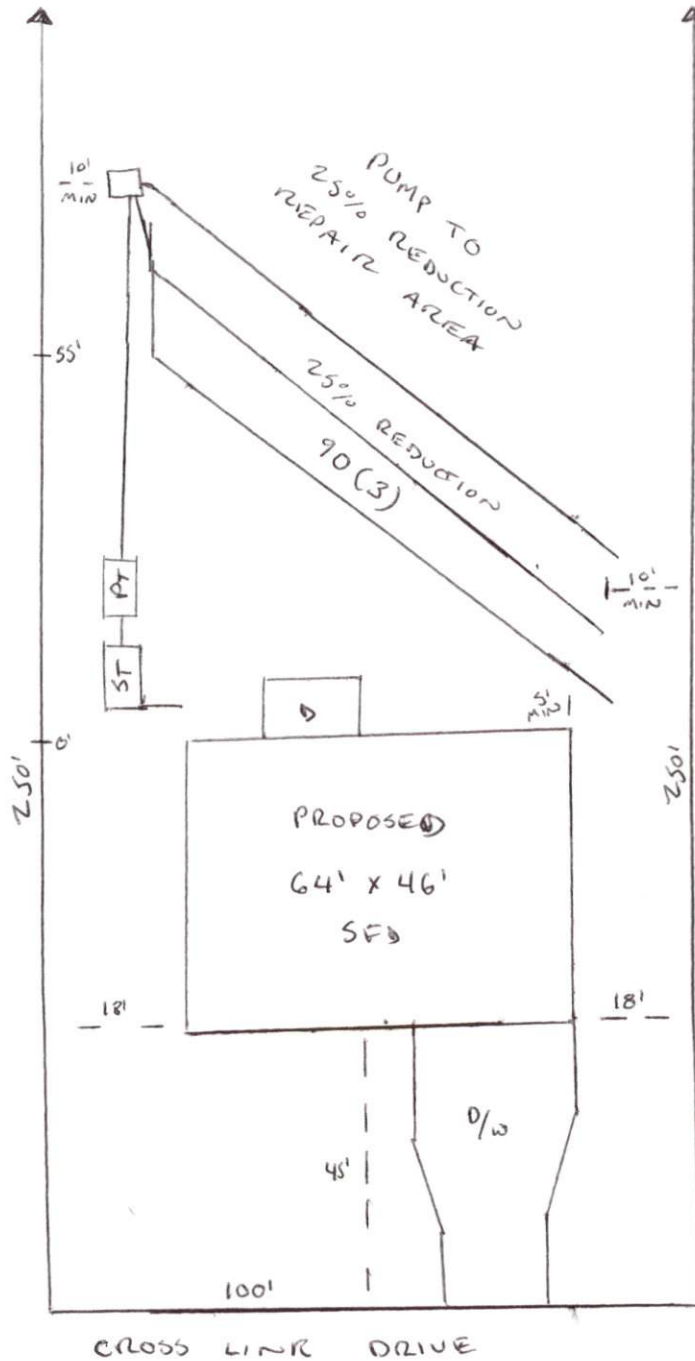

* Pump may not be required base on final elevation of plumbing
 * Tank may be placed on opposite corner of SFD without pump if 1/8 in per foot of fall can be maintained