

Improvement Permit

A building permit cannot be issued with only an Improvement Permit

ISSUED TO: S Mark Properties
PROPERTY LOCATION: 217 Oxford Woods Dr. (Old Stage Rd) SR 1006
SUBDIVISION: Oxford Woods LOT # 9
Type of Structure: 2 BR SFD
Proposed Wastewater System Type: 25% Reduction System
Projected Daily Flow: 240 GPD
Number of bedrooms: 2 Number of Occupants: 4 max
Basement: No
Pump Required: May be required based on final location and elevations of facilities
Type of Water Supply: Public
Permit valid for: Five years

Authorized State Agent: James E. Mahan, PE Date: 1-11-17 SEE ATTACHED SITE SKETCH
The issuance of this permit by the Health Department in no way guarantees the issuance of other permits. The permit holder is responsible for checking with appropriate governing bodies in meeting their requirements. This site is subject to revocation if the site plan, plat, or the intended use changes. The Improvement Permit shall not be affected by a change in ownership of the site. This permit is subject to compliance with the provisions of the Laws and Rules for Sewage Treatment and Disposal and to conditions of this permit.

Construction Authorization

(Required for Building Permit)

The construction and installation requirements of Rules .1950, .1952, .1954, .1955, .1956, .1957, .1958, and .1959 are incorporated by references into this permit and shall be met. Systems shall be installed in accordance with the attached system layout.

ISSUED TO: S Mark Properties
PROPERTY LOCATION: 217 Oxford Woods Dr. (Old Stage Rd) SR 1006
SUBDIVISION: Oxford Woods LOT # 9
Facility Type: 2 BR SFD New
Basement: No
Type of Wastewater System: Pump to 25% Reduction System (Initial) Wastewater Flow: 240 GPD
Pump to 25% Reduction System (Repair)

Installation Requirements/Conditions
Septic Tank Size: 1000 gallons
Pump Tank Size:
Number of trenches: 2
Exact length of each trench: 80 feet
Trench Spacing: 9 Feet on Center
Soil Cover: 6+ inches
Maximum Trench Depth of: 24"-26" inches
Pump Requirements: ft. TDH vs. GPM
Aggregate Depth: 6 inches below pipe, 2 inches above pipe, 12 inches total
Conditions: Pump may not be rep. if adequate fall can reach system

WATER LINES (INCLUDING IRRIGATION) MUST BE 10FT. FROM ANY PART OF SEPTIC SYSTEM OR REPAIR AREA. NO UTILITIES ALLOWED IN INITIAL OR REPAIR DRAIN FIELD AREA.

**If applicable: I understand the system type specified is different from the type specified on the application. I accept the specifications of this permit.

Owner/Legal Representative Signature: Date:

This Construction Authorization is subject to revocation if the site plan, plat, or the intended use changes. The Construction Authorization shall not be transferred when there is a change in ownership of the site. This Construction Authorization is subject to compliance with the provisions of the Laws and Rules for Sewage Treatment and Disposal and to the conditions of this permit. SEE ATTACHED SITE SKETCH

Authorized State Agent: James E. Mahan, PE Date: 1-11-17
Construction Authorization Expiration Date: 1-11-22

HTE# 16-5-40473

Permit # 29298

Harnett County Department of Public Health Site Sketch

ISSUED TO: S. Mark Properties PROPERTY LOCATOR: 217 Oxford Woods Dr. (old stage rd)
SUBDIVISION: Oxford Woods SR: 1006 LOT # 9

Authorized State Agent: James C. Marshall, PEHS Date: 1-11-17
Walter Green, PEHS-I

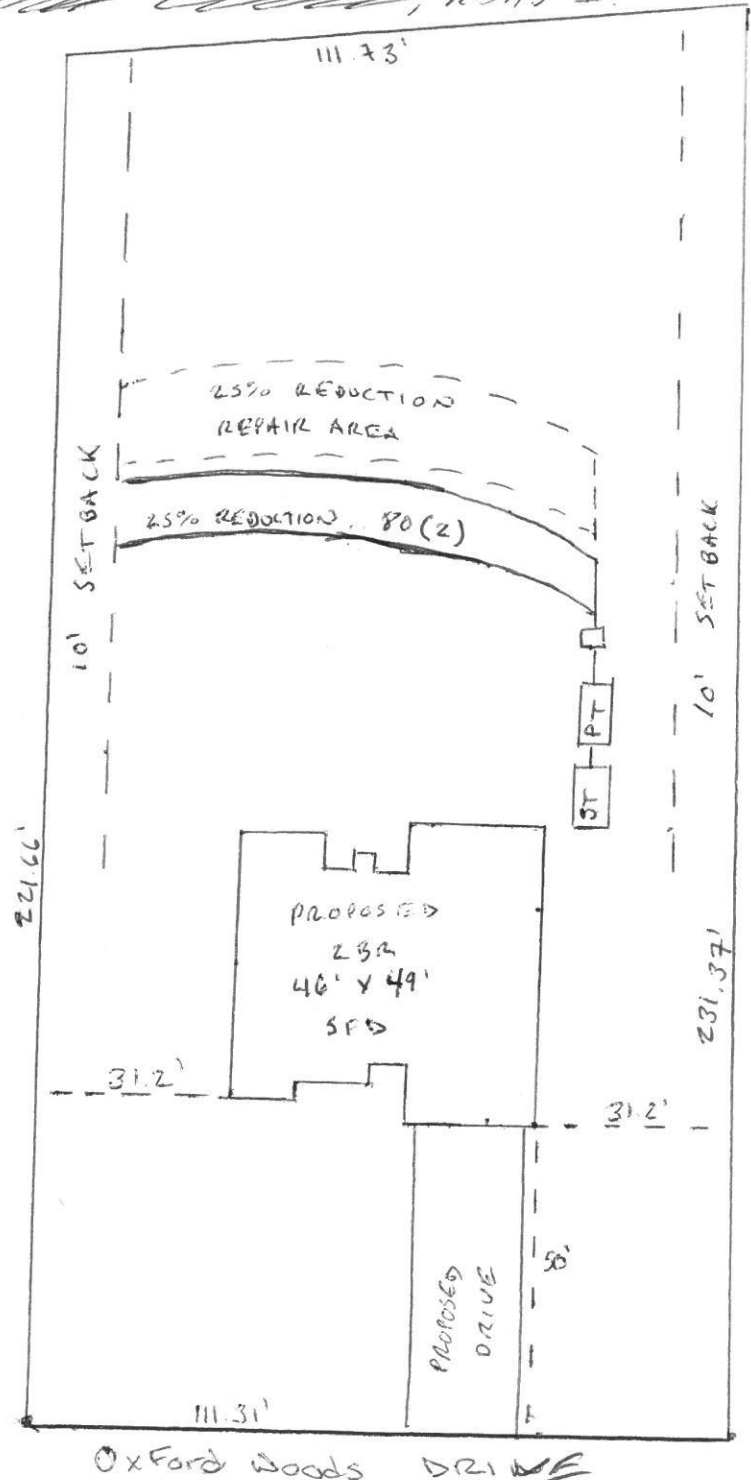

Pump
*Septic Tank may
not be need sep.
if 1/8 in per foot
can be given to
septic tank and
to nitrification lines

Oxford Woods DRIVE