

HTE# 16-5-4042S

Harnett County Department of Public Health

29297

Improvement Permit

A building permit cannot be issued with only an Improvement Permit

ISSUED TO: S. Mark Properties

PROPERTY LOCATION: SR1 Oxford Woods (old stage Rd.)
SUBDIVISION Oxford Woods LOT # 3

NEW REPAIR EXPANSION

Site Improvements required prior to Construction Authorization Issuance:

Type of Structure: ZBR SFD

Proposed Wastewater System Type: 25% Reduction System

Projected Daily Flow: 240 GPD

Number of bedrooms: 3 Number of Occupants: 4 max

Basement Yes No

Pump Required: Yes No May be required based on final location and elevations of facilities

Type of Water Supply: Community Public Well Distance from well _____ feet

Permit valid for: Five years
 No expiration

Permit conditions: _____

Authorized State Agent: [Signature] Date: 1-11-17

SEE ATTACHED SITE SKETCH

The issuance of this permit by the Health Department in no way guarantees the issuance of other permits. The permit holder is responsible for checking with appropriate governing bodies in meeting their requirements. This site is subject to revocation if the site plan, plat, or the intended use changes. The Improvement Permit shall not be affected by a change in ownership of the site. This permit is subject to compliance with the provisions of the Laws and Rules for Sewage Treatment and Disposal and to conditions of this permit.

Construction Authorization

(Required for Building Permit)

The construction and installation requirements of Rules .1950, .1952, .1954, .1955, .1956, .1957, .1958, and .1959 are incorporated by references into this permit and shall be met. Systems shall be installed in accordance with the attached system layout.

ISSUED TO: S. Mark Properties

PROPERTY LOCATION: SR1 Oxford Woods (old stage Rd.)
SUBDIVISION Oxford Woods LOT # 3

Facility Type: ZBR SFD New Expansion Repair

Basement? Yes No Basement Fixtures? Yes No

Type of Wastewater System** Pump to 25% Reduction System (Initial) Wastewater Flow: 240 GPD

(See note below, if applicable)
Pump to 25% Reduction System (Repair)

Installation Requirements/Conditions

Septic Tank Size 1000 gallons

Number of trenches 2
Exact length of each trench 80 feet

Trench Spacing: 9 Feet on Center

Pump Tank Size _____ gallons

Trenches shall be installed on contour at a
Maximum Trench Depth of: 28"-30" inches
(Trench bottoms shall be level to $\pm 1/4"$
in all directions)

Soil Cover: 6 inches
(Maximum soil cover shall not exceed
36" above the trench bottom)

Pump Requirements: _____ ft. TDH vs. _____ GPM

Aggregate Depth: 6 inches below pipe
2 inches above pipe

Conditions: Pump may not be req. if adequate Fall can reach system

12 inches total

**WATER LINES (INCLUDING IRRIGATION) MUST BE 10FT. FROM ANY PART OF SEPTIC SYSTEM OR REPAIR AREA.
NO UTILITIES ALLOWED IN INITIAL OR REPAIR DRAIN FIELD AREA.**

**If applicable: I understand the system type specified is different from the type specified on the application. I accept the specifications of this permit.

Owner/Legal Representative Signature: _____ Date: _____

This Construction Authorization is subject to revocation if the site plan, plat, or the intended use changes. The Construction Authorization shall not be transferred when there is a change in ownership of the site. This Construction Authorization is subject to compliance with the provisions of the Laws and Rules for Sewage Treatment and Disposal and to the conditions of this permit. SEE ATTACHED SITE SKETCH

Authorized State Agent: [Signature] Date: 1-11-17
Construction Authorization Expiration Date: 1-11-22

HTE# 16-5-40425

Permit # 29297

Harnett County Department of Public Health Site Sketch

ISSUED TO: S. Mark Properties PROPERTY LOCATOR: 51 Oxford Woods (old Stage Rd.)
SUBDIVISION: Oxford Woods SR 1006 LOT # 3

Authorized State Agent: James E. Markham, PE, RCHS Date: 1-11-17
Andrew [unclear], RCHS-F

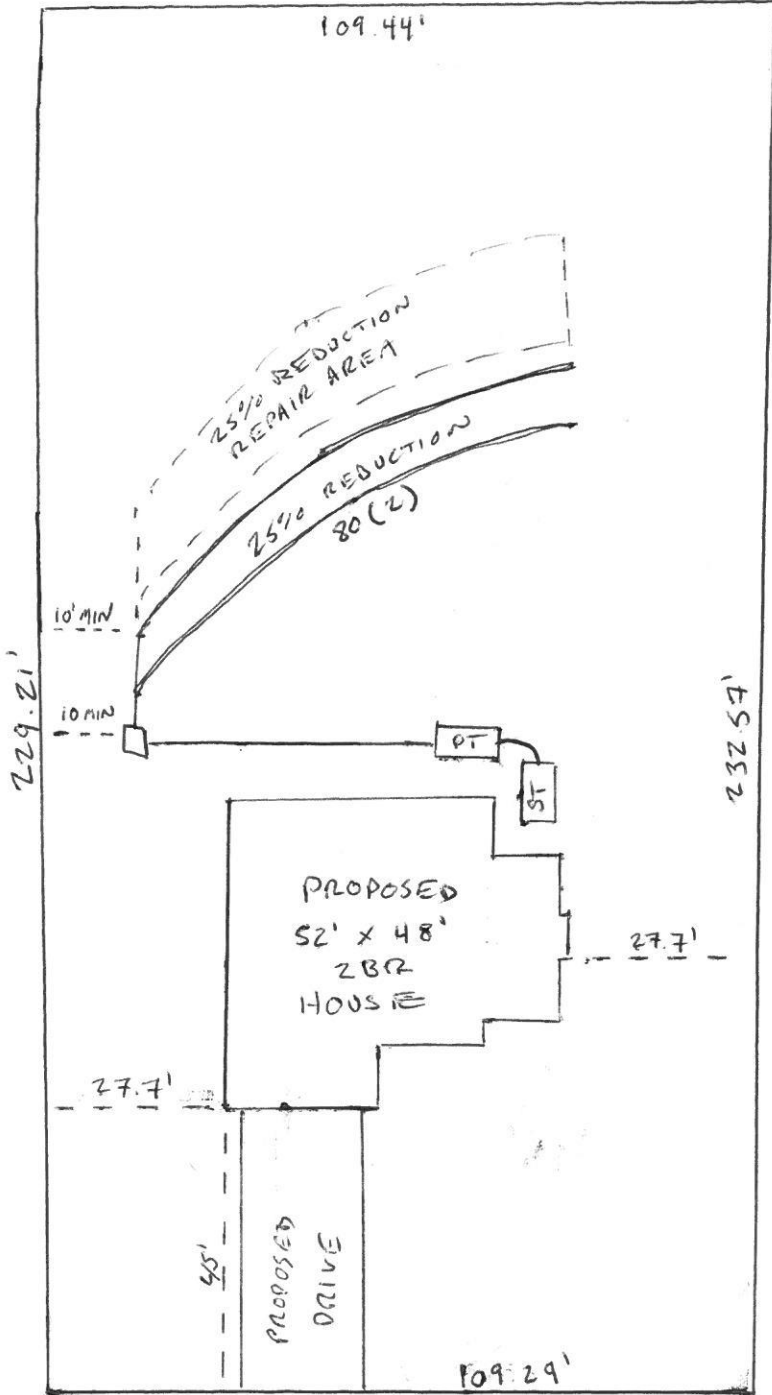

* Septic tank may be placed on upper end of the house with no pump tank if required
1/8 in per foot fall can be given to septic tank and to nitrification lines