

**SOIL/SITE EVALUATION
 for ON-SITE WASTEWATER SYSTEM**

Owner: ^{at home} Grace Applicant: Robert Sullivan
 Address: Lot 4 Oakridge Dungeness Date Evaluated: 12/19/16
 Proposed Facility: 4 BR SFD Design Flow (.1949): 480 gal/d
 Location of Site: Rufford Beach SFD Property Recorded: YES Property Size: 1.87 AC
 Water Supply: Public Individual Well Spring Other
 Evaluation Method: Auger Boring Pit Cut
 Type of Wastewater: Sewage Industrial Process Mixed

P R O F I L E #	.1940 Landscape Position/ Slope %	Horizon Depth (In.)	SOIL MORPHOLOGY .1941		OTHER PROFILE FACTORS				Profile Class & LTAR
			.1941 Structure/ Texture	.1941 Consistence Mineralogy	.1942 Soil Wetness/ Color	.1943 Soil Depth (IN.)	.1956 Sapro Class	.1944 Restr Horiz	
1	L < 2%	0-26	Gr. / SL	Fr. SSSP 5/4					
		26-48	BK / SCL	Fi. S P 5/70	7.5YR 4/1 @ 42"	48+			PS 0.4
2	L < 2%	0-20	Gr. / SL	Fr. SSSP 3/4					
		20-40	BK / SCL	Fi. S P 5/70	7.5YR 4/1 @ 36"	40+			PS 0.4
3	L < 2%	0-24	Gr. / SL	Fr. SSSP 5/4					
		24-48	BK / SCL	Fi. S P 5/4	7.5YR 4/1 @ 40"	48+			PS 0.4
4	L < 2%	0-20	Gr. / SL	Fi. 5HR 5/4					
		20-40	OK / SCL	Fi. S P 5/4	7.5YR 4/1 @ 36"	40+			PS 0.4
5,6	L < 2%	0-18	Gr. / SL	Fr. SSSP 5/4					
		18-38	BK / SCL	Fi. S P 5/4	7.5YR 4/1 @ 34"	38+			PS 0.4

Description	Initial System	Repair System	Other Factors (.1946): None
Available Space (.1945)	<input checked="" type="checkbox"/>	<input checked="" type="checkbox"/>	Site Classification (.1948): Provisionally suitable
System Type(s)	2.5% red.	2.5% red.	Evaluated By: Andrew Curry, REHS-J
Site LTAR	0.4	0.4	Others Present: James Menhert, REHS

COMMENTS: _____

<u>LANDSCAPE POSITIONS</u>	<u>GROUP</u>	<u>TEXTURES</u>	<u>.1955 LTAR</u>	<u>CONSISTENCE MOIST</u>	<u>WET</u>
R-RIDGE	I	S-SAND	1.2 - 0.8	VFR-VERY FRIABLE	NS-NON-STICKY
S-SHOULDER SLOPE		LS-LOAMY SAND		FR-FRIABLE	SS-SLIGHTLY STICKY
L-LINEAR SLOPE	II	SL-SANDY LOAM	0.8 - 0.6	FI-FIRM	S-STICKY
FS-FOOT SLOPE		L-LOAM		VFI-VERY FIRM	VS-VERY STICKY
N-NOSE SLOPE	III	SI-SILT	0.6 - 0.3	EFI-EXTREMELY FIRM	NP-NON-PLASTIC
H-HEAD SLOPE		SIL-SILT LOAM		SP-SLIGHTLY STICKY	
CC-CONCLAVE SLOPE		CL-CLAY LOAM		P-PLASTIC	
CV-CONVEX SLOPE		SCL-SANDY CLAY LOAM		VP-VERY PLASTIC	
T-TERRACE	IV	SC-SILTY CLAY	0.4 - 0.1		
FP-FLOOD PLAN		C-CLAY			
		SC-SANDY CLAY			

STRUCTURE
 SG-SINGLE GRAIN
 M-MASSIVE
 CR-CRUMB
 GR-GRANULAR
 SBK-SUBANGULAR BLOCKY
 ABK-ANGULAR BLOCKY
 PL-PLATY
 PR-PRISMATIC

MINERALOGY
 SLIGHTLY EXPANSIVE
 EXPANSIVE

Show profile locations and other site features (dimensions, references or benchmark, and North)

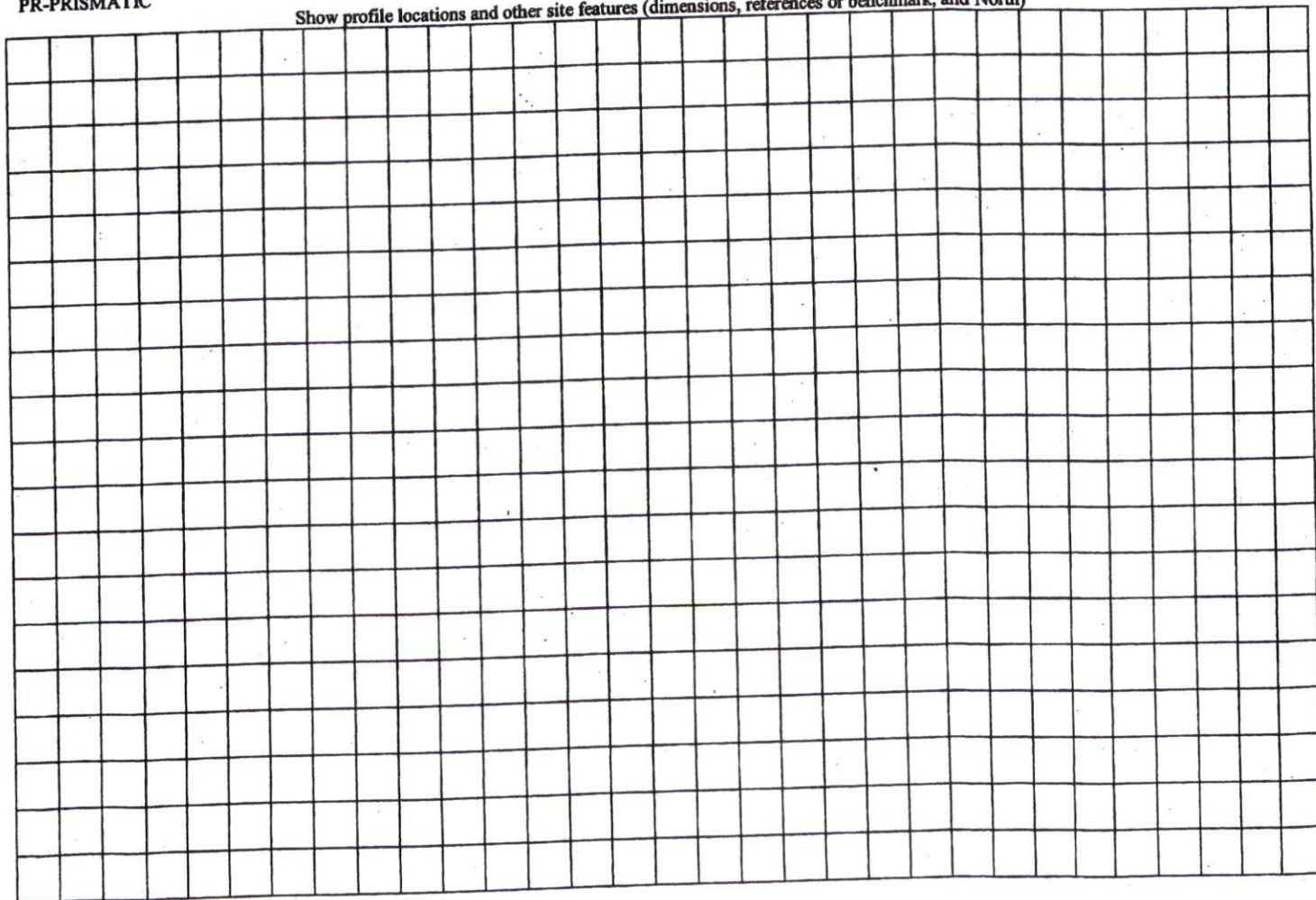

JEWELL CENTER
GERALD HOWELL
D.B. 898 PG. 989

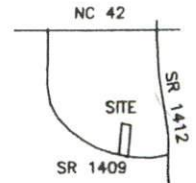

VICINITY MAP (no scale)



RAEFORD BAKER EST.
D.B. 411 PG. 229

EIS S 86°09'02"E 140.00' EIS

④
1.87 ACRES
TO R/W

SITE PLAN APPROVAL

DISTRICT KA-30 USE SFD

#BEDROOMS 4

Date 12-8-16 ZB
Zoning Administrator

591.47'

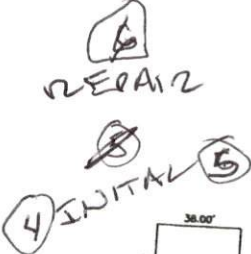

634.60'

⑤
MAP # 2010-850



N 05°02'25"E

S 05°02'25"W

dwelling

R/W

CL

ECS N 68°55'40"W

R/W

145.63'

1169' ALONG CENTERLINE
TO INTX. WITH SR 1412

BUCKHORN DUNCAN ROAD
NCSR # 1409
60' PUBLIC R/W

PROPOSED PLAN FOR
STEVE & DIANE GRACE

LOT 4 MAP # 2010 PG. 850
DEED BOOK 3405 PAGE 46
PIN # 0645-11-5544.000
BUCKHORN TOWNSHIP

HARNETT COUNTY - NORTH CAROLINA
SCALE : 1" = 60' - DECEMBER 1, 2016

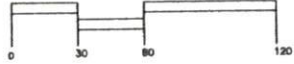

BENTON DEWAR & ASSOCIATES
PROFESSIONAL LAND SURVEYOR
5920 HONEYCUTT ROAD
HOLLY SPRINGS, NC 27540
(919)-562-9813

I, BENTON W. DEWAR CERTIFY THAT THIS PLAT WAS DRAWN UNDER MY SUPERVISION FROM AN ACTUAL SURVEY MADE UNDER MY SUPERVISION; THAT THE RATIO OF PRECISION IS 1:____; THAT THE BOUNDARIES NOT SURVEYED ARE SHOWN AS BROKEN LINES PLOTTED FROM INFORMATION FOUND IN BOOK _____ PAGE _____; THAT THIS PLAT DOES NOT MEET SIZE REQUIREMENTS FOR RECORDING IN THE REGISTER OF DEEDS, PER G.S. 47-30 AS AMENDED. LICENCE NUMBER AND SEAL THIS _____ DAY OF _____ 20____

PROFESSIONAL LAND SURVEYOR L-3040

THIS PLAT IS OF A BOUNDARY SURVEY OF AN EXISTING PARCEL OF LAND THAT IS REGULATED BY A COUNTY OR MUNICIPALITY ORDINANCE THAT REGULATES PARCELS OF LAND.

16-341s
4RAYFORD\14A\600