

Improvement Permit

A building permit cannot be issued with only an Improvement Permit

PROPERTY LOCATION: TINGEN RD

ISSUED TO: M CLEAN CONTRACTING & INVEST. SUBDIVISION: MARLBOROUGH LOT # 2

NEW [X] REPAIR [ ] EXPANSION [ ]

Site Improvements required prior to Construction Authorization Issuance:

Type of Structure: SFO (30'x52') Proposed Wastewater System Type: Pump To 25% Reduction

Projected Daily Flow: 360 GPD

Number of bedrooms: 3 Number of Occupants: 6 max

Basement [ ] Yes [X] No

Pump Required: [X] Yes [ ] No [ ] May be required based on final location and elevations of facilities

Type of Water Supply: [ ] Community [X] Public [ ] Well Distance from well 100 feet

Permit valid for: [X] Five years [ ] No expiration

Permit conditions:

Authorized State Agent: [Signature] Date: 12/14/16

SEE ATTACHED SITE SKETCH

The issuance of this permit by the Health Department in no way guarantees the issuance of other permits. The permit holder is responsible for checking with appropriate governing bodies in meeting their requirements. This site is subject to revocation if the site plan, plat, or the intended use changes. The Improvement Permit shall not be affected by a change in ownership of the site. This permit is subject to compliance with the provisions of the Laws and Rules for Sewage Treatment and Disposal and to conditions of this permit.

Construction Authorization

(Required for Building Permit)

The construction and installation requirements of Rules .1950, .1952, .1954, .1955, .1956, .1957, .1958, and .1959 are incorporated by references into this permit and shall be met. Systems shall be installed in accordance with the attached system layout.

ISSUED TO: M CLEAN CONTRACTING PROPERTY LOCATION: TINGEN RD SUBDIVISION: MARLBOROUGH LOT # 2

Facility Type: SFO (30'x52') [X] New [ ] Expansion [ ] Repair

Basement? [ ] Yes [X] No Basement Fixtures? [ ] Yes [X] No

Type of Wastewater System\*\* Pump To 25% Reduction SYSTEM (Initial) Wastewater Flow: 360 GPD

(See note below, if applicable [ ]) Pump To 25% Red (Repair)

Installation Requirements/Conditions

Septic Tank Size 1000 gallons

Pump Tank Size 1000 gallons

Number of trenches 2

Exact length of each trench 60 feet

Trenches shall be installed on contour at a

Maximum Trench Depth of: 24 inches

(Trench bottoms shall be level to +/-1/4"

in all directions)

Trench Spacing: 9 Feet on Center

Soil Cover: 12 inches

(Maximum soil cover shall not exceed

36" above the trench bottom)

Pump Requirements: ft. TDH vs. GPM

Aggregate Depth: inches below pipe

Aggregate Depth: inches above pipe

Conditions: inches total

WATER LINES (INCLUDING IRRIGATION) MUST BE 10FT. FROM ANY PART OF SEPTIC SYSTEM OR REPAIR AREA. NO UTILITIES ALLOWED IN INITIAL OR REPAIR DRAIN FIELD AREA.

\*\*If applicable: I understand the system type specified is different from the type specified on the application. I accept the specifications of this permit.

Owner/Legal Representative Signature: Date:

This Construction Authorization is subject to revocation if the site plan, plat, or the intended use changes. The Construction Authorization shall not be transferred when there is a change in ownership of the site. This Construction Authorization is subject to compliance with the provisions of the Laws and Rules for Sewage Treatment and Disposal and to the conditions of this permit. SEE ATTACHED SITE SKETCH

Authorized State Agent: [Signature] Date: 12/14/16

Construction Authorization Expiration Date: 12/14/21

HTE# 16-5-40316

Permit # 29126

# Harnett County Department of Public Health Site Sketch

ISSUED TO: Mclean Contracting & Invest. PROPERTY LOCATOR: TINGEN RD  
SUBDIVISION MARKETPLACE LOT # 2

Authorized State Agent: ~~\_\_\_\_\_~~ OLIVER TOUSSAINT Date: 12/24/16

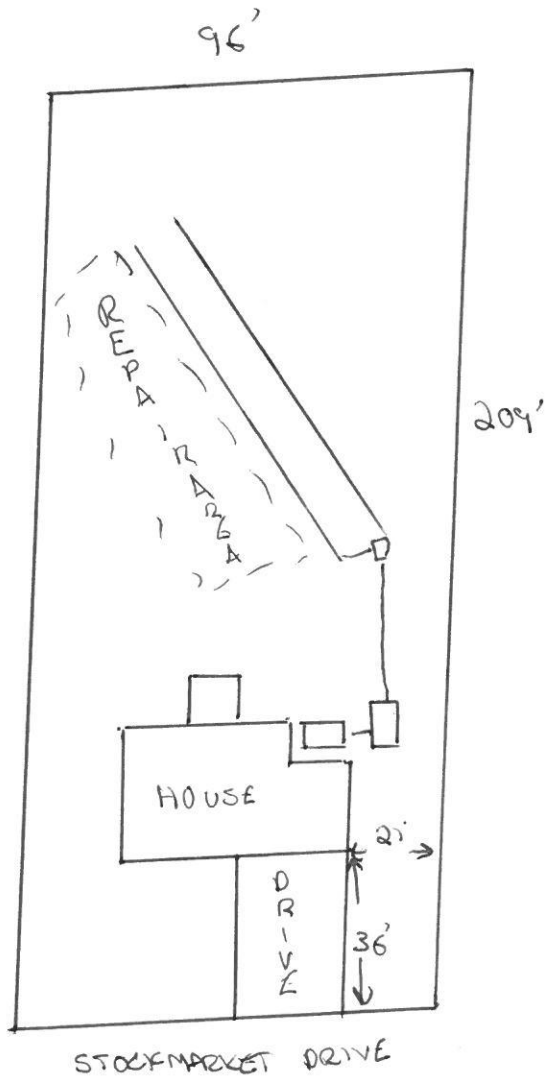

### SOIL/SITE EVALUATION for ON-SITE WASTEWATER SYSTEM

Owner: \_\_\_\_\_ Applicant: \_\_\_\_\_  
 Address: \_\_\_\_\_  
 Proposed Facility: 3 Boxes  
 Location of Site: \_\_\_\_\_  
 Water Supply: \_\_\_\_\_  
 Evaluation Method:  Auger Boring  
 Type of Wastewater:  Sewage

Date Evaluated: 12/12/86  
 Design Flow (.1949): 360 gpd  
 Property Recorded:  
 Public  Individual  Well  
 Pit  Cut  
 Industrial Process

Property Size:  
 Spring  Other  
 Mixed

P R O F I L E #	.1940 Landscape Position/ Slope %	Horizon Depth (In.)	SOIL MORPHOLOGY .1941		OTHER PROFILE FACTORS				Profile Class & LTAR
			.1941 Structure/ Texture	.1941 Consistence Mineralogy	.1942 Soil Wetness/ Color	.1943 Soil Depth (IN.)	.1956 Sapro Class	.1944 Restr Horiz	
1	LS 2-5	0-48	GS	VFIL NS NP					5/8
2		0-48	GS	VFIL NS NP					5/8

Description	Initial System	Repair System	Other Factors (.1946): Site Classification (.1948): Evaluated By: Others Present:
	Available Space (.1945)		
System Type(s)	PUMPS & REDUCTION		
Site LTAR	2		

2x60 @ 24"