

Wynn Construction Lot #10 Avery Pond 3-Bedroom Septic System Design

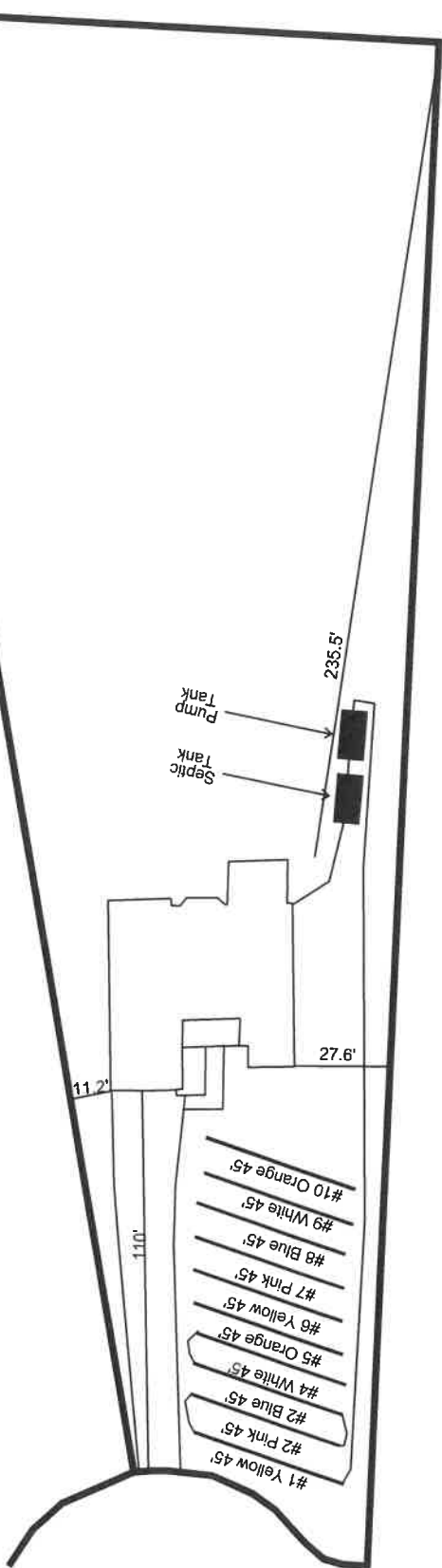

System: Pump to Serial Distribution
Lines: 1-5, (225')
0.4 LTAR
18-22" Trench Bottom
Accepted Status System
Repair: Pump to Serial Distribution
Lines: 6-10, (225')
0.4 LTAR
18-22" Trench Bottom
Accepted Status System

GRAPHIC SCALE
1" = 50'



Adams
Soil Consulting
919-414-6761
Job #445

Wynn Construction

Lot #10 - Avery Pond

3-Bedroom Home (360 gal./day)

<u>LINE #</u>	<u>COLOR</u>	<u>BS</u>	<u>HI</u>	<u>FS</u>	<u>ELEVATION</u>	<u>LINE LENGTH</u>	<u>Design Length</u>
TBM		2.0		100.0		<u>in field</u>	<u>installation</u>
INST. 1			102.0				
1	Yellow			2.7	99.3	45	45
2	Pink			2.9	99.1	45	45
3	Blue			3.1	98.9	45	45
4	White			3.3	98.7	45	45
5	Orange			3.5	98.5	45	45
6	Yellow			3.7	98.3	45	45
7	Pink			3.9	98.1	45	45
8	Blue			4.1	97.9	45	45
9	White			4.3	97.7	45	45
10	Orange			4.5	97.5	45	45
					Total	450	450

	<u>System</u>	<u>Repair</u>
System Type	Lines 1-5	Lines 6-10
	Accepted Status System	Accepted Status System
	EZ-FLOW	EZ-FLOW
Suggested Soil LTAR	0.40	0.40
Total Line Length	225	225
Square Footage	675	675
Proposed Trench Bottom	18-22"	18-22"
Distribution Method	Pumt to Serial Distribution	Pumt to Serial Distribution