

Improvement Permit

A building permit cannot be issued with only an Improvement Permit

ISSUED TO: ROYAL OAKS BLDG. GRP. PROPERTY LOCATION: ATKINS RD
SUBDIVISION: ATKINS VILLAGE LOT # 30
Type of Structure: SFO (45' x 67')
Proposed Wastewater System Type: 25% REDUCTION SYSTEM
Projected Daily Flow: 480 GPD
Number of bedrooms: 4 Number of Occupants: 8 max
Permit valid for: Five years

Authorized State Agent: [Signature] Date: 7/20/16 SEE ATTACHED SITE SKETCH

The issuance of this permit by the Health Department in no way guarantees the issuance of other permits. The permit holder is responsible for checking with appropriate governing bodies in meeting their requirements.

Construction Authorization

(Required for Building Permit)

The construction and installation requirements of Rules .1950, .1952, .1954, .1955, .1956, .1957, .1958, and .1959 are incorporated by references into this permit and shall be met.

ISSUED TO: ROYAL OAKS BLDG. GRP. PROPERTY LOCATION: ATKINS RD
SUBDIVISION: ATKINS VILLAGE LOT # 30
Facility Type: SFO (45' x 67')
Type of Wastewater System: 25% REDUCTION SYSTEM
(Initial) Wastewater Flow: 480 GPD
Installation Requirements/Conditions: PAVEMENT BLOCK (Repair)

Number of trenches: 4
Exact length of each trench: 95 feet
Trench Spacing: 9 Feet on Center
Soil Cover: 12 inches
Maximum Trench Depth: 24 inches
Pump Requirements: ft. TDH vs. GPM
Aggregate Depth: inches below pipe, inches above pipe, inches total

WATER LINES (INCLUDING IRRIGATION) MUST BE 10FT. FROM ANY PART OF SEPTIC SYSTEM OR REPAIR AREA. NO UTILITIES ALLOWED IN INITIAL OR REPAIR DRAIN FIELD AREA.

**If applicable: I understand the system type specified is different from the type specified on the application. I accept the specifications of this permit.

Owner/Legal Representative Signature: _____ Date: _____

This Construction Authorization is subject to revocation if the site plan, plat, or the intended use changes. The Construction Authorization shall not be transferred when there is a change in ownership of the site. This Construction Authorization is subject to compliance with the provisions of the Laws and Rules for Sewage Treatment and Disposal and to the conditions of this permit. SEE ATTACHED SITE SKETCH

Authorized State Agent: [Signature] Date: 7/20/16
Construction Authorization Expiration Date: 7/20/21

HTE 16-5-39187

Atkins Village, Lot 30 ^{Permit 28930}
4-Bedroom Septic System Layout
May 2016

SITE PLAN APPROVAL

DISTRICT RA30 USE SFD

#BEDROOMS 4

12 Jul 16
ZONING ADMINISTRATOR

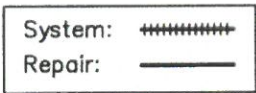

- *Keep Tanks and Drain Lines 10' from property lines.
- *Not a Survey
- *Not a guarantee of a septic permit.
- *Keep supply lines >5' from property lines.
- *Some lines are flagged longer in the field than lengths indicated above.
- *No foundation drains.

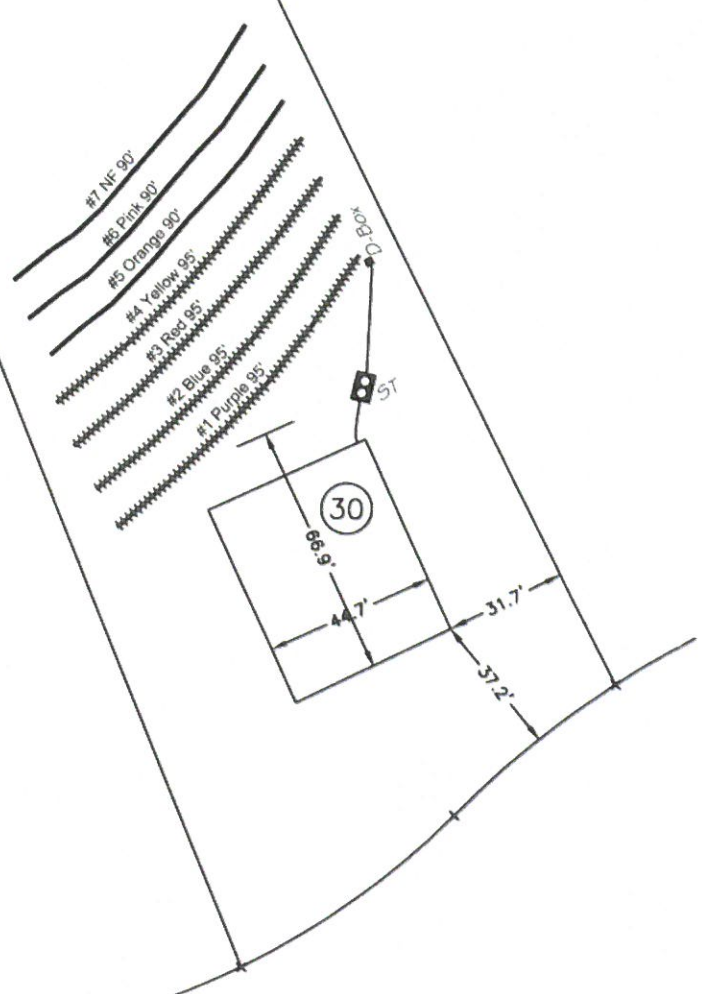

System: Gravity to D-Box
Lines: 1-4, (380')
0.35 Soil LTAR
24" Trench Bottom
Accepted Status System

Repair: T & J panel
Lines: 5-7, (270')
0.35 Soil LTAR
36" Trench Bottom
Accepted Status System

GRAPHIC SCALE

1" = 50'



Central Carolina
Soil Consulting
919-569-6704
Project # 1953