

HTE# 16-539182R

Harnett County Department of Public Health

28922

Improvement Permit

A building permit cannot be issued with only an Improvement Permit

ISSUED TO: ROYAL OAKS BLDG. GR. PROPERTY LOCATION: ATKINS RD
 SUBDIVISION: ATKINS VILLAGE LOT # 22
 NEW REPAIR EXPANSION
 Type of Structure: SFO (45'x67') 44'x66'
 Proposed Wastewater System Type: 25% REDUCTION SYSTEM
 Projected Daily Flow: 480 GPD
 Number of bedrooms: 4 Number of Occupants: 8 max
 Basement Yes No
 Pump Required: Yes No May be required based on final location and elevations of facilities
 Type of Water Supply: Community Public Well Distance from well 100 feet
 Permit valid for: Five years No expiration
 Permit conditions: _____

Authorized State Agent: [Signature] Date: 7/18/16 SEE ATTACHED SITE SKETCH

The issuance of this permit by the Health Department in no way guarantees the issuance of other permits. The permit holder is responsible for checking with appropriate governing bodies in meeting their requirements. This site is subject to revocation if the site plan, plat, or the intended use changes. The Improvement Permit shall not be affected by a change in ownership of the site. This permit is subject to compliance with the provisions of the Laws and Rules for Sewage Treatment and Disposal and to conditions of this permit.

RCM'S REVISED 9/8/11

Construction Authorization

(Required for Building Permit)

The construction and installation requirements of Rules .1950, .1952, .1954, .1955, .1956, .1957, .1958, and .1959 are incorporated by references into this permit and shall be met. Systems shall be installed in accordance with the attached system layout.

ISSUED TO: ROYAL OAKS BLDG. GR. PROPERTY LOCATION: ATKINS RD
 SUBDIVISION: ATKINS VILLAGE LOT # 22
 Facility Type: SFO (45'x67') 44'x66' New Expansion Repair
 Basement? Yes No Basement Fixtures? Yes No
 Type of Wastewater System** 25% REDUCTION SYSTEM (Initial) Wastewater Flow: 480 GPD
 (See note below, if applicable) 25% RED. SYS. (Repair)

Installation Requirements/Conditions

Septic Tank Size 1000 gallons
 Pump Tank Size _____ gallons
 Number of trenches 1
 Exact length of each trench 380 feet
 Trenches shall be installed on contour at a
 Maximum Trench Depth of: 30 inches
 (Trench bottoms shall be level to +/-1/4"
 in all directions)
 Pump Requirements: _____ ft. TDH vs. _____ GPM
 Aggregate Depth: _____ inches below pipe
 _____ inches above pipe
 _____ inches total
 Conditions: PERMIT BASED ON PROPOSAL FROM APPLICANTS LSS

**WATER LINES (INCLUDING IRRIGATION) MUST BE 10FT. FROM ANY PART OF SEPTIC SYSTEM OR REPAIR AREA.
NO UTILITIES ALLOWED IN INITIAL OR REPAIR DRAIN FIELD AREA.**

***If applicable: I understand the system type specified is different from the type specified on the application. I accept the specifications of this permit.*

Owner/Legal Representative Signature: _____ Date: _____

This Construction Authorization is subject to revocation if the site plan, plat, or the intended use changes. The Construction Authorization shall not be transferred when there is a change in ownership of the site. This Construction Authorization is subject to compliance with the provisions of the Laws and Rules for Sewage Treatment and Disposal and to the conditions of this permit. SEE ATTACHED SITE SKETCH

Authorized State Agent: [Signature] Date: 7/18/16
[Signature] 9/2/16 Construction Authorization Expiration Date: 7/18/21

ATKINS VILLAGE, Lot 22
 4-Bedroom Septic System Layout
 MAY 2016

HTE 16-5-39182R
 PERMIT 29922



SITE PLAN APPROVAL
 DISTRICT R30 USE SFD
 #BEDROOMS 4
12 July 2016
 ZONING ADMINISTRATOR

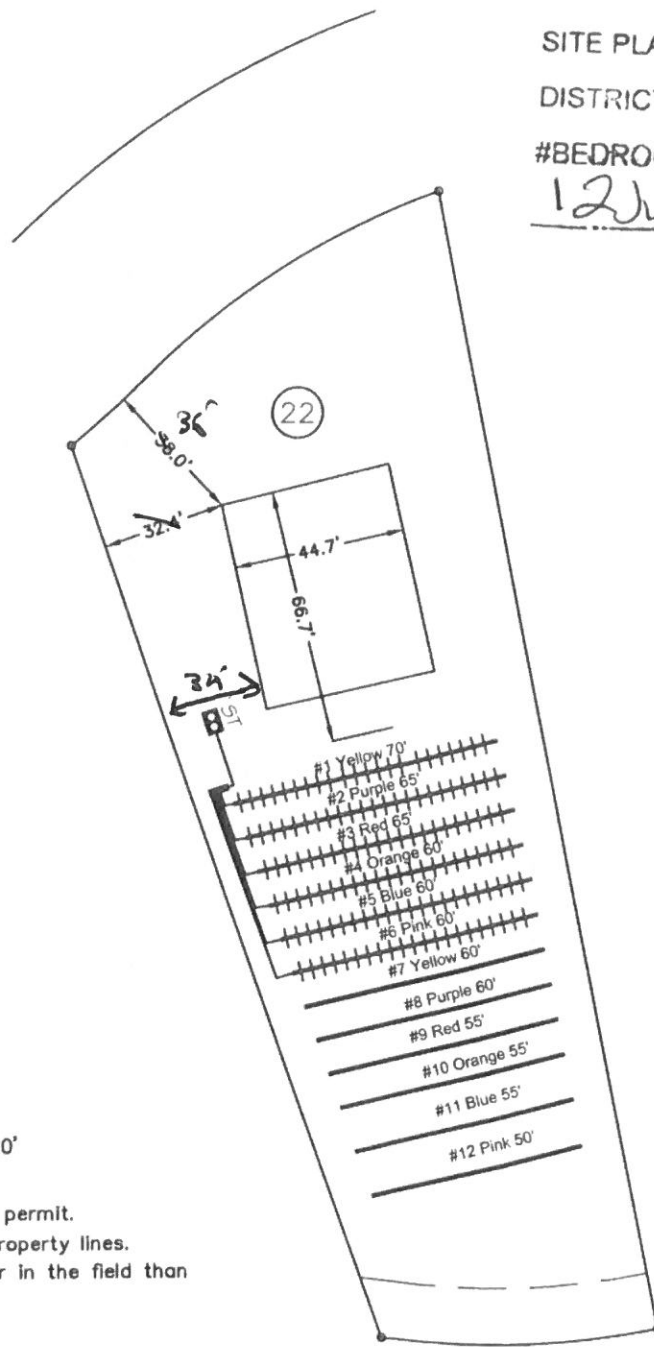

- Keep Tanks and Drain lines 10' from property lines.
- Not a Survey
- Not a guarantee of a septic permit.
- Keep supply lines >5' from property lines.
- Some lines are flagged longer in the field than lengths indicated above.
- No foundation drains.

System: Gravity to Serial Dist.
 Lines: 1-6, (380')
 0.4 Soil LTAR
 30" Trench Bottom
 Accepted Status System

Repair: Gravity to Serial Dist.
 Lines: 7-12 (335')
 0.4 Soil LTAR
 30" Trench Bottom
 Accepted Status System

System: ++++++
 Repair: _____

GRAPHIC SCALE
 1" = 50'



Central Carolina
 Soil Consulting
 919-569-6704
 Project # 1953