

N.C. GRID NORTH

**LEGEND**

----- LINES NOT SURVEYED

----- LINES SURVEYED

EPN-----EXISTING IRON PIPE

ECM-----EXISTING CONCRETE MONUMENT

EES-----EXISTING IRON STAKE

EPK-----EXISTING P.A.MAIL

ELS-----EXISTING LIGHTWOOD STAKE

EPS-----EXISTING BRASS MARK

FRS-----NEW IRON P.A.MAIL SET

ERS-----EXISTING RAILROAD SPIKE

NRS-----NEW RAILROAD SPIKE

ERM-----EXISTING MAGNETIC NAIL

ENR-----EXISTING IRON NAIL

ESR-----EXISTING COTTON SPINDLE

NCS-----NEW COTTON SPINDLE

NSR-----NEW COTTON SPINDLE

EW (R)-----NEW (CONCRETE CORNER)

EW (I)-----NEW (WOOD CORNER)

C/L-----CENTER LINE N/P-----NOW OR FORMALLY

CP-----CALCULATED POINT

CHB-----CHORD BEARING AND DISTANCE

D.B.-----DIBUING BEARING N/P-----RIGHT OF WAY

AC-----EXISTING ACRES

CURVE	RADIUS	LENGTH	CHORD	CH. BEARING
C-1	50.00'	85.65'	75.56'	N 64°26'35"W

MAP REFERENCE: MAP NO. 2016-141-142  
DEED BOOK 3328, PAGE 980

NORTH CAROLINA HARNETT COUNTY  
I, Mickey R. Bennett, PLS do certify that this plat was drawn under my supervision, deed description recorded in Book SEE, Page 980, (etc.) that the boundaries not surveyed are clearly indicated as drawn from information found in Book SEE, Page REF., that the ratio of precision as calculated is 1:10000. Witness my original signature, registration number and seal this 30 TH day of AUGUST .A.D. 2016.



**MINIMUM BUILDING SET BACKS**  
 FRONT YARD ----- 35'  
 REAR YARD ----- 35'  
 SIDE YARD ----- 10'  
 CORNER LOT SIDE YARD ----- 20'  
 MAXIMUM HEIGHT ----- 35'

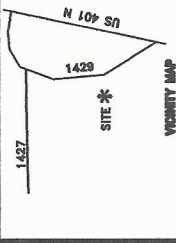

SURVEY FOR:

**FOUNDATION LOCATION SURVEY -- LOT -- 8**  
**"AVERY POND S/D", PHASE ONE**

TOWNSHIP	HECTOR'S CREEK	COUNTY	HARNETT
STATE:	NORTH CAROLINA		
DATE:	AUGUST 30, 2016		
TAX PARCEL ID:	080853 0029 08		
ZONE	WA-30 WATERSHED DISTRICT WS-IV		
RA-30	PIN # 0653-46-8872.000		

**BENNETT SURVEYS** F-1304  
 1662 CLARK RD., LILLINGTON, N.C. 27546  
 (910) 893-5252

10' 0' 20'	SURVEYED BY:	RVB
SCALE: 1" = 40'	DRAWN BY:	RVB
CHECKED & CLOSURE BY:		MRB
FIELD BOOK	FOCUS 35	
DRAWING NO	16395	

