

HTE# 16-5-38973

Harnett County Department of Public Health

24237

PERMIT # 28893

Operation Permit

New Installation Septic Tank Nitrification Line Repair Expansion

PROPERTY LOCATION: 21429 Chalkhatch RD

Name: (owner) Wynn Construction Inc SUBDIVISION Avery Pond LOT # 5

System Installer: Howtons Plumbing Registration # _____

Basement with plumbing: Garage Number of Bedrooms 03

Type of Water Supply: Community Public Well Distance from well _____ feet

System Type: Pump to 25% Red System Type Types V and VI Systems expire in 5 years.

(In accordance with Table V a) Owner must contact Health Department 6 months prior to expiration for permit renewal.

13 BZUG

This system has been installed in compliance with applicable North Carolina General Statutes, Rules for Sewage Treatment and Disposal, and all conditions of the Improvement Permit and Construction Authorization.

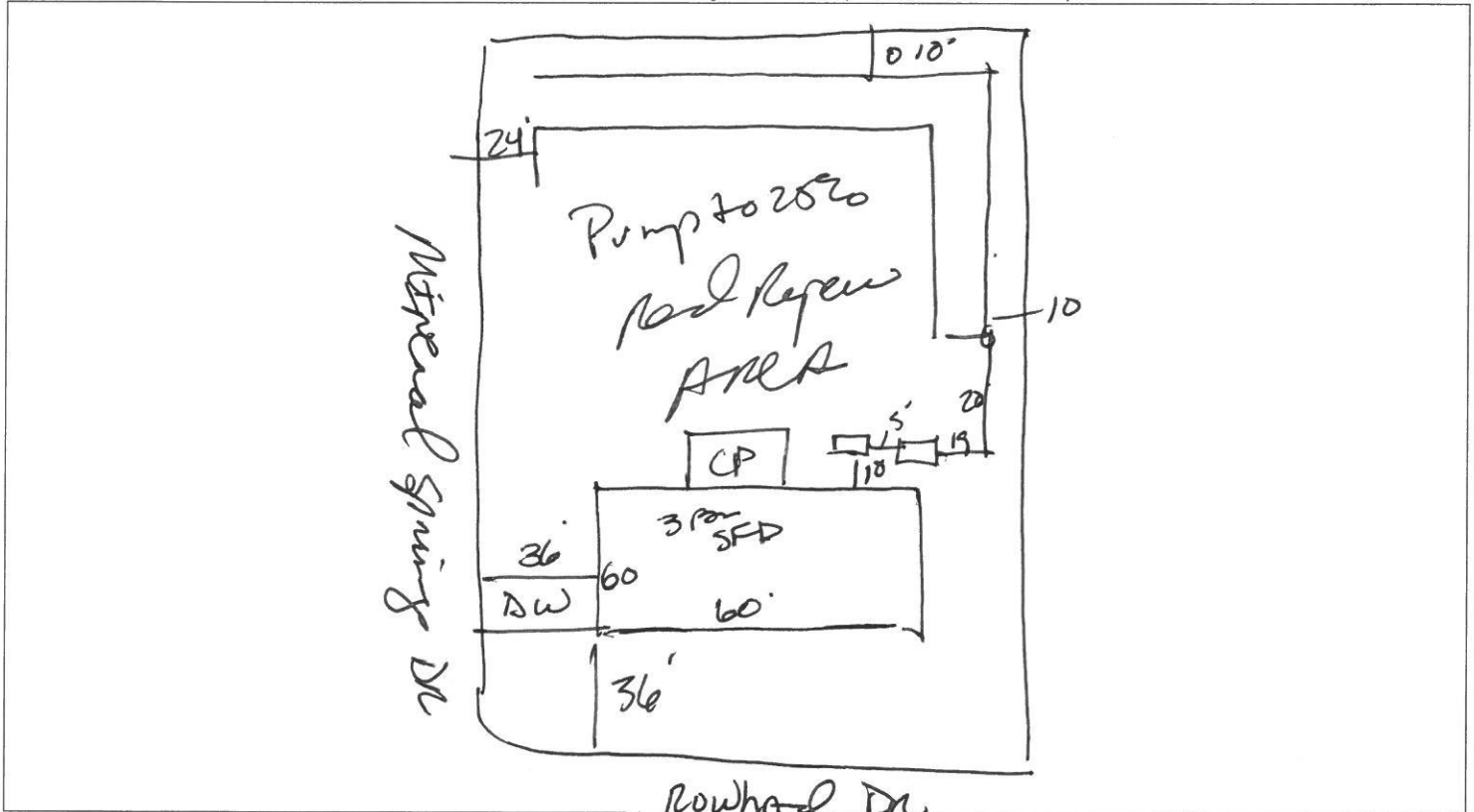

PERMIT CONDITIONS:

- I. Performance: System shall perform in accordance with Rule .1961.
- II. Monitoring: As required by Rule .1961.
- III. Maintenance: As required by Rule .1961. Other: _____
Subsurface system operator required? Yes No
If yes, see attached sheet for additional operation conditions, maintenance and reporting.
- IV. Operation: _____
- V. Other: _____

D-Box Pump Alarm H2O Line PWR Line

Following are the specifications for the sewage disposal system on the above captioned property.

Type of system: Conventional Other 25% REDUCTION Septic Tank: 1000 gallons Pump Tank: 1000 gallons
 Subsurface No. of exact length width of depth of
 Drainage Field ditches 2 of each ditch 150 feet ditches 3 feet ditches 24 inches
 French Drain Required: _____ Linear feet

Authorized State Agent James E. Monahan JR. RBUS Date 11-2-16