

HTE# 16-5-38970

Harnett County Department of Public Health

24223

PERMIT # 28890

Operation Permit

New Installation Septic Tank Nitrification Line Repair Expansion

PROPERTY LOCATION 21425 Chalkbeak RD

Name: (owner) Wynn's Construction

SUBDIVISION Avery Pond

LOT # 2

System Installer: J. Thornton Plumbing

Registration # _____

Basement with plumbing: Garage Number of Bedrooms 3

Type of Water Supply: Community Public Well Distance from well _____ feet

System Type: Pump to 25% red III B EZing Types V and VI Systems expire in 5 years.

(In accordance with Table V a)

Owner must contact Health Department 6 months prior to expiration for permit renewal.

This system has been installed in compliance with applicable North Carolina General Statutes, Rules for Sewage Treatment and Disposal, and all conditions of the Improvement Permit and Construction Authorization.

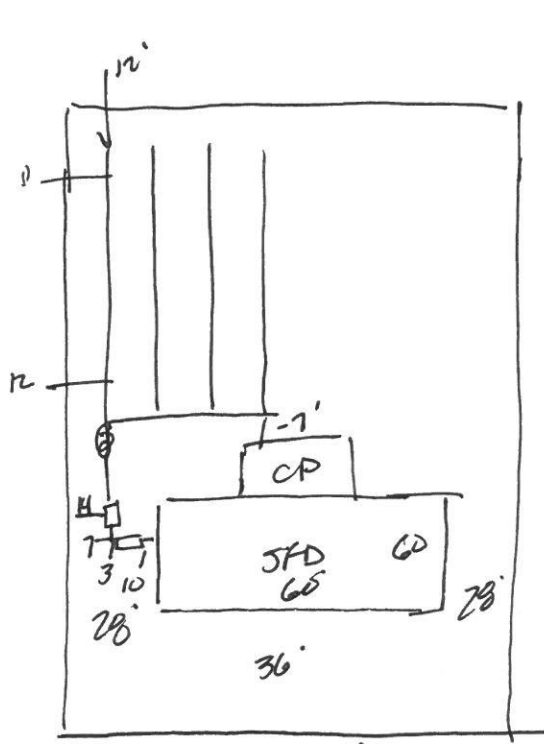

Avery Pond RD

PERMIT CONDITIONS:

- I. Performance: System shall perform in accordance with Rule .1961.
- II. Monitoring: As required by Rule .1961.
- III. Maintenance: As required by Rule .1961. Other: _____
Subsurface system operator required? Yes No
If yes, see attached sheet for additional operation conditions, maintenance and reporting.
- IV. Operation: _____
- V. Other: _____

D-Box Pump Alarm H2O Line PWR Line

Following are the specifications for the sewage disposal system on the above captioned property.

Type of system: Conventional Other pump to 25% red Septic Tank: 1000 gallons Pump Tank: 1000 gallons
 Subsurface Drainage Field No. of 4 exact length 80 feet width of 3 feet depth of 24 inches
 ditches of each ditch 80 feet ditches 3 feet ditches 24 inches
 French Drain Required: _____ Linear feet

Authorized State Agent James E. Markant

Date 11-2-16