

HTE# 16-5-38566R

Harnett County Department of Public Health

28938

Improvement Permit

A building permit cannot be issued with only an Improvement Permit

PROPERTY LOCATION: TRUVELOVE RD

ISSUED TO: TACT Custom Homes Inc SUBDIVISION TAYLOR POINTE LOT # 6

NEW REPAIR EXPANSION

Site Improvements required prior to Construction Authorization Issuance:

Type of Structure: SFD (32x35')

Proposed Wastewater System Type: Pump To 25% Reduction System

Projected Daily Flow: 360 GPD

Number of bedrooms: 3 Number of Occupants: 2 max

Basement Yes No

Pump Required: Yes No May be required based on final location and elevations of facilities

Type of Water Supply: Community Public Well Distance from well 100 feet

Permit valid for: Five years No expiration

Permit conditions:

Authorized State Agent: [Signature] Date: 8/2/16 SEE ATTACHED SITE SKETCH

The issuance of this permit by the Health Department in no way guarantees the issuance of other permits. The permit holder is responsible for checking with appropriate governing bodies in meeting their requirements. This site is subject to revocation if the site plan, plat, or the intended use changes. The Improvement Permit shall not be affected by a change in ownership of the site. This permit is subject to compliance with the provisions of the Laws and Rules for Sewage Treatment and Disposal and to conditions of this permit.

Construction Authorization

(Required for Building Permit)

The construction and installation requirements of Rules .1950, .1952, .1954, .1955, .1956, .1957, .1958, and .1959 are incorporated by references into this permit and shall be met. Systems shall be installed in accordance with the attached system layout.

ISSUED TO: TACT Custom Homes Inc PROPERTY LOCATION: TRUVELOVE RD

SUBDIVISION TAYLOR POINTE LOT # 6

Facility Type: SFD (32x35') New Expansion Repair

Basement? Yes No Basement Fixtures? Yes No

Type of Wastewater System** Pump To 25% Reduction System (Initial) Wastewater Flow: 360 GPD

(See note below, if applicable)

Anaerobic Digester (Repair)

Installation Requirements/Conditions

Septic Tank Size 1000 gallons

Pump Tank Size 1000 gallons

Number of trenches 2

Exact length of each trench 115 feet

Trenches shall be installed on contour at a

Maximum Trench Depth of: 18 inches

(Trench bottoms shall be level to +/-1/4"

in all directions)

Trench Spacing: 9 Feet on Center

Soil Cover: 6 inches

(Maximum soil cover shall not exceed

36" above the trench bottom)

Pump Requirements: _____ ft. TDH vs. _____ GPM

_____ inches below pipe

Aggregate Depth: _____ inches above pipe

Conditions: Permit Based On Proposal From Applicants LSS

_____ inches total

**WATER LINES (INCLUDING IRRIGATION) MUST BE 10FT. FROM ANY PART OF SEPTIC SYSTEM OR REPAIR AREA.
NO UTILITIES ALLOWED IN INITIAL OR REPAIR DRAIN FIELD AREA.**

**If applicable: I understand the system type specified is different from the type specified on the application. I accept the specifications of this permit.

Owner/Legal Representative Signature: _____

Date: _____

This Construction Authorization is subject to revocation if the site plan, plat, or the intended use changes. The Construction Authorization shall not be transferred when there is a change in ownership of the site. This Construction Authorization is subject to compliance with the provisions of the Laws and Rules for Sewage Treatment and Disposal and to the conditions of this permit.

SEE ATTACHED SITE SKETCH

Authorized State Agent: [Signature]

Date: 8/2/16

Construction Authorization Expiration Date: 8/2/21

HTE# 16-5-385662

Permit # 28938

Harnett County Department of Public Health Site Sketch

ISSUED TO: TAB Custom Homes Inc PROPERTY LOCATOR: TRUVELOVE RD
SUBDIVISION TAYLOR POINTE LOT # 6

Authorized State Agent: [Signature] (OLINGTONSDORF) Date: 8/2/16

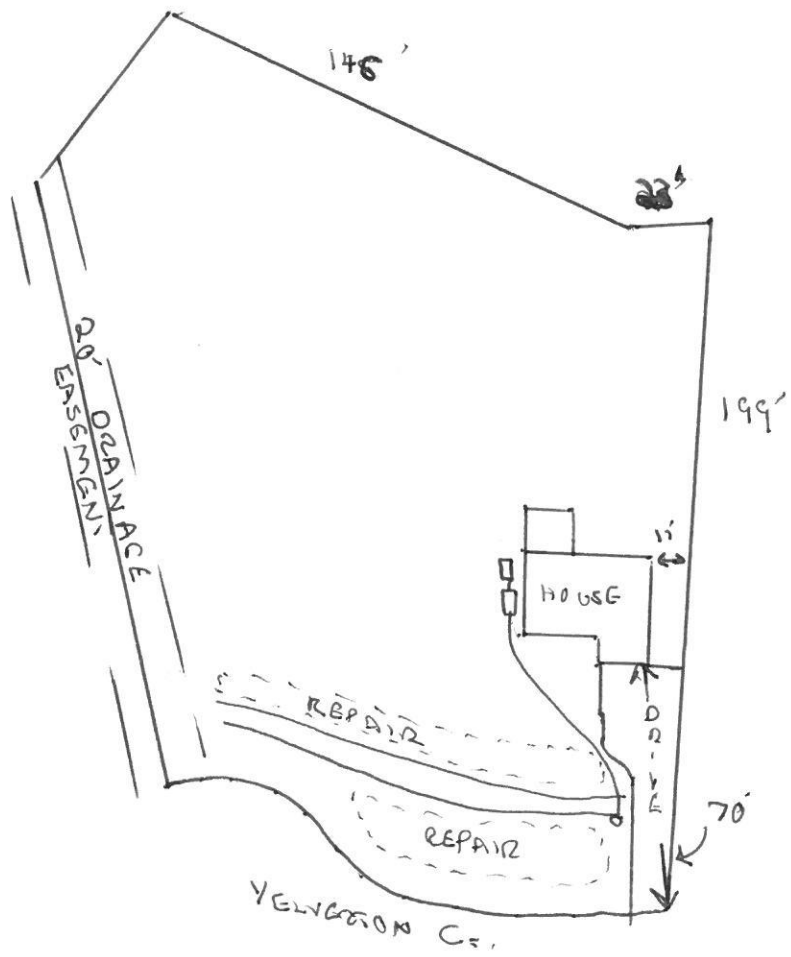

**SOIL/SITE EVALUATION
 for ON-SITE WASTEWATER SYSTEM**

Owner: Applicant:
 Address: Date Evaluated:
 Proposed Facility: 3 BORN Design Flow (.1949): 360 gpd
 Location of Site: Property Recorded: Property Size:
 Water Supply: Public Individual Well Spring Other
 Evaluation Method: Auger Boring Pit Cut
 Type of Wastewater: Sewage Industrial Process Mixed

P R O F I L E #	.1940 Landscape Position/ Slope %	Horizon Depth (In.)	SOIL MORPHOLOGY .1941		OTHER PROFILE FACTORS				Profile Class & LTAR
			.1941 Structure/ Texture	.1941 Consistence Mineralogy	.1942 Soil Wetness/ Color	.1943 Soil Depth (IN.)	.1956 Sapro Class	.1944 Restr Horiz	
		0-16							
		16-24 ^{1/2}			2.5" to 2.02"				
2		0-25							
		25-40	SHL SCH		2.5" to 37"				
3		0-6	FILE						
		0-24	G SL						
		24-42	SHL L		2.02 37"				
		0-30	G L ^s						
		30-36	SHL L						

Description	Initial System	Repair System	Other Factors (.1946): Site Classification (.1948): Evaluated By: <i>[Signature]</i> Others Present: <i>[Signature]</i>
Available Space (.1945)			
System Type(s)			
Site LTAR			

SEE LSS PROPOSAL
 w/ REVISIONS