

HTE# 16-5-38258

Harnett County Department of Public Health

24498

PERMIT # 28814

Operation Permit

New Installation Septic Tank Nitrification Line Repair Expansion

PROPERTY LOCATION: 54865 John Lee RD

Name: (owner) Robert Holland SUBDIVISION _____ LOT # _____

System Installer: Thomas Cooper Registration # _____

Basement with plumbing: Garage Number of Bedrooms 2

Type of Water Supply: Community Public Well Distance from well 100' feet

System Type: 25' m Reducton System Type IUG 6208 Types V and VI Systems expire in 5 years.

(In accordance with Table V a)

Owner must contact Health Department 6 months prior to expiration for permit renewal.

This system has been installed in compliance with applicable North Carolina General Statutes, Rules for Sewage Treatment and Disposal, and all conditions of the Improvement Permit and Construction Authorization.

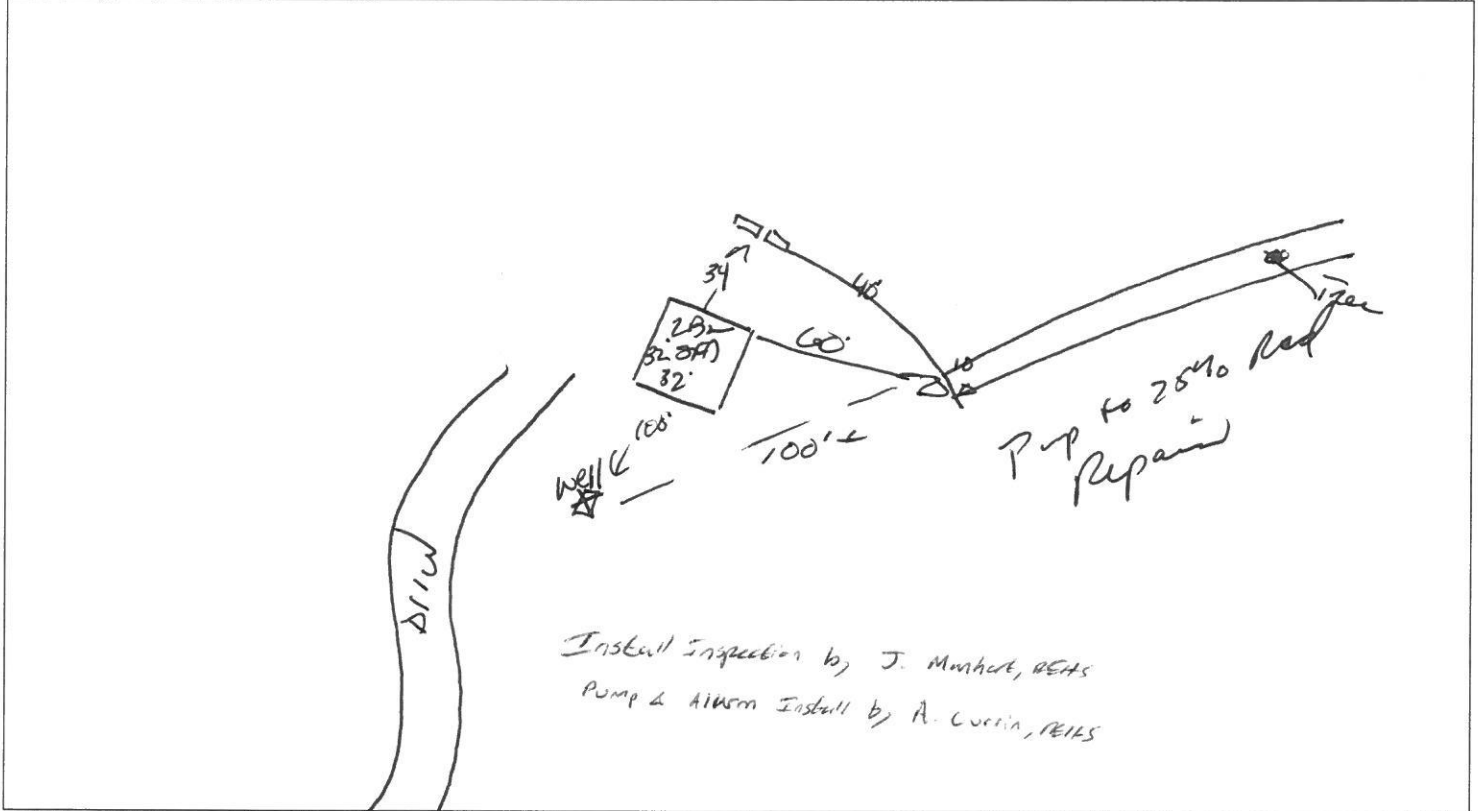

PERMIT CONDITIONS:

- I. Performance: System shall perform in accordance with Rule .1961.
- II. Monitoring: As required by Rule .1961.
- III. Maintenance: As required by Rule .1961. Other: _____
 Subsurface system operator required? Yes No
 If yes, see attached sheet for additional operation conditions, maintenance and reporting.
- IV. Operation: _____
- V. Other: _____

D-Box Pump Alarm H2O Line PWR Line

Following are the specifications for the sewage disposal system on the above captioned property.

Type of system: Conventional Other Pump to 25' m Red Septic Tank: 1000 gallons Pump Tank: 1000 gallons
 Subsurface No. of exact length width of depth of
 Drainage Field ditches 2 of each ditch 120 feet ditches 3 feet ditches 18 inches
 French Drain Required: _____ Linear feet

Authorized State Agent Thomas Cooper, PEAS

Date 10/18/2017



16-5-38258 (1)



16-5-38258 (2)



16-5-38258 (3)



16-5-38258 (4)



16-5-38258 (5)



16-5-38258 (6)



16-5-38258 (7)



16-5-38258 (8)



16-5-38258 (9)



16-5-38258 (10)



16-5-38258 (11)



16-5-38258 (12)



16-5-38258 (13)



16-5-38258 (14)



16-5-38258 (15)



16-5-38258 (16)