

CPSFK-56638016R

# Harnett County Department of Public Health

## Improvement Permit

A building permit cannot be issued with only an Improvement Permit

ISSUED TO: Kenneth Cummings PROPERTY LOCATION: 119 Brae Dr  
 SUBDIVISION Ross McRae Brae LOT # 4  
 NEW  REPAIR  EXPANSION  Site Improvements required prior to Construction Authorization Issuance:  
 Type of Structure: SFD (61'x48')  
 Proposed Wastewater System Type: 25% Reduction System  
 Projected Daily Flow: 480 GPD  
 Number of bedrooms: 4 Number of Occupants: 8 max  
 Basement  Yes  No  
 Pump Required:  Yes  No  May be required based on final location and elevations of facilities  
 Type of Water Supply:  Community  Public  Well Distance from well \_\_\_\_\_ feet Permit valid for:  Five years  
 No expiration  
 Permit conditions: \_\_\_\_\_

Authorized State Agent: \_\_\_\_\_ Date: 2/20/2019 SEE ATTACHED SITE SKETCH  
 The issuance of this permit by the Health Department in no way guarantees the issuance of other permits. The permit holder is responsible for checking with appropriate governing bodies in meeting their requirements. This site is subject to revocation if the site plan, plat, or the intended use changes. The Improvement Permit shall not be affected by a change in ownership of the site. This permit is subject to compliance with the provisions of the Laws and Rules for Sewage Treatment and Disposal and to conditions of this permit.

## Construction Authorization

(Required for Building Permit)

The construction and installation requirements of Rules .1950, .1952, .1954, .1955, .1956, .1957, .1958, and .1959 are incorporated by references into this permit and shall be met. Systems shall be installed in accordance with the attached system layout.

ISSUED TO: Kenneth Cummings PROPERTY LOCATION: 119 Brae Dr  
 SUBDIVISION Ross McRae Brae LOT # 4  
 Facility Type: SFD (61'x48')  New  Expansion  Repair  
 Basement?  Yes  No Basement Fixtures?  Yes  No  
 Type of Wastewater System\*\* 25% Reduction System (Initial) Wastewater Flow: 480 GPD  
 (See note below, if applicable  25% Reduction System (Repair))

Installation Requirements/Conditions  
 Septic Tank Size 1000 gallons Number of trenches 1  
 Pump Tank Size \_\_\_\_\_ gallons Exact length of each trench 270 feet Trench Spacing: 9 Feet on Center  
 Trenches shall be installed on contour at a Soil Cover: 6-10 inches  
 Maximum Trench Depth of: 18-22 inches (Maximum soil cover shall not exceed  
 (Trench bottoms shall be level to +/-1/4" 36" above the trench bottom)  
 in all directions)  
 Pump Requirements: \_\_\_\_\_ ft. TDH vs. \_\_\_\_\_ GPM \_\_\_\_\_ inches below pipe  
 Aggregate Depth: \_\_\_\_\_ inches above pipe  
 Conditions: \_\_\_\_\_ inches total

**WATER LINES (INCLUDING IRRIGATION) MUST BE 10FT. FROM ANY PART OF SEPTIC SYSTEM OR REPAIR AREA.  
 NO UTILITIES ALLOWED IN INITIAL OR REPAIR DRAIN FIELD AREA.**

\*\*If applicable: I understand the system type specified is different from the type specified on the application. I accept the specifications of this permit.

Owner/Legal Representative Signature: \_\_\_\_\_ Date: \_\_\_\_\_

This Construction Authorization is subject to revocation if the site plan, plat, or the intended use changes. The Construction Authorization shall not be transferred when there is a change in ownership of the site. This Construction Authorization is subject to compliance with the provisions of the Laws and Rules for Sewage Treatment and Disposal and to the conditions of this permit. SEE ATTACHED SITE SKETCH

Authorized State Agent: [Signature] Date: 2/20/2019  
 Construction Authorization Expiration Date: 2/20/2024

HTE# 16-S-38016 R

Permit # \_\_\_\_\_

# Harnett County Department of Public Health Site Sketch

ISSUED TO: KENNETH CUMMINGS PROPERTY LOCATON: 119 BRAE DR  
SUBDIVISION ROSS McRAE BRAC LOT # 4

Authorized State Agent: ~~\_\_\_\_\_~~ OLIVER TOLKSDORF Date: 2/20/19

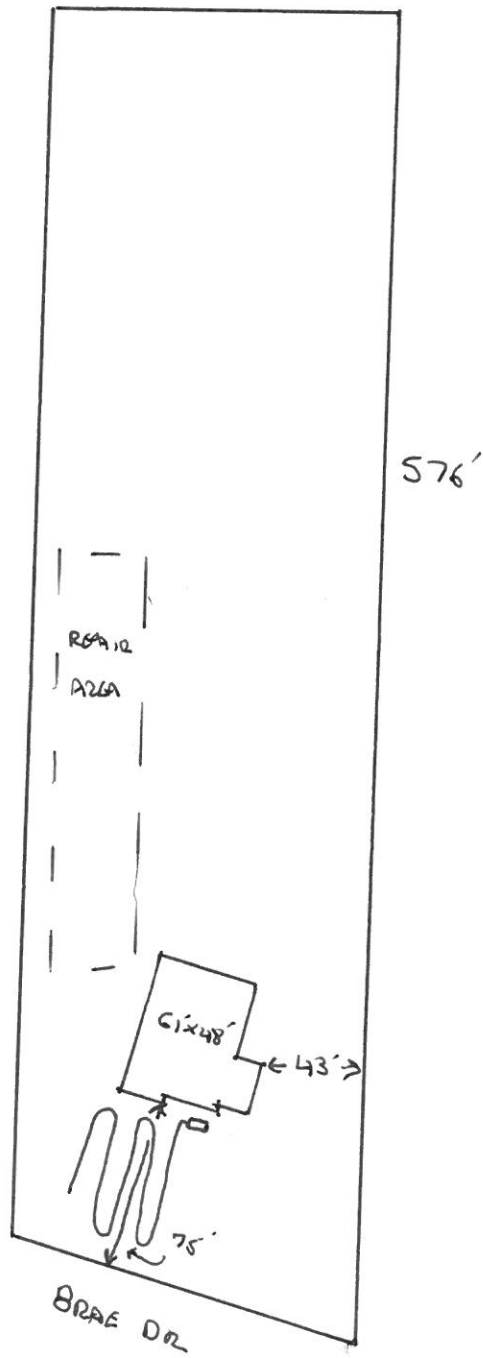

NORTH REFERENCE MAP NO. 2007-72

S 23°40'18"W 101.21' A=48.82'  
R=1530.00

MINIMUM BUILDING SET BACKS  
FRONT ----- 75'  
REAR ----- 75'  
SIDE ----- 30'

3

4

5

S 65°38'41"E 531.52'

407.0'

N 65°38'41"W 576.50'

PROPOSED HOUSE



550' TO CENTER SR 1291

NCSR 1371 (BRAE DR.) 50' R/W  
N 40°12'14"E 148.11'  
A=9.78'  
R=265.00'

① 26-34 58X SCL FR 55/50  
PM

PK 25

②

0-22 G LS W/2 55/50  
22-36 58X SCL FR 55/50

PS 45

DEED REFERENCE  
DEED BOOK 3559, PAGE 845

MAP REFERENCE  
MAP NO. 2007-72

OWNER: KENNETH CUMMINGS LLC

<b>BENNETT SURVEYS</b> F-1304 1662 CLARK RD., LILLINGTON, N.C. 27846 (910) 893-5252		20' 0" 40'	SURVEYED BY:	MRB
		SCALE: 1" = 80'	DRAWN BY:	MRB
			CHECKED & CLOSURE BY:	MRB
				18330

<b>PLOT PLAN - LOT 4</b> <b>ROSS MCRAE BRAE S/D</b>		TOWNSHIP	UPPER LITTLE RIVER	COUNTY	HARNETT
STATE:	NORTH CAROLINA	DATE:	SEPTEMBER 19, 2018		
WATERSHED DISTRICT	N/A	TAX PARCEL ID#	130930 0014 05		
RA-30		PIN #	0630-83-5348.000		

